

YTC430ILAG-01-109N

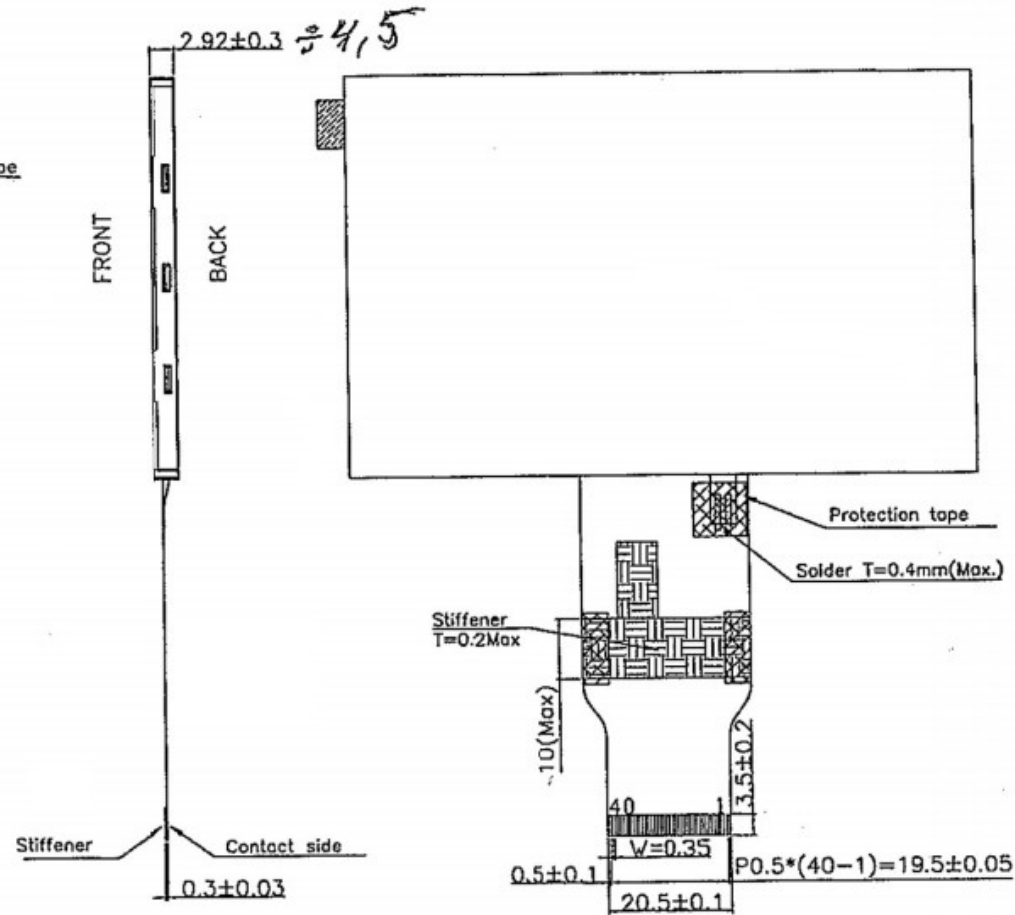
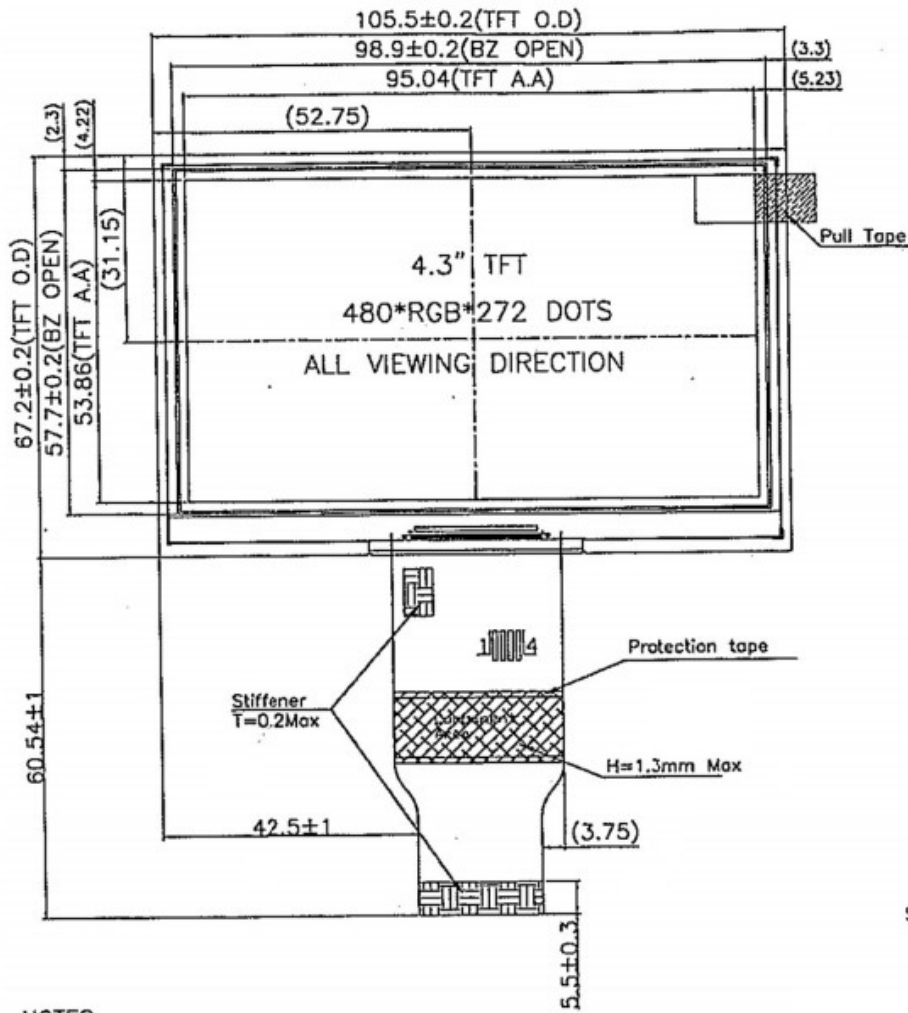

I/O Pins

PIN NO	SYMBOL
1	VLED_A
2	VLED_K
3	VDD
4	VDD
5	RO
6	R1
7	R2
8	R3
9	R4
10	R5
11	R6
12	R7
13	GND
14	G0
15	G1
16	G2
17	G3
18	G4
19	G5
20	G6
21	G7
22	GND
23	B0
24	B1
25	B2
26	B3
27	B4
28	B5
29	B6
30	B7
31	GND
32	PCLK
33	DISP
34	HSYNC
35	VSYNC
36	DE
37	NC
38	NC
39	NC
40	NC

NOTES:

1. DISPLAY TYPE: TFT, TRANSMISSIVE, POSITIVE.
2. OPERATING VOLTAGE: VDD=3.3V.
3. VIEWING DIRECTION: FULL VIEWING ANGLE.
4. IC DRIVER: OTA5180A.
5. OPERATING TEMP.: -30°C ~ 85°C.
6. STORAGE TEMP.: -40°C ~ 85°C.
7. INTERFACE: 24-BIT RGB.
8. LED BACKLIGHT: 12-CHIP WHITE LED, If=40mA, Vf=19.2V.
9. SURFACE LUMINANCE: 800cd/m²(TYP.).
10. TOP POLARIZER SURFACE TREATMENT: ANTI-GLARE.
11. GENERAL TOLERANCE: ±0.2.
12. RoHS COMPLIANT.

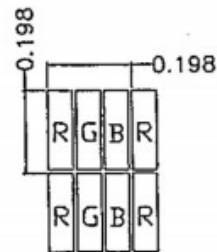

Pixel Detail

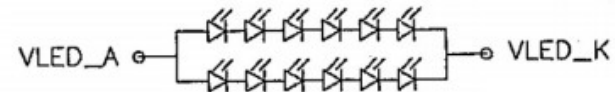

LED CIRCUIT DIAGRAM
17.4V-19.8V@40mA