

## 3W High Power LED

### ■ Application

Reading lights  
Portable flashlight  
Contour lights  
Road lights  
Garden lighting



Notes :

1. It is strongly recommended that the temperature of lead be not higher than 55°C
2. Don't press the surface of silica gel

### ■ Package dimensions

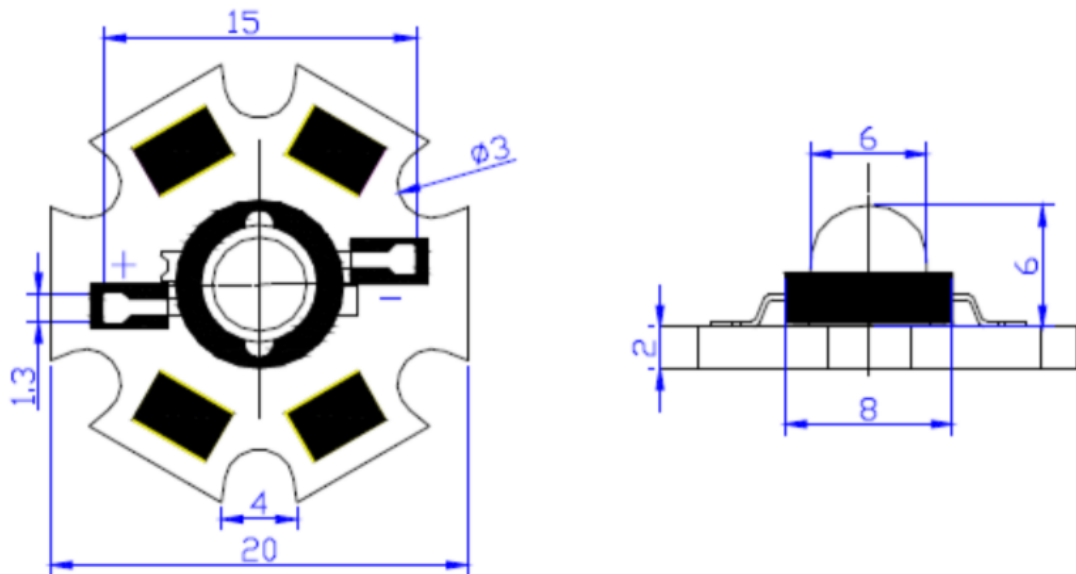

Notes: All dimensions in mm tolerance is  $\pm 0,2$ mm unless otherwise noted.

■ **Absolute Maximum Ratings (Ta=25°C)**

Items	Symbol	Absolute maximum Rating	Unit
		W	
Power Dissipation	P <sub>D</sub>	3000	mW
Forward Current (DC)	I <sub>F</sub>	700	mA
Peak Forward Current*	I <sub>FP</sub>	800	mA
Reverse Voltage	V <sub>R</sub>	5	V
Electrostatic discharge	ESD	±4500	V
LED Junction Temperature	T <sub>j</sub>	125	°C
Operation Temperature	T <sub>opr</sub>	-40~+80	°C
Storage Temperature	T <sub>stg</sub>	-40~+100	°C
Lead Soldering Temperature*	T <sub>SOL</sub>	Max.260°C for 3sec Max.	

\*Pulse width ≤ 0.1msec duty ≤ 1/10

\* Our MCPCB is usual use for installation and connection during application, but the ability of head dissipation is not enough. If lighted, our high power star will need better another type heat dissipation equipment. So we recommend the working time is not over 5-10 seconds without any heat dissipation equipment.

\*Reflow, wave peak and soakstannum soldering etc. is not suitable for this products.

\*Suggest to solder it by professional high power LED soldering machine.

\*Can use in variable temperature searing iron with soldering condition: ≤260 degree less than 3 seconds

■ **Typical Electrical & Optical Characteristics (I<sub>f</sub>=700mA and Ta=25°C)**

Part N	Chromaticity CCT (K)		Forward voltage (v)		Luminous Flux (lm)		Reverse Current (μA) VR=5V	50% Power Angle (degree)
	Min.	Typ.	Min.	Max.	Min.	Typ.	Max.	Typ.
3w 120-140	2700	7000	3.2	4.0	120	140	10	140
3w 140-160					140	160		
3w 160-180					160	180		
3w 180-200					180	200		
3w 200-220					200	220		

Notes:

1. Tolerance of measurement of luminous intensity : ±15%
2. Tolerance of measurement of CCT (Correlated color temperature) : ±200k
3. Tolerance of measurement of forward voltage : ±0.1v

■ Typical Electrical & Optical Characteristics Curves (Ta=25°C Unless Otherwise Noted)

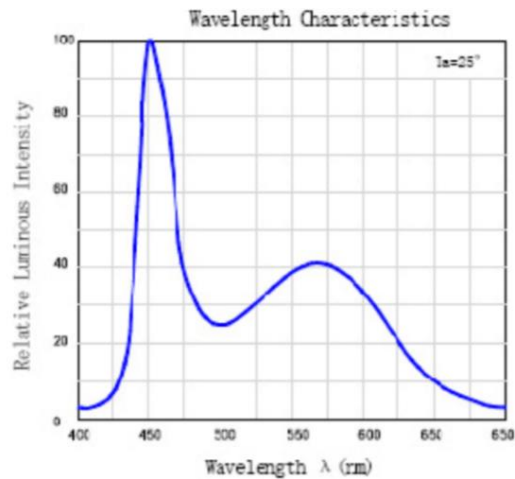
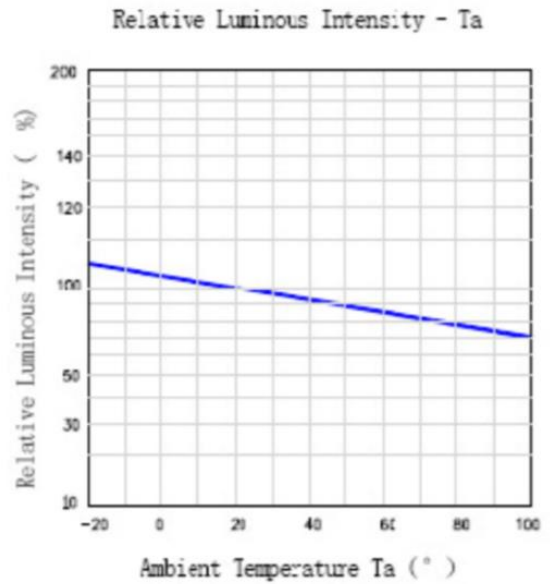
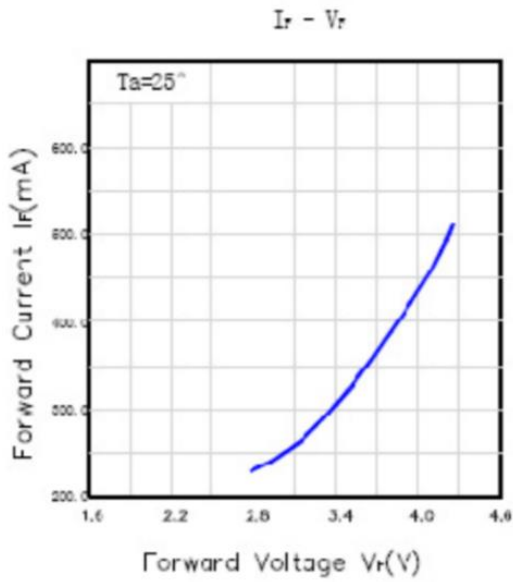
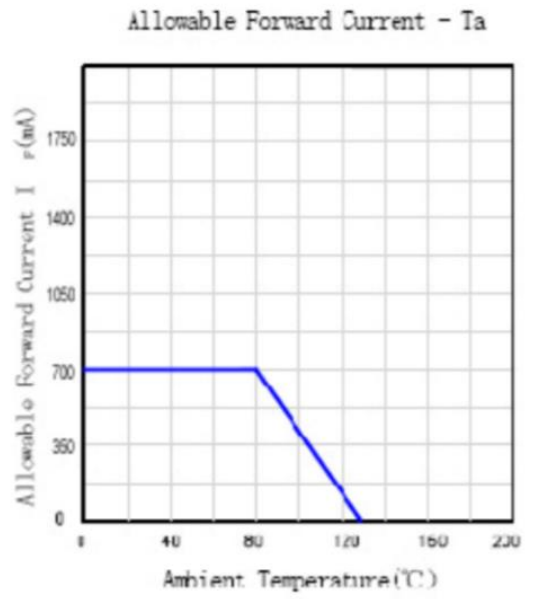
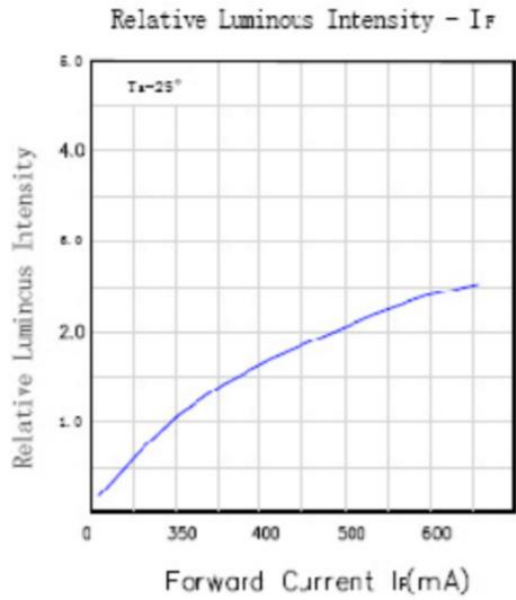

## ■ Radiation Pattern

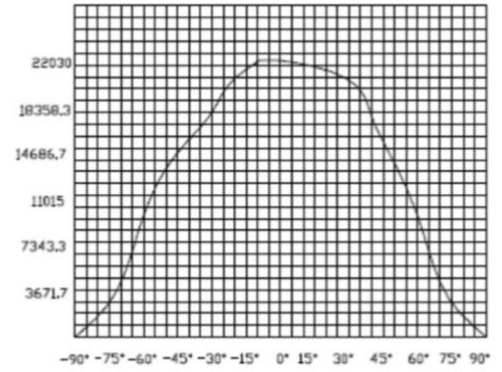
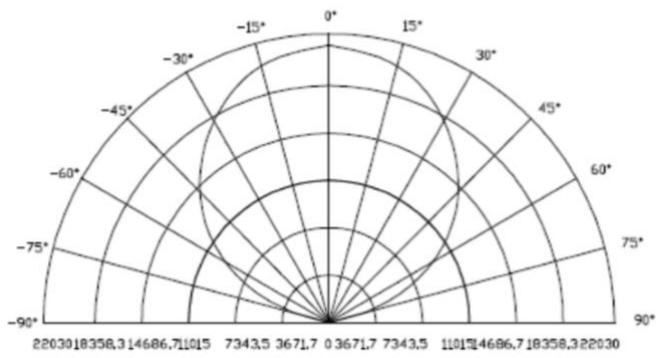

## ■ Box Dimensions

3W High Power LED	3W High Power LED & Aluminum PCB
50 pcs. Per Box	25 pcs. Per Box
Dimensions: 13.9mm * 15.0mm	Dimensions: 13.9mm * 17.8mm
	