



LIGHTING FOREVER

# 4 PIN SOP PHOTOTRANSISTOR AC INPUT PHOTOCOUPLER

## EL3H4-G Series

### Features:

- AC input response
- Current transfer ratio  
(CTR: Min. 20% at  $I_F = \pm 1\text{mA}$ ,  $V_{CE} = 5\text{V}$ )
- High isolation voltage between input and output (Viso=3750 V rms)
- Compact small outline package
- Pb free and RoHS compliant.
- UL approved (No. E214129)
- VDE approved (No. 132249)
- SEMKO approved
- NEMKO approved
- DEMKO approved
- FIMKO approved
- CSA approved (No. 2021495)

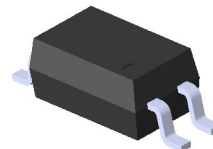

### Schematic

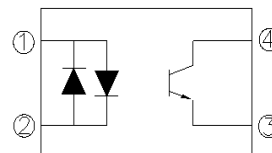

### Pin Configuration

1. Anode / Cathode
2. Cathode / Anode
3. Emitter
4. Collector

### Description

The EL3H4 series contains two infrared emitting diode, connected in inverse parallel, optically coupled to a phototransistor encapsulated with green compound.

It is packaged in a 4-pin small outline SMD package.

### Applications

- AC line monitor
- Programmable controllers
- Telephone line interface
- Unknown polarity DC sensor

CONFIDENTIAL



LIGHTING FOREVER

# 4 PIN SOP PHOTOTRANSISTOR AC INPUT PHOTOCOUPLER

## EL3H4-G Series

### Absolute Maximum Ratings (T<sub>a</sub>=25°C)

Parameter		Symbol	Rating	Unit
Input	Forward current	I <sub>F</sub>	±50	mA
	Peak forward current (t = 10μs)	I <sub>FM</sub>	1	A
	Power dissipation No derating required up to T <sub>a</sub> = 100°C	P <sub>D</sub>	70	mW
Output	Power dissipation Derating factor (above T <sub>a</sub> = 80°C)	P <sub>C</sub>	150	mW
			3.7	mW/
	Collector-Emitter voltage	V <sub>CEO</sub>	80	V
	Emitter-Collector voltage	V <sub>ECO</sub>	6	V
Total power dissipation		P <sub>tot</sub>	200	mW
Isolation voltage *1		V <sub>iso</sub>	3750	V rms
Operating temperature		T <sub>opr</sub>	-55~+100	°C
Storage temperature		T <sub>stg</sub>	-55~+125	°C
Soldering temperature *2		T <sub>sol</sub>	260	°C

#### Notes

\*1 AC for 1 minute, R.H.= 40 ~ 60% R.H. In this test, pins 1 & 2 are shorted together, and pins 3 & 4 are shorted together.

\*2 For 10 seconds.



LIGHTING FOREVER

# 4 PIN SOP PHOTOTRANSISTOR AC INPUT PHOTOCOUPLER

## EL3H4-G Series

### Electrical Characteristics (T<sub>a</sub>=25°C unless specified otherwise)

#### Input

Parameter	Symbol	Min.	Typ.*	Max.	Unit	Condition
Forward voltage	V <sub>F</sub>	-	1.2	1.4	V	I <sub>F</sub> = ± 20mA
Reverse current	I <sub>R</sub>	-	-	10	μA	V <sub>R</sub> = 4V
Input capacitance	C <sub>in</sub>	-	50	250	pF	V = 0, f = 1KHz

#### Output

Parameter	Symbol	Min.	Typ.*	Max.	Unit	Condition
Collector-Emitter dark current	I <sub>CEO</sub>	-	-	100	nA	V <sub>CE</sub> = 20V, I <sub>F</sub> =0mA
Collector-Emitter breakdown voltage	BV <sub>CEO</sub>	80	-	-	V	I <sub>C</sub> =0.1mA
Emitter-Collector breakdown voltage	BV <sub>ECO</sub>	6	-	-	V	I <sub>E</sub> =0.01mA

### Transfer Characteristics (T<sub>a</sub>=25°C unless specified otherwise)

Parameter	Symbol	Min.	Typ.*	Max.	Unit	Condition
Current Transfer ratio	EL3H4	20	-	300	%	I <sub>F</sub> = ±1mA, V <sub>CE</sub> = 5V
	EL3H4A	50		150		
Collector-emitter saturation voltage	V <sub>CE(sat)</sub>	-	0.1	0.2	V	I <sub>F</sub> = ±20mA, I <sub>C</sub> = 1mA
Isolation resistance	R <sub>IO</sub>	5×10 <sup>10</sup>	10 <sup>11</sup>	-	Ω	V <sub>IO</sub> = 500Vdc, 40~60%R.H
Floating capacitance	C <sub>IO</sub>	-	0.6	1.0	pF	V <sub>IO</sub> = 0, f = 1MHz
Rise time	T <sub>r</sub>	-	6	18	μs	V <sub>CE</sub> =2V, I <sub>C</sub> =2mA, R <sub>L</sub> =100Ω
Fall time	T <sub>f</sub>	-	8	18	μs	

\* Typical values at T<sub>a</sub> = 25°C

# 4 PIN SOP PHOTOTRANSISTOR AC INPUT PHOTOCOUPLER

## EL3H4-G Series

### Typical Performance Curves

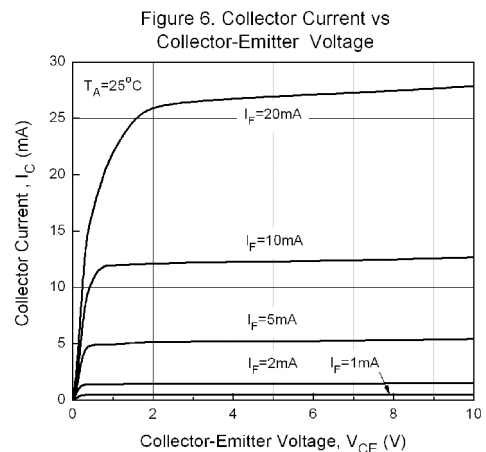
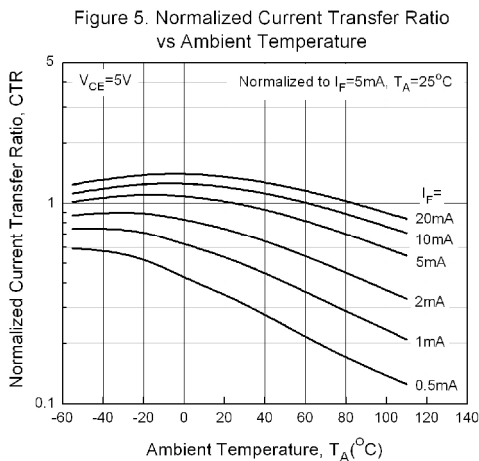
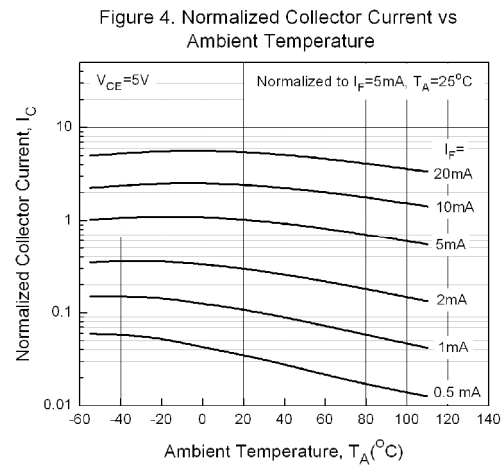
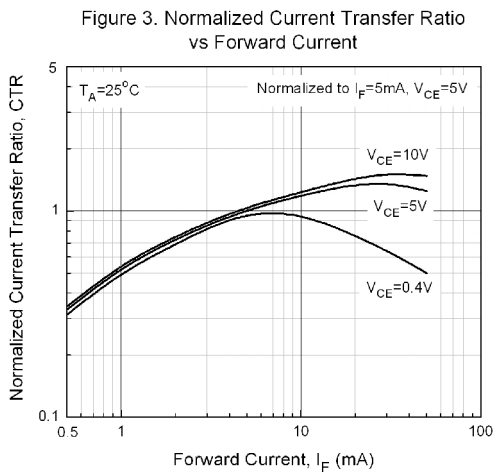
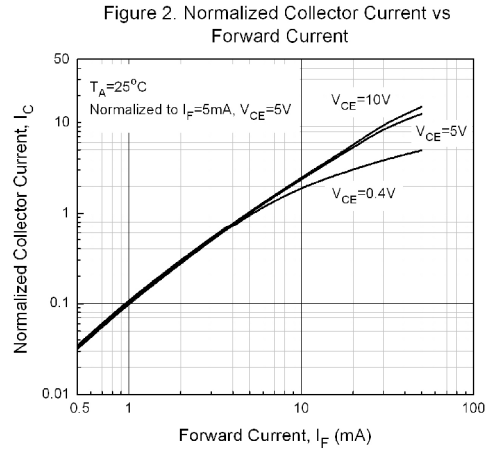
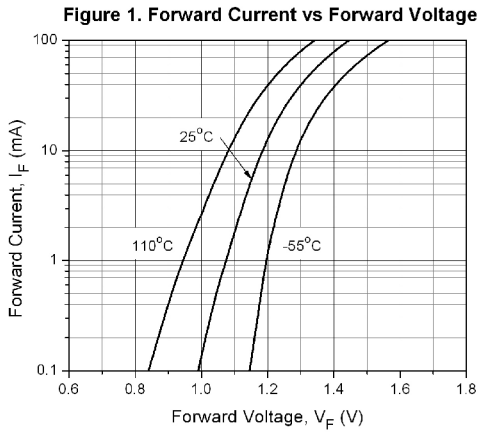

# 4 PIN SOP PHOTOTRANSISTOR AC INPUT PHOTOCOUPLER

## EL3H4-G Series

Figure 7. Collector Current vs Collector-Emitter Voltage

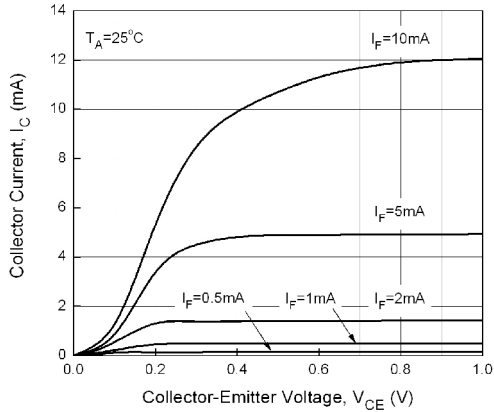

Figure 8. Collector Dark Current vs Ambient Temperature

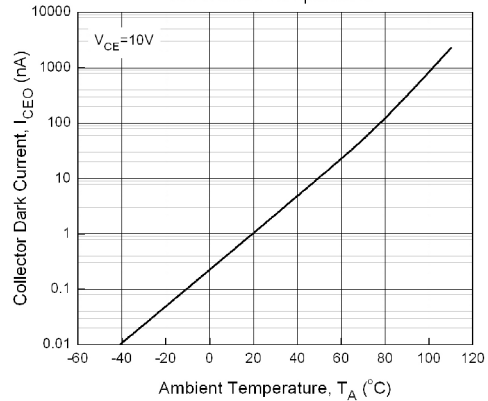

Figure 9. Collector-Emitter Saturation Voltage vs Ambient Temperature

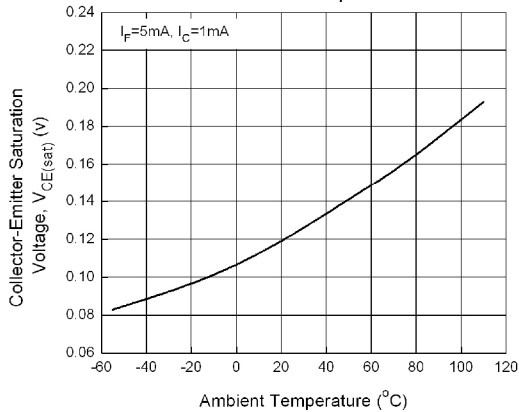

Figure 10. Switching Time vs Load Resistance

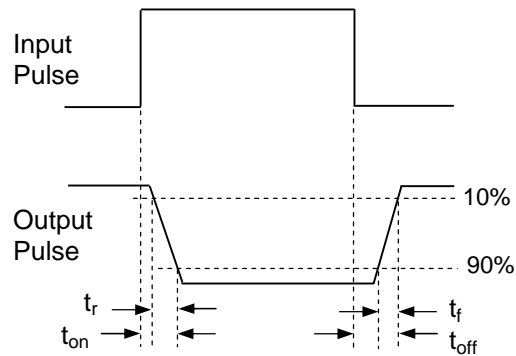
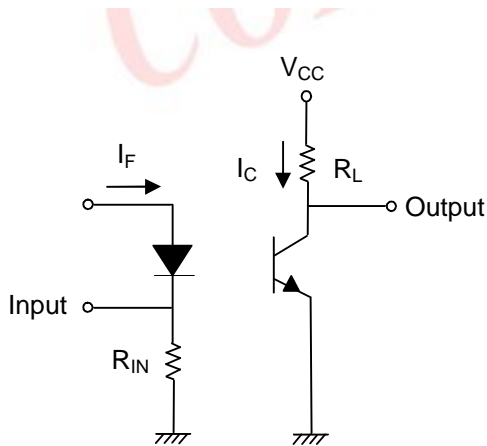
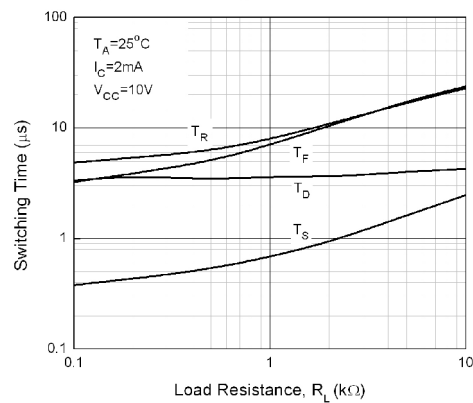

Figure 11. Switching Time Test Circuit & Waveforms



LIGHTING FOREVER

# 4 PIN SOP PHOTOTRANSISTOR AC INPUT PHOTOCOUPLER

## EL3H4-G Series

### Order Information

Part Number

# EL3H4(X)(Y)-VG

### Note

- 3H4 = Part No.
- X = CTR Rank (A or none)
- Y = Tape and reel option (TA, TB, EA, EB or none).
- V = VDE (optional)
- G = Halogens free

Option	Description	Packing quantity
None	Standard SMD option	100 units per tube
-V	Standard SMD option + VDE	100 units per tube
(TA)	TA Tape & reel option	5000 units per reel
(TB)	TB Tape & reel option	5000 units per reel
(TA)-V	TA Tape & reel option + VDE	5000 units per reel
(TB)-V	TB Tape & reel option + VDE	5000 units per reel
(EA)	TA Tape & reel option	1000 units per reel
(EB)	TB Tape & reel option	1000 units per reel
(EA)-V	TA Tape & reel option + VDE	1000 units per reel
(EB)-V	TB Tape & reel option + VDE	1000 units per reel

**4 PIN SOP PHOTOTRANSISTOR  
AC INPUT PHOTOCOUPLER**

**EL3H4-G Series**

**Package Drawings**  
(Dimensions in mm)

**Package Drawing**  
(Dimensions in mm)

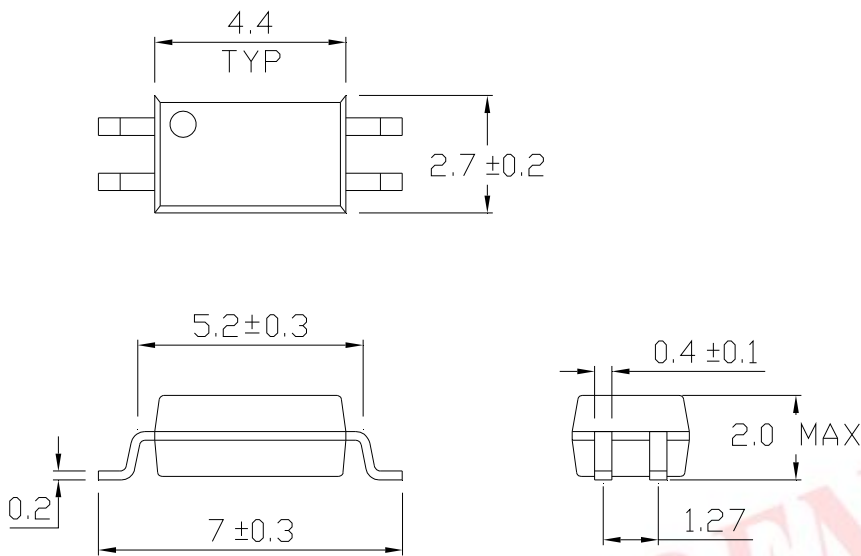

**Recommended pad layout for surface mount leadform**

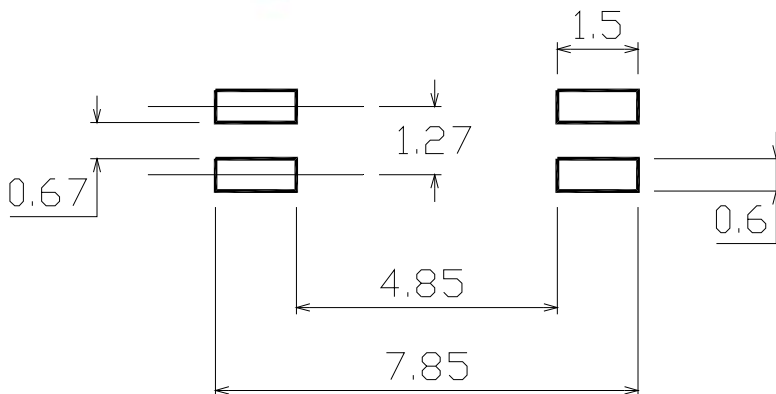



LIGHTING FOREVER

# 4 PIN SOP PHOTOTRANSISTOR AC INPUT PHOTOCOUPLER

## EL3H4-G Series

### Device Marking



### Notes

- EL denotes Everlight
- 3H4 denotes Part Number
- R denotes CTR Rank (A or none)
- Y denotes 1 digit Year code
- WW denotes 2 digit Week code
- V denotes VDE approved (optional)

CONFIDENTIAL



# 4 PIN SOP PHOTOTRANSISTOR AC INPUT PHOTOCOUPLER

**EL3H4-G Series**

## Tape & Reel Packing Specifications

### Option TA

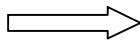
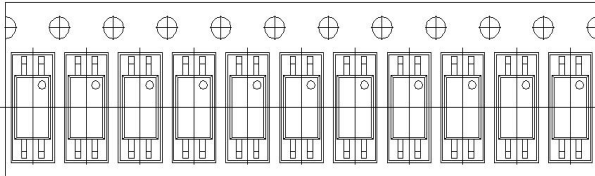

Direction of feed from reel

### Option TB

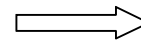
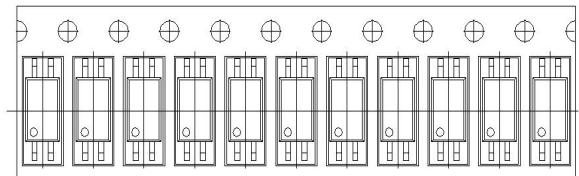

Direction of feed from reel

## Tape dimensions

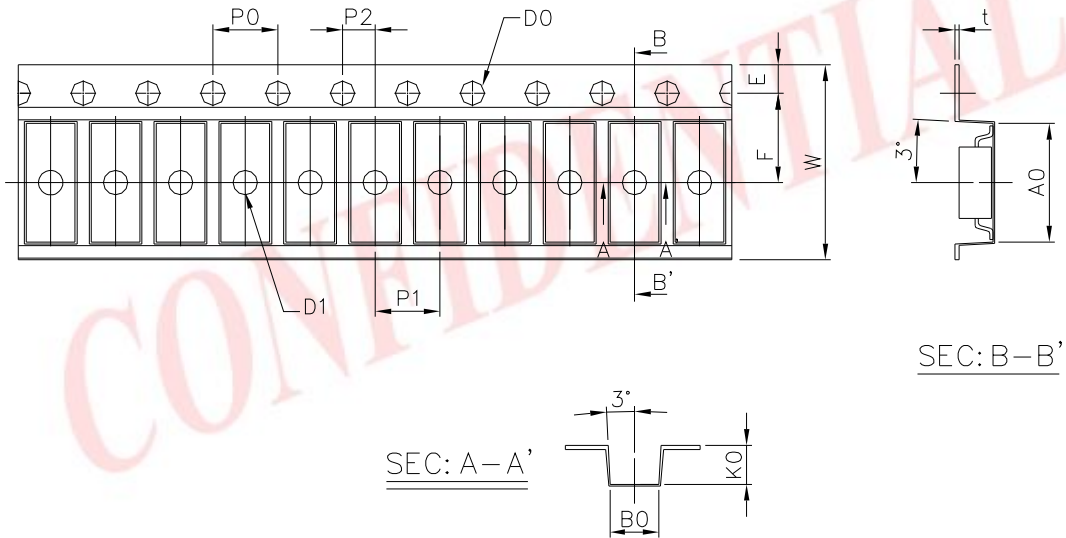

Dimension No.	A	B	Do	D1	E	F
Dimension (mm)	3.0 ± 0.1	7.3 ± 0.1	1.5 + 0.1/-0	1.5 ± 0.1	1.75 ± 0.1	5.5 ± 0.1

Dimension No.	Po	P1	P2	t	W	K
Dimension (mm)	4.0 ± 0.15	4.0 ± 0.1	2.0 ± 0.1	0.25 ± 0.03	12.0 ± 0.2	2.4 ± 0.1



LIGHTING FOREVER

# 4 PIN SOP PHOTOTRANSISTOR AC INPUT PHOTOCOUPLER

## EL3H4-G Series

### Solder Reflow Temperature Profile

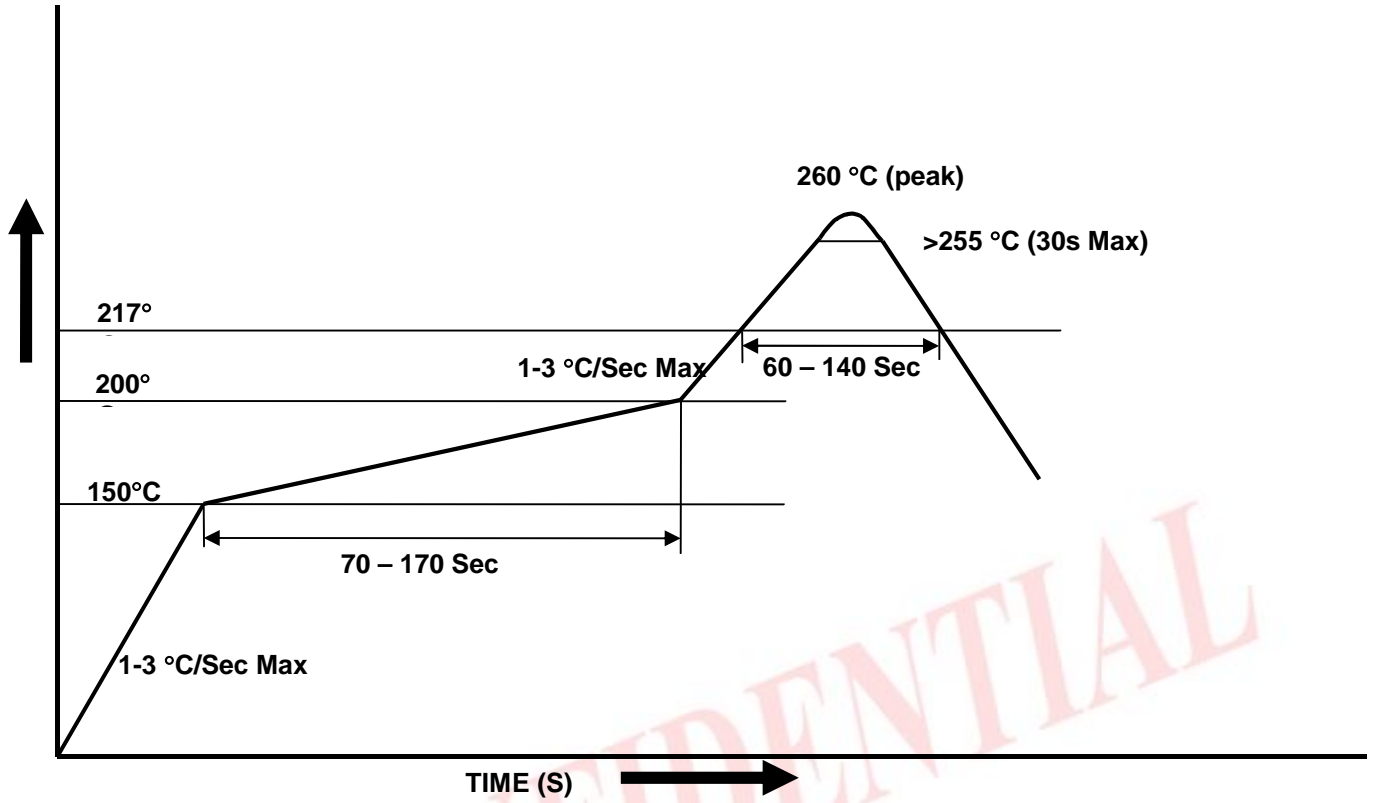

CONFIDENTIAL



LIGHTING FOREVER

## 4 PIN SOP PHOTOTRANSISTOR AC INPUT PHOTOCOUPLER

EL3H4-G Series

### DISCLAIMER

1. The specifications in this datasheet may be changed without notice. EVERLIGHT reserves the authority on material change for above specification.
2. When using this product, please observe the absolute maximum ratings and the instructions for use as outlined in this datasheet. EVERLIGHT assumes no responsibility for any damage resulting from use of the product which does not comply with the absolute maximum ratings and the instructions included in this datasheet.
3. These specification sheets include materials protected under copyright of EVERLIGHT. Reproduction in any form is prohibited without the specific consent of EVERLIGHT.

CONFIDENTIAL