

Data sheet

Commercial Art.No.: 27.000.0253.0

Printed circuit board terminal 8292 H / 2 OB

PCB terminal, 2 poles, with solder pin (3.5mm), pitch: 5.08 mm, type of packing:
carton, color: grey



Commercial Art.No.	27.000.0253.0
EAN	4015573660953
Order Unit	100

Certificates / Approvals



Technical data

General

Modular spacing	5.08 mm
Connection type	screw connection
Soldering process	Wave soldering
Packaging	Carton
Number of poles	2
Conductor to circuit board	180°
Number of levels	1
Integrated test socket	No
Insulation plate	No
Retaining pins	No
Marking	No

Technical data

Nominal cross section	1.5 mm ²
Rated current	15 A
Overvoltage Category I	500 V
Overvoltage Category II	250 V
Overvoltage Category III	250 V
Rated impulse voltage	4 kV
Wire strip length	6 mm

Connection Data

Minimum cross section solid	0.5 mm ²
Maximum cross section solid	1.5 mm ²

Minimum cross section fine stranded	0.5 mm ²
Maximum cross section fine stranded	1.5 mm ²
Wire strip length	6 mm

Technical Data UL/CSA

Cross section UL	24-14 AWG
Voltage UL	300 V
Current field wiring	10 A
Current factory wiring	10 A
Cross section CSA	24-14 AWG
Voltage CSA	300 V
Current CSA	10 A

Other

Type of insulation material	Thermoplastic
Color	Grey
Height	13.5 mm
Length	10.16 mm
Depth	10 mm
Material attachment screw	Steel
Material contact base	CuZn
Material contact surface	Sn

Classification

ECLASS 11	
ECLASS 8.1	27440401
ETIM 7.0	EC002643
ETIM 6.0	EC002643
ETIM 5.0	EC002643
ETIM 4.0	EC002643

Product compliance

ROHS conformity status	Compliant
REACH-SVHC conformity status	Compliant

These dimensions will be especially checked at delivery
 Only inspection dimensions
 With /E marked dimensions are only valid for internal use

Diese Maße werden bei Abnahme besonders geprüft
 Ausschließlich Prüfmaße
 Mit /E gekennzeichnete Maße sind nur für interne Zwecke gültig

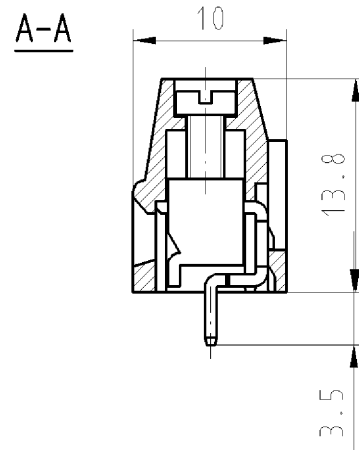
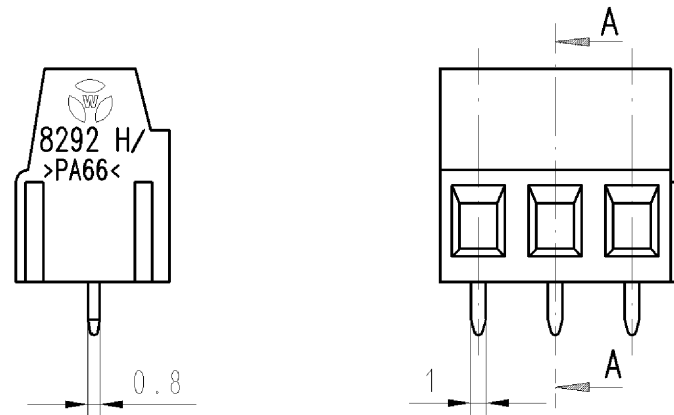

gezeichnet/drawn:
 27.000.0353.0

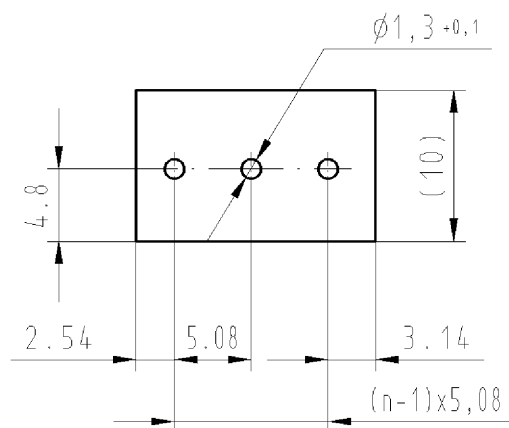

Lochbildtoleranzen nach DIN IEC 326 Teil 3 sehr fein

drill hole tolerances acc. to DIN IEC 326 part 3 very fine

Technische Daten
 Technical Data

	VDE	UL	CSA
Bemessungsspannung V rated voltage	250	300	300
Bemessungsstrom A rated current	15	10	10
Anschlußbereich max. mm ² /AWG connection range	1,5	12	12
Brennbarkeitsklasse UL 94 V-2 flamability rating UL 94 V-2			
Klemmschraube M 2,5 clamping screw			
Verschmutzungsgrad 3/Überspannungskategorie III pollution degree 3/overvoltage category III			
Kontaktbasismaterial contact basis material	CuZn 36		
Diffusionssperre diffusion barrier	Ni 1,5-3µm		
Kontaktoberfläche contact surface	Sn 4-6µm		
Isoliermaterial insulating material	PA66		

Weitere Daten siehe Katalog
 further data see catalog

Teile-Nr. part no.	Typ type	Polzahl n pole n	Farbe colour
27.000.0253.0	8292 H / 2 OB	2	grau/grey
27.000.0253.9	8292 H / 2 OB OR	2	orange/orange
27.000.0353.0	8292 H / 3 OB	3	grau/grey

Tolerierung nach DIN 7167/Tolerance system acc. to DIN 7167. (This DIN-standard describes the envelope principle. According to the envelope principle the deviations of form and parallelism are limited by the size tolerances).

ja/yes Stoffverbots- und Deklarationsliste nach UU-TQM-05/03 ist einzuhalten. Conformity with Wieland document UU-TQM-05/03 (list of prohibited / declarable hazardous substances) to be declared!

Freitoleranz nach General tolerance CAD - Zeichnung, keine manuellen Änderungen CAD - drawing, no manual modifications allowed 1. Verwendung: First Use: Blatt: 1 von 1 Sheet: of 1

2002	Tag/Date	Name	Zeichnung Nr./Drawing No. 27.000.0253.0 01K	Index c
gezeichnet/drawn	30.04.	Bauer F.		
geprüft/checked	-	-		
Normgepr. Stand. check	-	-		

Maße in mm/Dimensions are in mm

c	15.05.2006/	Vol.	mm ³	Oil./Surf.	mm ²	Ersatz für/Replacement for: -
b	11.07.2003/	wieland Elektrische Verbindungen				
a	08.07.2003/					
Index	Datum / Blatt Date / Sheet					
Änderung/Revision	Typ		Benennung/Title			
	8292 H / .. OB ..		LP_KLEMME mit Schraubanschluß Rastermaß 5,08 PCB-Terminal with screw connection, pitch 5.08mm			

Documents, Verwertung und Mitteilung seines Inhalts sind verboten, soweit nicht ausdrücklich gestattet. The reproduction, distribution and utilization of this document as well as the communication of its contents to others without express authorization is prohibited.

270000253001K_4_CADW1044_Schnitt 2006-05-16T07:44:57 1.000