

Data sheet

Commercial Art.No.: 78.920.0453.0

Modular insert FLE BRC 4 40

Modular connector system RJ 45 female contact 30V/1A, Cat 5, ?100 Mbit/s + 4 female contacts 400V/10A / 4 POF



Commercial Art.No.	78.920.0453.0
EAN	4015573821965
Order Unit	5

Certificates / Approvals



Technical data

General

Model	Female insert
Inflammability class of insulation material acc. with UL94	V0
Color	Grey
Mating cycles	50
Pollution degree	3
Modular version	yes
Operating temperature range min.	-20 °C
Operating temperature range max.	80 °C

Connection Data

Connection type	Other
Number of poles	8
Plus switching contacts	0
Number of pole for rated current 2	4
Number of pole for rated current 3	0
Total number of poles (without ground contact)	12
With wire protection	No
Protective contact	No

Technical Data UL/CSA

Min. conductor cross section flexible wire	0.14 mm ²
Max. conductor cross section flexible wire	2.5 mm ²

Conductor cross section flexible AWG wire	26-14 AWG
---	-----------

Model

With housing	No
--------------	----

Contacts

Contact material	Copper alloy
Surface	Gilt

Technical Data DIN EN 61984

Nominal voltage	30 V
Rated voltage 2	400 V
Nominal current	1 A
Rated current 2	10 A
Rated impulse voltage	0.5 kV

Classification

ECLASS 11	
ECLASS 8.1	27440205
ETIM 7.0	EC000438
ETIM 6.0	EC000438
ETIM 5.0	EC000438
ETIM 4.0	EC000438
ETIM 3.0	EC000438

Product compliance

ROHS conformity status	Compliant
REACH-SVHC conformity status	Compliant

These dimensions will be especially checked at delivery
Only inspection dimensions
With /E marked dimensions are only valid for internal use

Diese Maße werden bei Abnahme besonders geprüft
Ausschließlich Prüfmaße
Mit /E gekennzeichnete Maße sind nur für interne Zwecke gültig

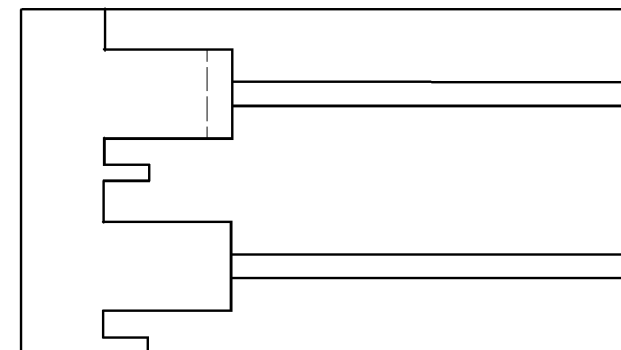
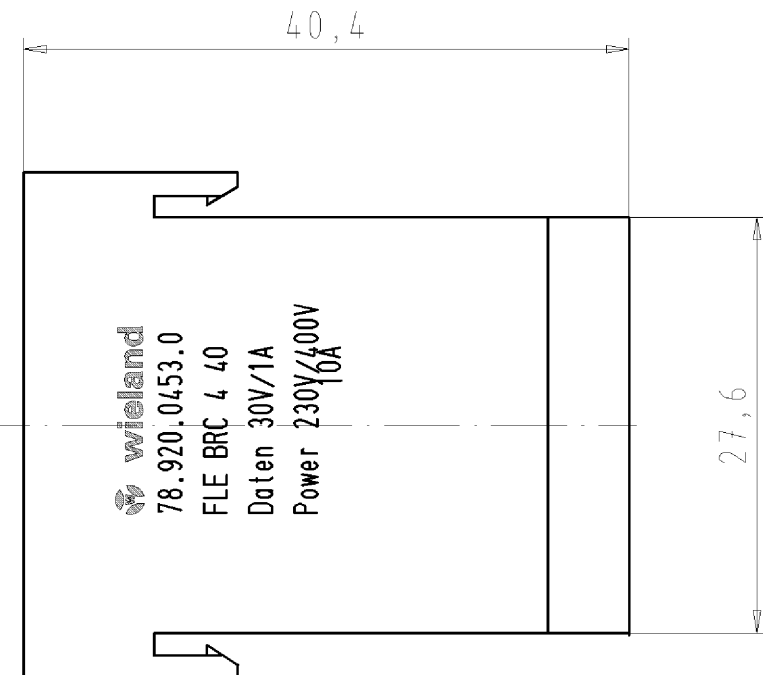
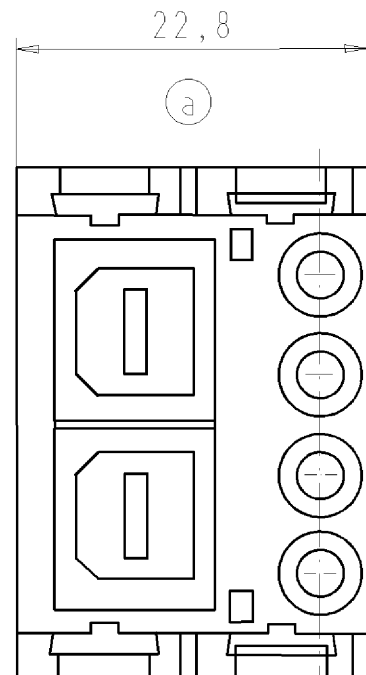

Weitere Daten siehe Katalog
further data see catalog

Bemessungsspannung rated voltage	Daten/data	30 V
	Power	230V/400 V
Bemessungsstrom rated current	Daten/data	1 A
	Power	10 A
Verschmutzungsgrad pollution degree		3
Datenübertragungsrate data transmission rate		≤100 Mbit/s
Übertragungsverhalten transfer behavior		gemäß Category 5 subject to category 5
Kontaktdurchmesser contact diameter		1,6 mm / 02.125.41-4529.8
Isoliergehäuse insulating housing		PA 6.6 glasfaserverstärkt, halogenfrei PA 6.6 fiberglass reinforced, halogen free
Brennbarkeitsklasse flamability rating		UL94 V-0
Farbe colour		grau ähnlich RAL 7032 grey similarly to RAL 7032
Betriebstemperaturbereich operating temperature range		-20°C - +80°C

Für Buchsenkontakte ϕ 1,6 mm (nicht im Lieferumfang enthalten) for socket contacts ϕ 1,6 mm (not included in delivery)	
Querschnitt / cross section	Art.Nr. / part number
0,14 - 0,37 qmm	02.125.4129.8
0,5 qmm	02.125.4229.8
0,75 - 1,0 qmm	02.125.4329.8
1,5 qmm	02.125.4429.8
2,5 qmm	02.125.4529.8

Tolerierung nach DIN 7167/Tolerance system acc. to DIN 7167.
[This DIN-standard describes the envelope principle. According to the envelope principle the deviations of form and parallelism are limited by the size tolerances].

ja/yes Stoffverbots- und Deklarationsliste nach UU-TQM-05/03 ist einzuhalten.
Conformity with Wieland document UU-TQM-05/03 (list of prohibited / declarable hazardous substances) to be declared!

Freitoleranz nach CAD - Zeichnung, keine manuellen Änderungen
General tolerance CAD - drawing, no manual modifications allowed

1. Verwendung: - Blatt: 1 von 1
First Use: - Sheet: 1 of 1

Werkstoff/Material	2007	Tag/Date	Name	Zeichnung Nr./Drawing No.	Index
	gezeichnet/drawn	24.01.	Schmitt J.		
Maßstab/Scale	geprüft/checked	-	-	78.920.0453.0 01K a	
%	Normgepr. Stand. check	-	-		
Vol.	mm ³ Ofl./Surf.	mm ³	Ersatz für/Replacement for: -		
a	22.03.2007/	wieland		Type	Benennung/Title
Index	Datum / Blatt Date / Sheet	Elektrische Verbindungen		MODULE INSERT MODULE INSATZ	
Änderung/Revision				Buchsentteil / female connector revos Flex-Modul RJ45/Power	

Maße in mm/Dimensions are in mm

Weitergabe sowie Vervielfältigung dieses Dokuments, Verwertung und Mitteilung seines Inhalts sind verboten, soweit nicht ausdrücklich gestattet.
The reproduction, distribution and utilization of this document as well as the communication of its contents to others without express authorization is prohibited.

789200453001K_4_CADW1042_Schnitt 2007-03-22T11:04:41 1.000