



• **EMX-5B00L Series**



**FEATURES:**

- Low current consumption
- Compact
- Rich sound

**DIMENSIONS: (Unit: mm)**

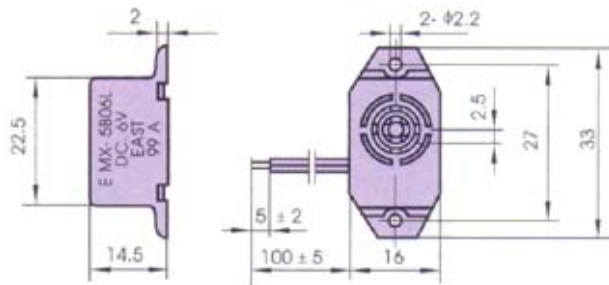

**CHARACTERISTICS:**

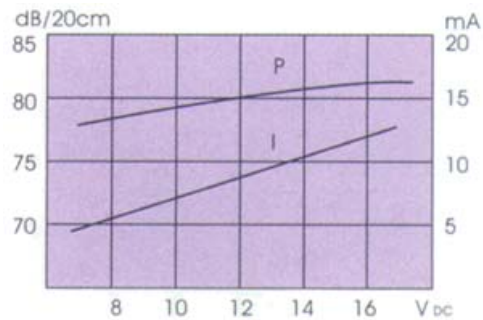

**ELECTRICAL SPECIFICATIONS :**

Model No.	EMX-5B01L	EMX-5B06L	EMX-5B12L	EMX-5B24L	
Min. Sound Pressure Level (dB)	70 / Rated Voltage / 20cm				
Rated Voltage (V)	1.5	6	12	24	
Operating Voltage (V)	1.1 ~ 2	3 ~ 7	7 ~ 17	16 ~ 30	
Max. Consumption (mA)	15/1.5V	20 /6V	20 /12V	20/24V	
Resonant Frequency (Hz)	400 ± 100				
Operating Temperature (°C)	-30 ~ +70		-40 ~ +80		
Weight (g)	10				
Wire Connection (AWG28)	+	1 Red	2 Orange	3 Red	4 Orange
	-	Black	White	White	Black

**PACKING INFORMATION :**

Packing :	2000 pcs per export carton
Carton Size :	47 X 30.5 X 21 cm
G. Weight :	19.5 kgs
N. Weight :	18.0 kgs