

Specifications

1. Current Rating : 0.3A AC/DC
  2. Voltage Rating : 50V AC/DC
  3. Contact Resistance : 40m ohm. max.
  4. Insulation Resistance : 100M ohm. min.at 100V DC
  5. Withstanding Voltage :100V AC for one minute
  6. Operating Temperature Range : -25° C to +85° C
- Material and Plating

- 1.Housing : LCP (Natural Color)UL94V-0
  - 2.Contact : Phosphor Bronze
  - 3.Plating : 3u" Gold Flash
- Number Of Connectors:2500pcs/Reel

How To Order

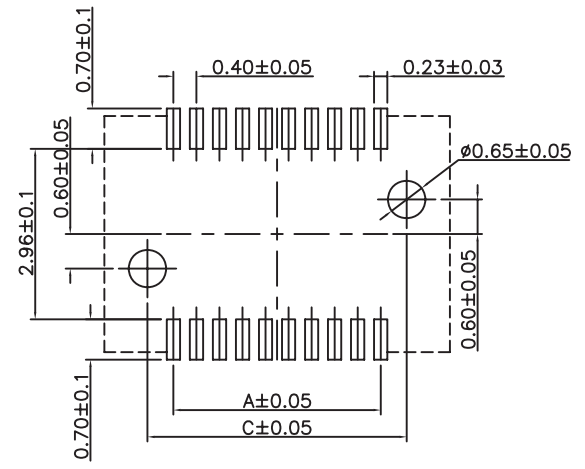
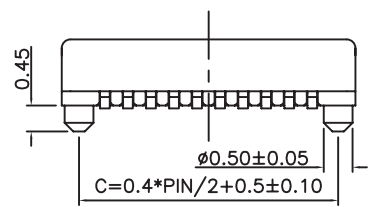

PCB LAYOUT

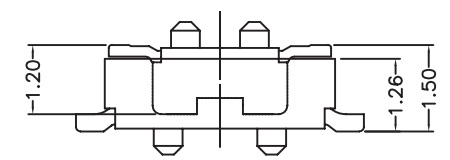

Mating Height Draw (Reference)

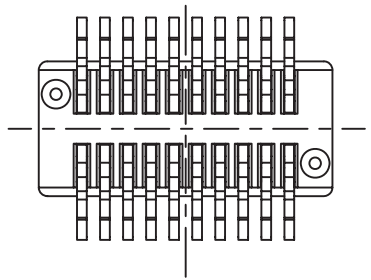

NPF-P02P-xxx-LF  
LEADFREE

RoHS Compliant

Contact Dimension

N(PIN)	DIM.A	DIM.B	DIM.C	N(PIN)	DIM.A	DIM.B	DIM.C
16P	2.80	4.30	3.70	40P	7.60	9.10	8.50
20P	3.60	5.10	4.50	50P	9.60	11.10	10.50
24P	4.40	5.90	5.30	60P	11.60	13.10	12.50
30P	5.60	7.10	6.50	70P	13.60	15.10	14.50
32P	6.00	7.50	6.90	80P	15.60	17.10	16.50
34P	6.40	7.90	7.30				



www.promelec.ru

PART NO. NPF-P02P-xxx		CHECKED BY CY		TOLERANCES ARE .X ± 0.2 .XX ± 0.15 .XXX ± AWG	DESCRIPTION:			
DWG NO. NPF-P02P-xxx		DRAWING BY						
FILE NO.		PROJECTION		AREA	REVISIONS	HK	DATE	
UNIT / mm	SCALE 1:1							