

RECOMMENDED P.C. BOARD HOLE DIMM.

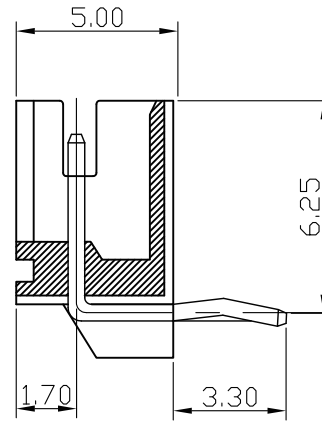

Specifications

Electrical

Voltage Rating: 100V(AC)

Current Rating: 2A

Contact Resistance: 20mΩ max.

Dielectric Withstande Voltage: 800V AC/1min.

Insulation Resistance: 1000MΩ min.

Material

Circuits: 2~16

Insulator: Nylon 66 UL 94V-0

Color: White or Natural

Contact: Brass 0.50mm(0.20") Square Pin

Plating: Tin or Gold Plated

Temperature Range: -40° C~+85° C

Applicable PC Board Thickness: 0.8 to 1.6mm

Poles	Dimension mm (in.)		Part No.	Note.
	A	B		
2	2.0(0.079)	6.04(0.237)	PH 02MR	
3	4.0(0.157)	8.04(0.316)	PH 03MR	
4	6.0(0.236)	10.04(0.395)	PH 04MR	
5	8.0(0.315)	12.04(0.473)	PH 05MR	
6	10.0(0.394)	14.06(0.473)	PH 06MR	
7	12.0(0.472)	16.06(0.631)	PH 07MR	
8	14.0(0.551)	18.08(0.711)	PH 08MR	
9	16.0(0.630)	20.08(0.790)	PH 09MR	
10	18.0(0.709)	22.10(0.870)	PH 10MR	
11	20.0(0.787)	24.10(0.949)	PH 11MR	
12	22.0(0.886)	26.12(1.027)	PH 12MR	
13	24.0(0.945)	28.12(1.106)	PH 13MR	
14	26.0(1.024)	30.14(1.203)	PH 14MR	
15	28.0(1.102)	32.14(1.283)	PH 15MR	
16	30.0(1.181)	34.14(1.363)	PH 16MR	

RoHS Compliant

TOLERANCES ARE

X. ±

.X ±

.XX ±

.XXX ±

ANG ±

