

ATUM (4:1 RATIO)

Dual Wall tube. With a 4:1 shrink ratio. A Halogenated flame retarded heat shrink tube with a meltable adhesive liner delivering a high bond strength to many substrates. To be used for insulation, protection, and environmental sealing of cables.

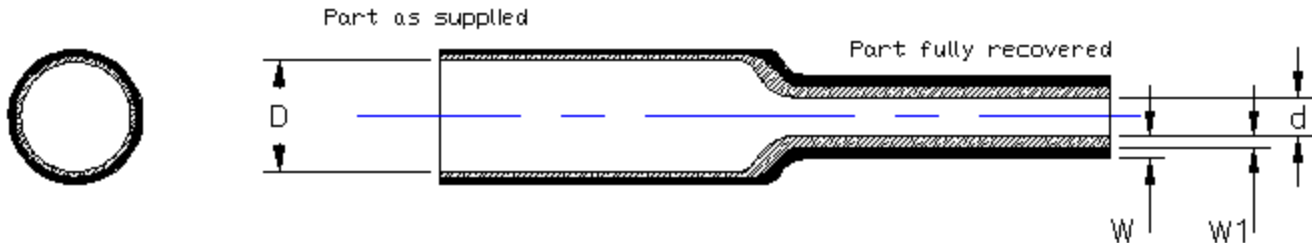

PRODUCT DIMENSIONS

SIZE	Inside Diameter as supplied (min) mm (inch) D	Inside Diameter after recovery (max) mm (inch) d	Total Wall Thickness after recovery (nom) mm (inch) W	Wall Thickness Tolerance after recovery mm (inch)	Inner Meltable Wall Thickness after recovery (nom) mm (inch) W1
4/1	4.0 (.157)	1.0 (.039)	1.0 (.039)	0.30 (.012)	0.50 (.020)
8/2	8.0 (.315)	2.0 (.079)	1.0 (.039)	0.30 (.012)	0.50 (.020)
12/3	12.0 (.472)	3.0 (.118)	1.40 (.055)	0.30 (.012)	0.60 (.024)
16/4	16.0 (.630)	4.0 (.157)	1.78 (.070)	0.38 (.015)	0.75 (.030)
24/6	24.0 (.945)	6.0 (.236)	2.25 (.089)	0.55 (.022)	0.80 (.031)
32/8	32.0 (1.260)	8.0 (.315)	2.54 (.100)	0.55 (.022)	1.00 (.039)
52/13	52.0 (2.047)	13.0 (.512)	2.54 (.100)	0.55 (.022)	1.00 (.039)

ATUM (4:1 RATIO) STANDARD SIZE REFERENCE DIMENSIONAL DRAWING



©2020 TE Connectivity Ltd. family of companies
All Rights Reserved

DIMENSIONS IN
mm (Inch)

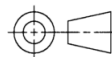

TITLE

ATUM (4:1 RATIO) – IRRADIATED MODIFIED POLYOLEFIN DUAL WALL HEAT SHRINK TUBING

A INITIAL REVISION HD 22/09/2021

REV ENGINEERING CHANGE CHK DATE

SHEET
1 of 2

NO
ATUM (4:1 RATIO) – Standard sizes

REV
A

ATUM (4:1 RATIO)

PRODUCT INFORMATION

Shrink Ratio – 4:1
Longitudinal Shrinkage on full recovery 0 to -15%
Material conforms to TE Specification 108-120009
Standard Colour: Black
Flame Retardant

Tubing cut to specific lengths can be supplied from the product sizes referenced within this drawing.

Cut length tolerances are as per the following table:

STANDARD CUTTING TOLERANCES (mm)	
CUT LENGTH	TOLERANCE
Up to 9.9mm	±0.5mm
10mm to 24.9mm	±1.0mm
25mm to 54.9mm	±1.5mm
55mm to 99.9mm	±3.0mm
100mm to 149.9mm	±4.0mm
150mm to 499.9mm	±5.0mm
500mm to 1200mm	±12.5mm