

## Data sheet

Commercial Art.No.: 80.010.5315.2

Relay module FLARE MOVE 115AC-2W-8A

relay module flare MOVE 115V AC-2W-8A, width 15,8 mm, plugable, nominal operating voltage 115V AC, 2 change-over contact 250V AC / 8A, AgCdO



Commercial Art.No.	80.010.5315.2
EAN	4015573648265
Order Unit	10

Certificates / Approvals



## Technical data

### General

Connection type	screw connection
Number of change-over contacts	2
Detachable clamps	No
Drive, polarization	Polarity free
Drive, function	Mono stable
Forced-guided contacts	No
Complete with socket	yes
Degree of protection (IP)	IP20

### Technical data

Type of excitation	AC
Rated frequency, auxiliary-/control circuit	50 - 60
Min. rated frequency, auxiliary/control current circuit	50 Hz
Max. rated frequency, auxiliary/control current circuit	60 Hz
Min. nominal voltage DC	115 V
Lower nominal voltage DC	92 V
Upper nominal voltage DC	126.5 V

### Dimensions

Depth	76 mm
Width	15.8 mm
Height	78.6 mm

ECLASS 11	
ECLASS 8.1	27371601
ETIM 7.0	EC001437
ETIM 6.0	EC001437
ETIM 5.0	EC001437
ETIM 4.0	EC001437

**Product compliance**

ROHS conformity status	Compliant
REACH-SVHC conformity status	Compliant

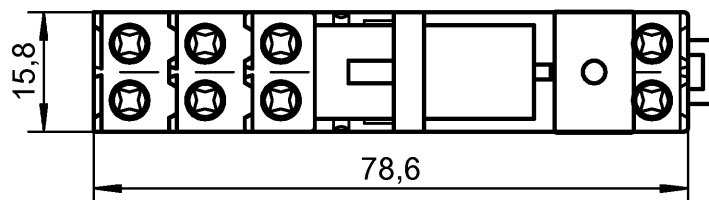
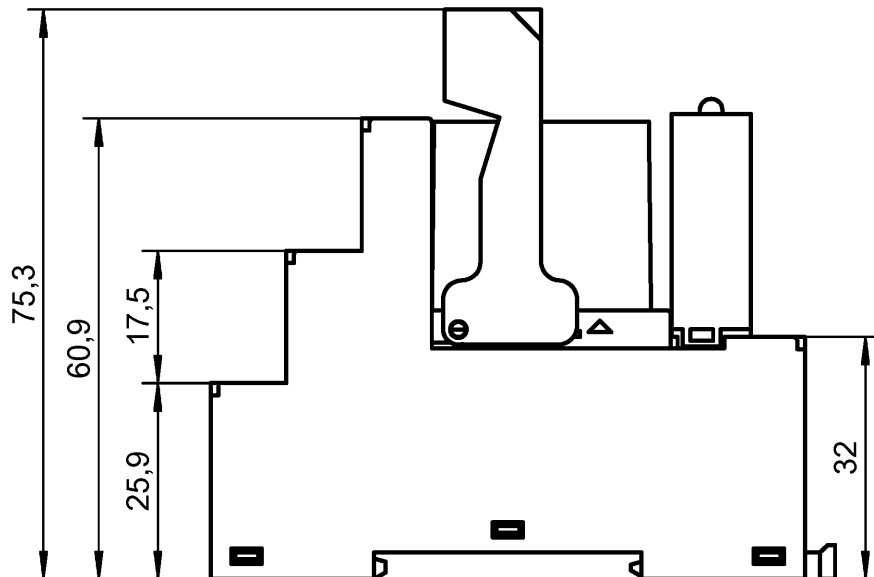

Qu - PEE 12/92

Teile-Nr. / Part No.	Typ / Type
80.010.4901.3	FLARE MOVE 12VDC-1W-16A
80.010.4902.3	FLARE MOVE 24VDC-1W-16A
80.010.4912.3	FLARE MOVE 24VAC-1W-16A
80.010.4915.3	FLARE MOVE 115AC-1W-16A
80.010.4916.3	FLARE MOVE 230AC-1W-16A
80.010.5102.2	FLARE MOVE 24VDC-2W-8A
80.010.5315.2	FLARE MOVE 115AC-2W-8A
80.010.5316.2	FLARE MOVE 230AC-2W-8A
80.010.5501.2	FLARE MOVE 12VDC-2W-10A
80.010.5502.2	FLARE MOVE 24VDC-2W-10A

Weitere Angaben siehe KATALOG oder eKatalog.  
Additional data see CATALOG or eCatalog.

[www.wieland-electric.com](http://www.wieland-electric.com)  
[eshop.wieland-electric.com](http://eshop.wieland-electric.com)

ja/yes  Stoffverbots- und Deklarationsliste nach WN 5020.010 ist einzuhalten.  
Conformity with Wieland document WN 5020.010 e (list of prohibited / declarable hazardous substances) to be declared!

Freitoleranz nach General tolerance		CAD-Zeichnung, keine manuellen Änderungen CAD-Drawing, no manual modifications allowed			1. Verwendung: First Use:		Blatt: Sheet:		
 Maßstab/Scale		Werkstoff/ Material		2019	Tag/ Date	Name		Zeichnung Nr./ Drawing No.	
				gezeichnet drawn	18.02.	Koetzner		<b>T 80.010.4901.3 01K</b> Maße in mm/Dimensions are in mm	
Datei/ File: 018361__01K.DCD		Ersatz für/ Replacement for:							
 www.wieland-electric.com		Type		Benennung/ Title		Teilespezifikation / Component specification			
						Relaisbaustein			
Index	Datum/ Blatt Date/ Sheet	Änderung/ Revision							