

Data sheet

Commercial Art.No.: 25.374.2653.0

PCB pin header 8313 S / 6 WF OB

PCB pin header with pin header, connection method depends on used socket part , 6 poles, pitch: 7.5 mm, type of packing: carton, color: grey



| | |
|--------------------|---------------|
| Commercial Art.No. | 25.374.2653.0 |
| EAN | 4015573319820 |
| Order Unit | 50 |

Certificates / Approvals



Technical data

General

| | |
|--|----------------|
| Modular spacing | 7.5 mm |
| Soldering process | Wave soldering |
| Packaging | Carton |
| Number of poles | 6 |
| Number of levels | 1 |
| Marking | No |
| Fastening | Flange |
| Mating direction towards (circuit) board | 180° |

Technical data

| | |
|--------------------------|--------|
| Rated current | 12 A |
| Overvoltage Category I | 1000 V |
| Overvoltage Category II | 690 V |
| Overvoltage Category III | 400 V |
| Rated impulse voltage | 6 kV |

Technical Data UL/CSA

| | |
|------------------------|-------|
| Voltage UL | 300 V |
| Current field wiring | 15 A |
| Current factory wiring | 15 A |
| Voltage CSA | 300 V |
| Current CSA | 15 A |

Other

| | |
|-----------------------------|---------------|
| Type of insulation material | Thermoplastic |
| Color | Grey |
| Height | 8.4 mm |
| Length | 55.54 mm |

| | |
|--------------------------|-------|
| Depth | 12 mm |
| Material contact base | CuZn |
| Material contact surface | Sn |

Classification

| | |
|------------|----------|
| ECLASS 11 | |
| ECLASS 8.1 | 27440402 |
| ETIM 7.0 | EC002637 |
| ETIM 6.0 | EC002637 |
| ETIM 5.0 | EC002637 |
| ETIM 4.0 | EC002637 |

Product compliance

| | |
|------------------------------|--------------------|
| ROHS conformity status | Compliant/Exempted |
| ROHS exceptions | III-6(c) |
| REACH-SVHC conformity status | Duty-To-Declare |
| REACH-SVHC substances | Lead |
| REACH-SVHC CAS numbers | 7439-92-1 |

Fits with

| Commercial Art.No.: | Article-type description: | Description: |
|---------------------|-------------------------------|---|
| 25.324.2653.0 | PCB connector 8313 B / 6 F OB | PCB female connector with screw connection with rising cage clamp system, 6 poles, max. cross section: 2.5 mm ² , pitch: 7.5 mm, type of packing: carton, color: grey |
| 25.324.0653.0 | PCB connector 8313 B / 6 F | PCB female connector with screw connection with rising cage clamp system, 6 poles, printed version, max. cross section: 2.5 mm ² , pitch: 7.5 mm, type of packing: carton, color: grey |

Weitergabe sowie Vervielfältigung dieses Dokuments, Verwertung und Mitteilung seines Inhalts sind verboten, soweit nicht ausdrücklich gestattet. Die Reproduktion, Distribution und Utilization of this document as well as the communication of its contents to others without express authorization is prohibited.

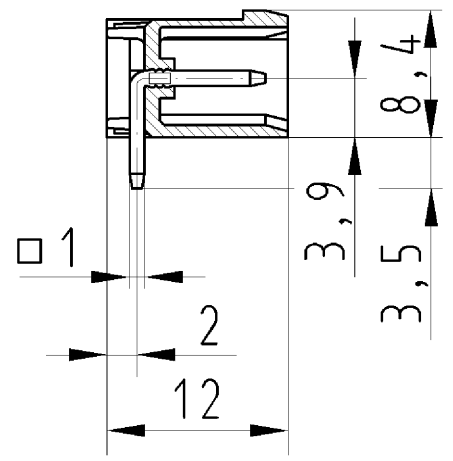
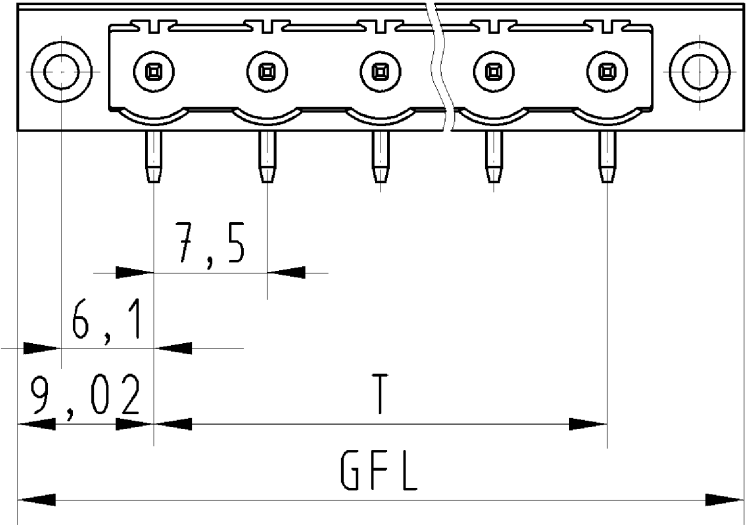

für folgende Tabellen-Zchnng.:
25.374.2253.0 8313 S/..WF

LP.STIFTLEISTE
25.374.2253.0 10W
09.11.2007 SCJ
M 2:1