

DETAILS

Product Number	FP11055_LISA2-RS-PIN
Family	Lisa
Type	Assembly
Color	black
Diameter	9,9 mm
Height	6,8 mm
Style	round
Optic Material	PMMA
Holder Material	
Fastening	glue, pin
Status	production ready
ROHS Compliant	Yes
Date Updated	16/05/2016



OPTICAL PROPERTIES

LED	Viewing	Light	Effi-		Connector
	Angle	Beam	ciency	cd/lm	
XP-E	16 deg	Real spot	90 %	6.500	-
XP-G	24 deg	Real spot	90 %	-	-
XQ-E	sim: 14,5	Real spot	sim: 91 %	sim: 10.100-	
XQ-E HI	sim: 11	Real spot	sim: 86 %	sim: 14.000-	
LUXEON Z ES	15 deg	Real spot	84 %	6.600	-
LUXEON C	16 deg	Real spot	87 %	6.800	-
Oslon Square EC	sim: 18	Real spot	sim: 90 %	sim: 5.600	-
Oslon SSL 80	sim: 14	Real spot	sim: 92 %	sim: 11.300-	
Double Dome (GM2BB)	18 deg	Real spot	90 %	-	-

D

C

B

A

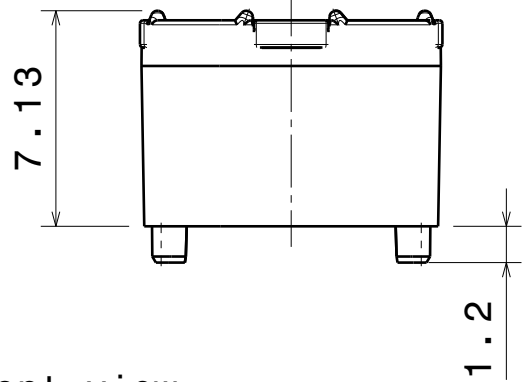

Front view

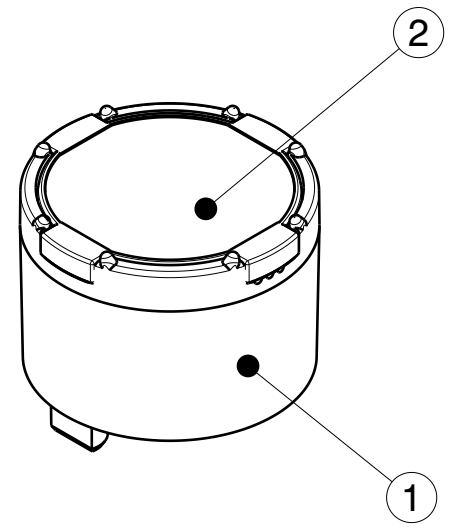

Isometric view

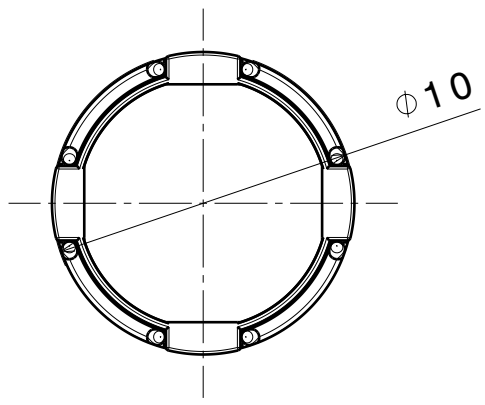

Top view

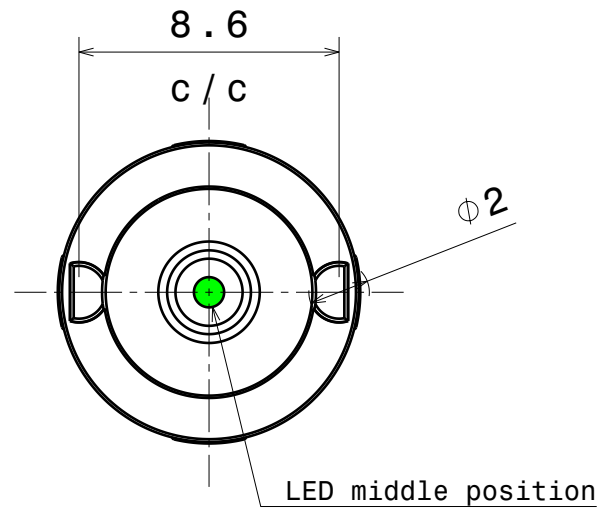

Bottom view

INDEX	PART NO	DESCRIPTION	MATERIAL	COLOUR
1	F10989	LISA2-HLD-PIN	PC	black
2	-	LISA2_lens	PMMA	

Tolerances if not otherwise shown
 According to DIN ISO 2768-1
 Linear measures:
 up to 30mm class M, otherwise class C
 According to DIN ISO 2768-2
 Form and position: class L

LEDiL LediL Oy
 Salorankatu 10
 FIN 24240 SALO
 Finland

THIRD ANGLE PROJECTION:

DRAWING TITLE
Lisa2-PIN-XP assembly

This drawing is the property of LEDiL Oy. It may not be reproduced, copied or communicated without a written agreement with LEDiL Oy.

SIZE	PART NUMBER
A4	-

SCALE	4:1	WEIGHT	0,5 g	SHEET	1/1
-------	-----	--------	-------	-------	-----

D

A

Luminaire: Ledil Oy FA11055_Lisa2-RS-Pin-XP FA11055_Lisa2-RS-Pin-XP
Lamps: 1 x Cree XP-E (White)

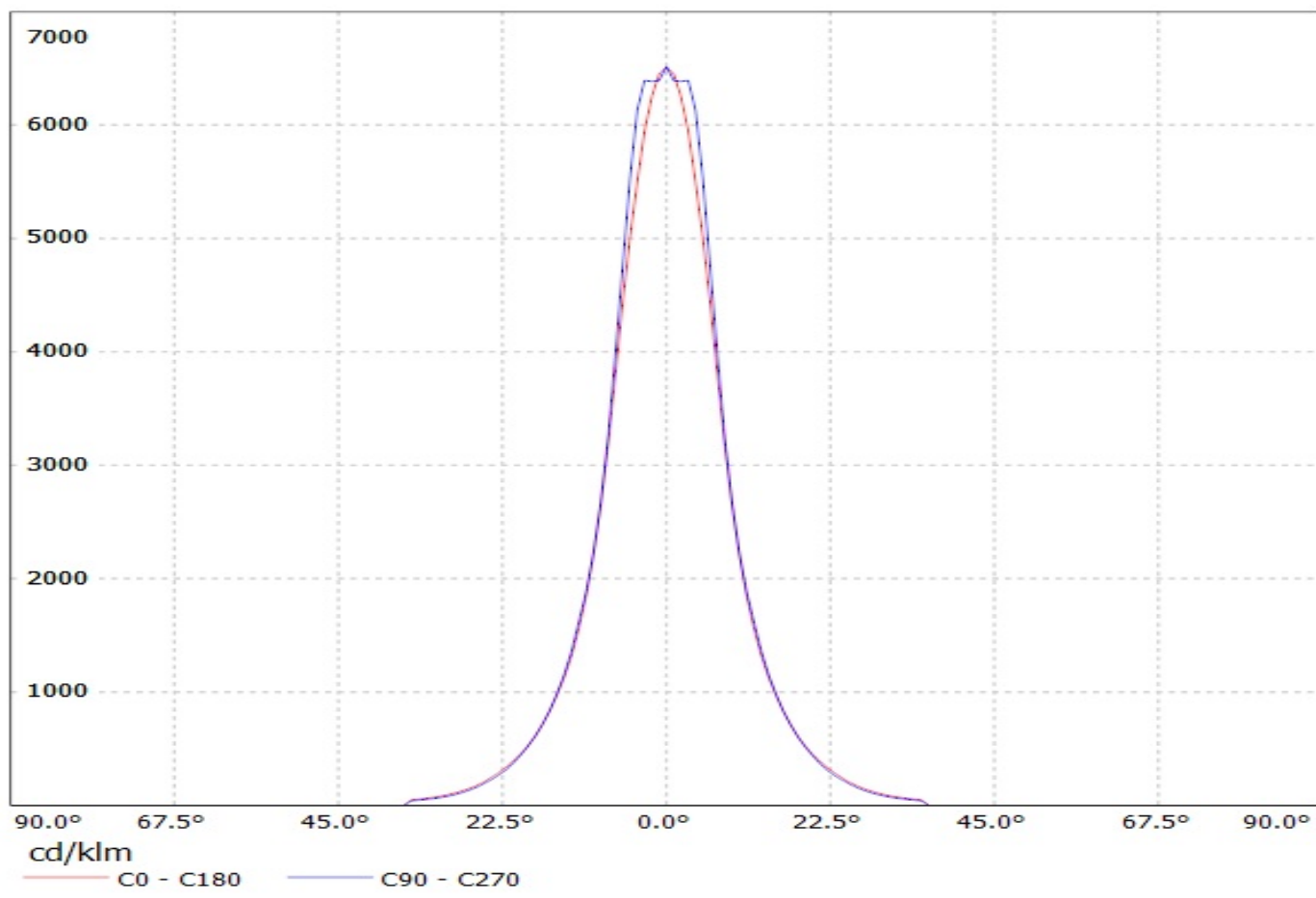

Luminaire: Ledil Oy FA11055_Lisa2-RS-Pin-XP-G FA11055_Lisa2-RS-Pin-XP-G
Lamps: 1 x Cree XP-G (White)

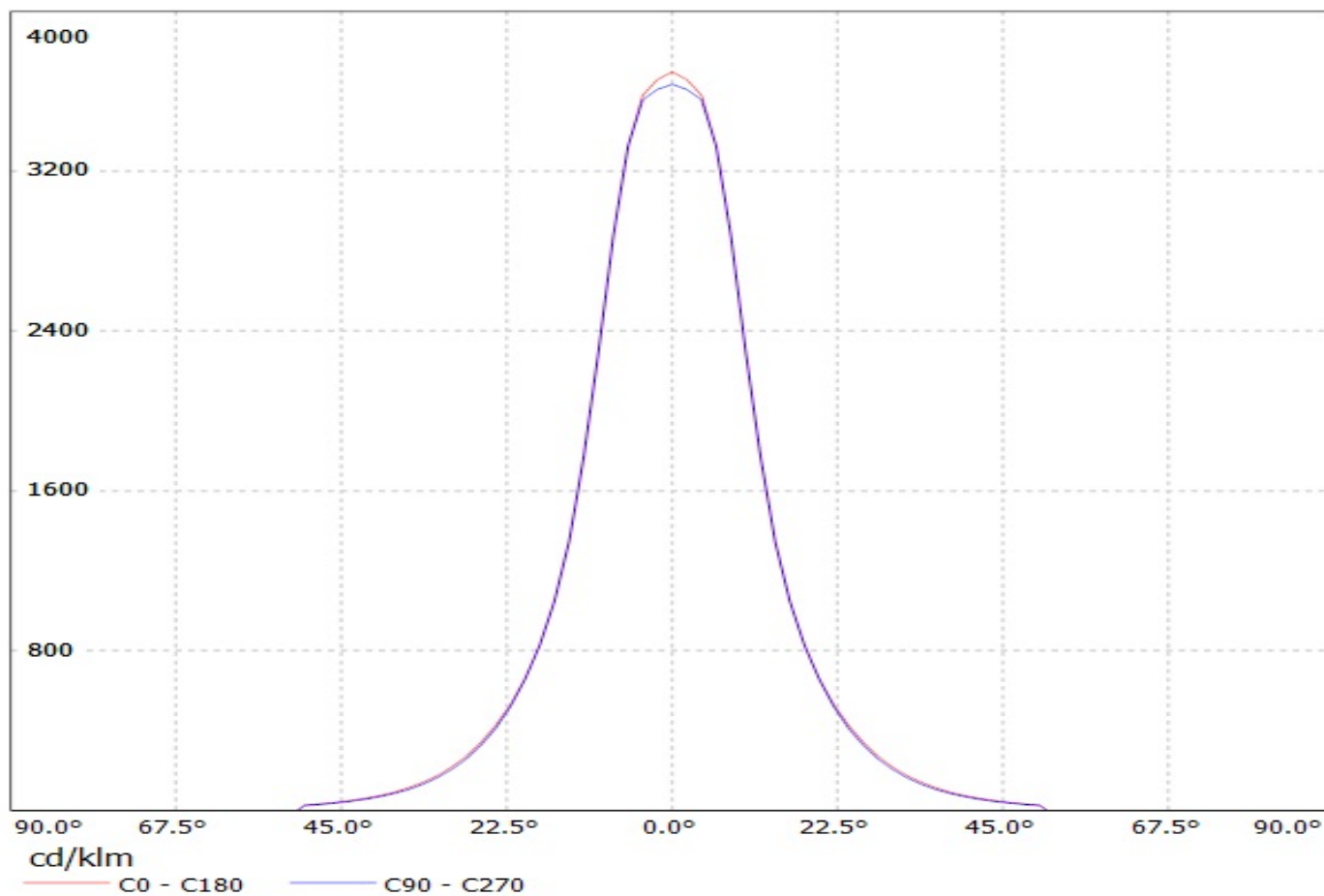

Luminaire: LEDil Oy FP11055_LISA2-RS-PIN_(Luxeon_Z_ES) Efficiency=84%
Lamps: 1 x Philips Lumileds Luxeon Z ES (LXZ2-3090) 50.4lm @ 250mA CCT=3200K P=0.7 I=250mA

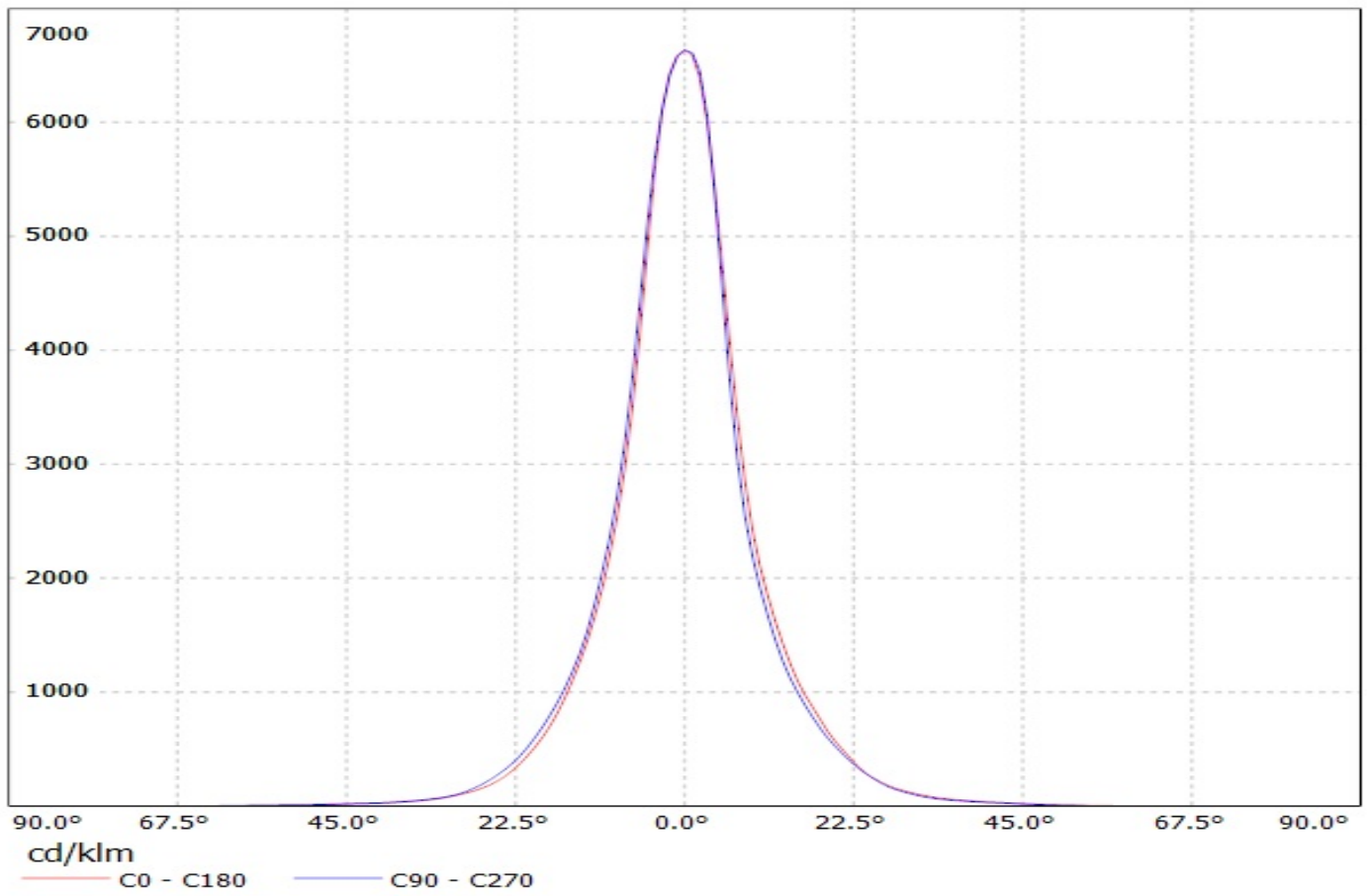

Luminaire: LEDiL Oy FP11055_LISA2-RS-PIN_(Luxeon_C_WHITE)
Lamps: 1 x Luxeon_C_WHITE_84.9929lm@250mA_P=0.7402W_I=0.250A

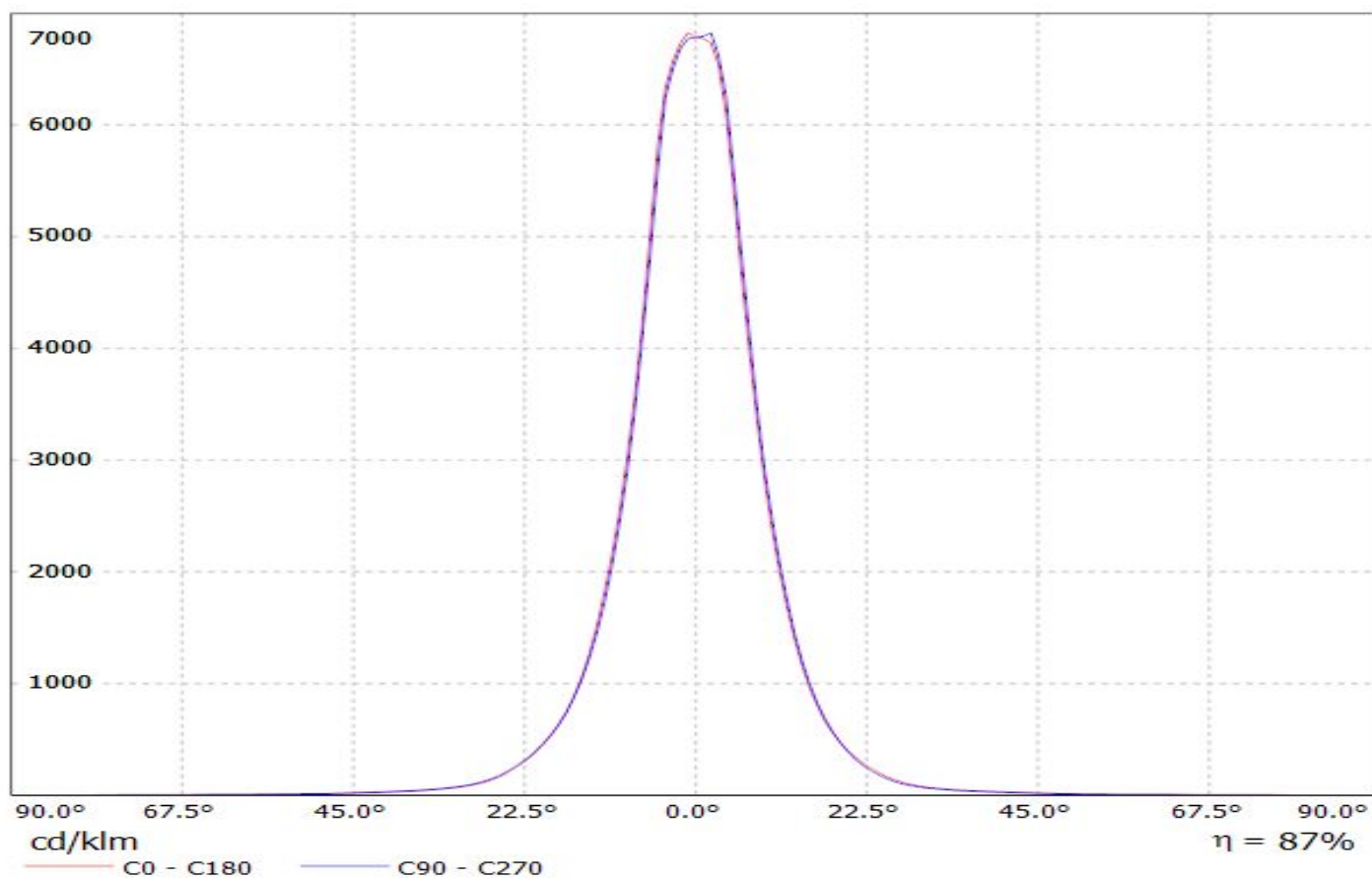

Luminaire: Ledil Oy FP11055_LISA2-RS-PIN_(Oslon_SSL_80)_SIMULATED
Lamps: 1 x Osram Oslon SSL 80

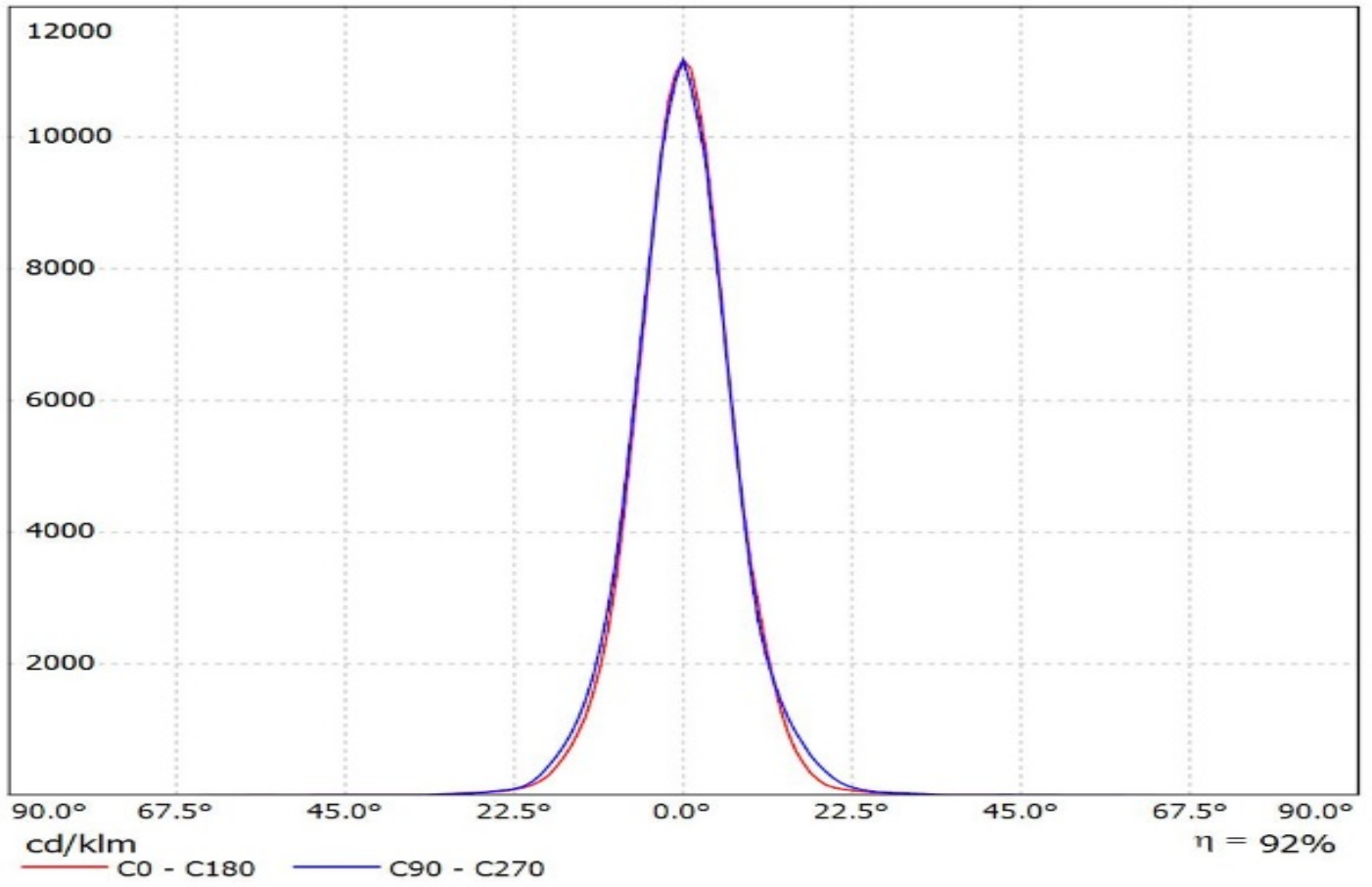

Luminaire: Ledil Oy FA11055_Lisa2-RS-Pin-XP FA11055_Lisa2-RS-Pin-XP
Lamps: 1 x Cree XP-E (White)

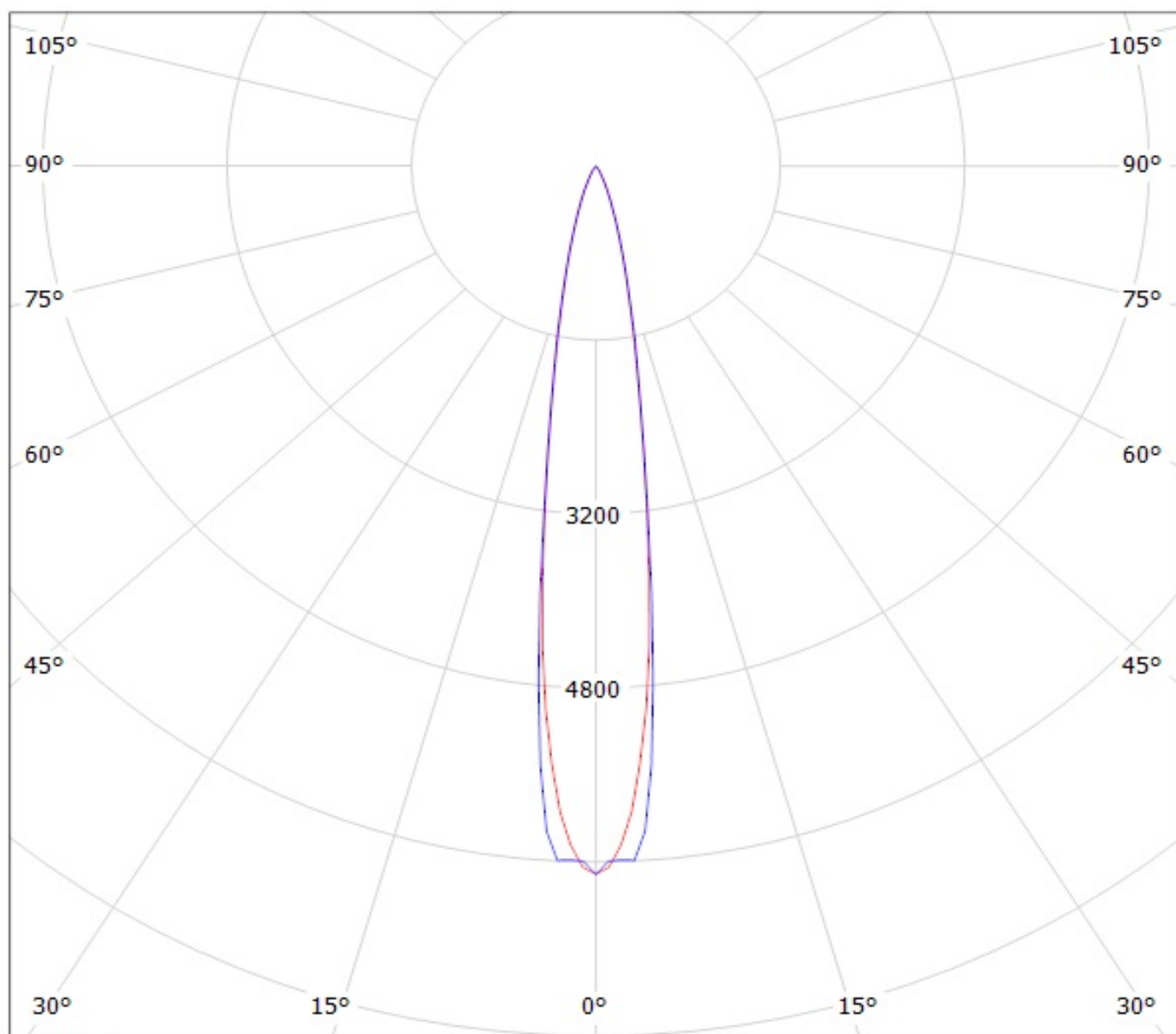

cd/klm

— C0 - C180 — C90 - C270

Luminaire: Ledil Oy FA11055_Lisa2-RS-Pin-XP-G FA11055_Lisa2-RS-Pin-XP-G
Lamps: 1 x Cree XP-G (White)

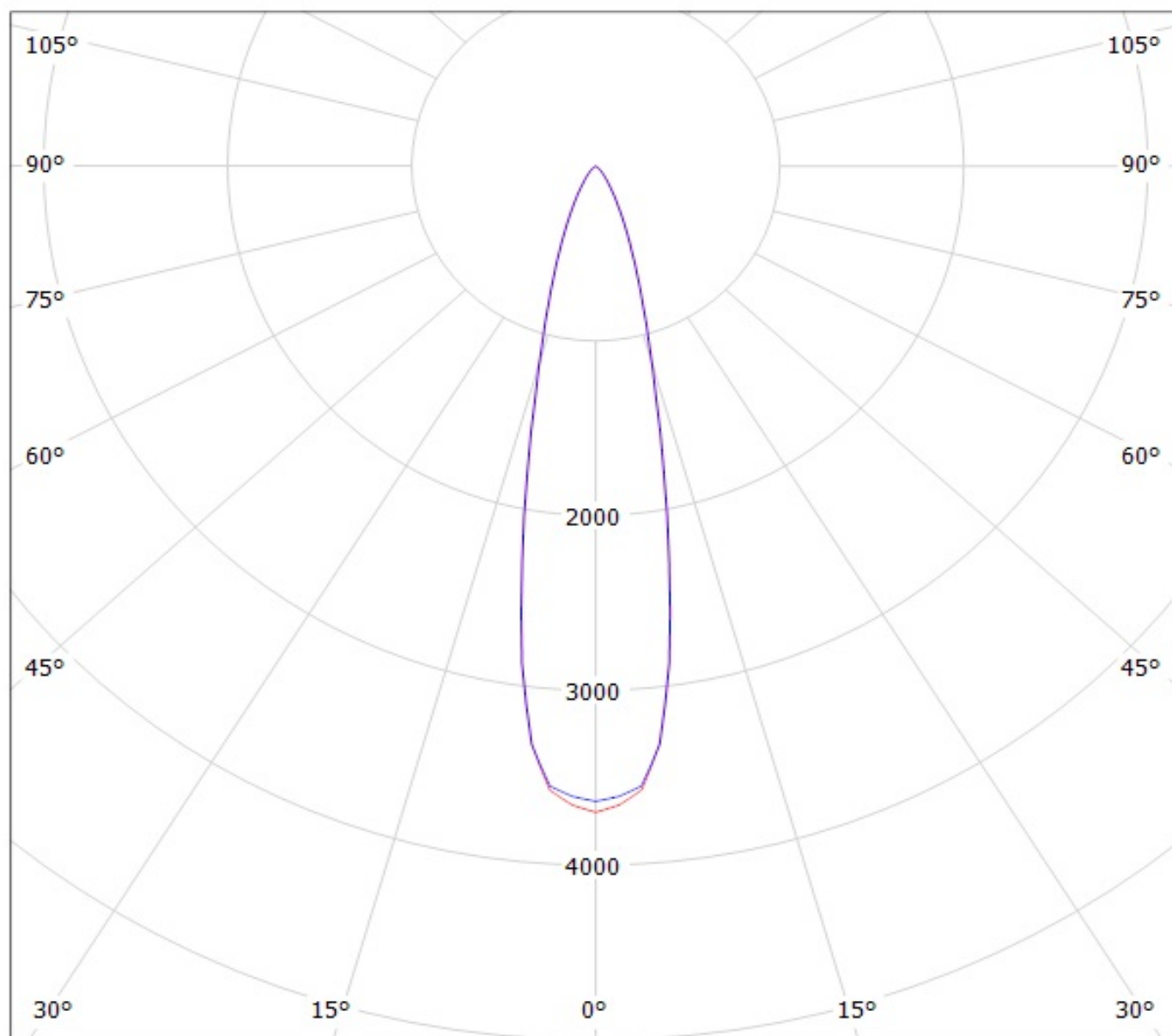

cd/klm

— C0 - C180

— C90 - C270

Luminaire: LEDil Oy FP11055_LISA2-RS-PIN_(Luxeon_Z_ES) Efficiency=84%

Lamps: 1 x Philips Lumileds Luxeon Z ES (LXZ2-3090) 50.4lm @ 250mA CCT=3200K P=0.7 I=250mA

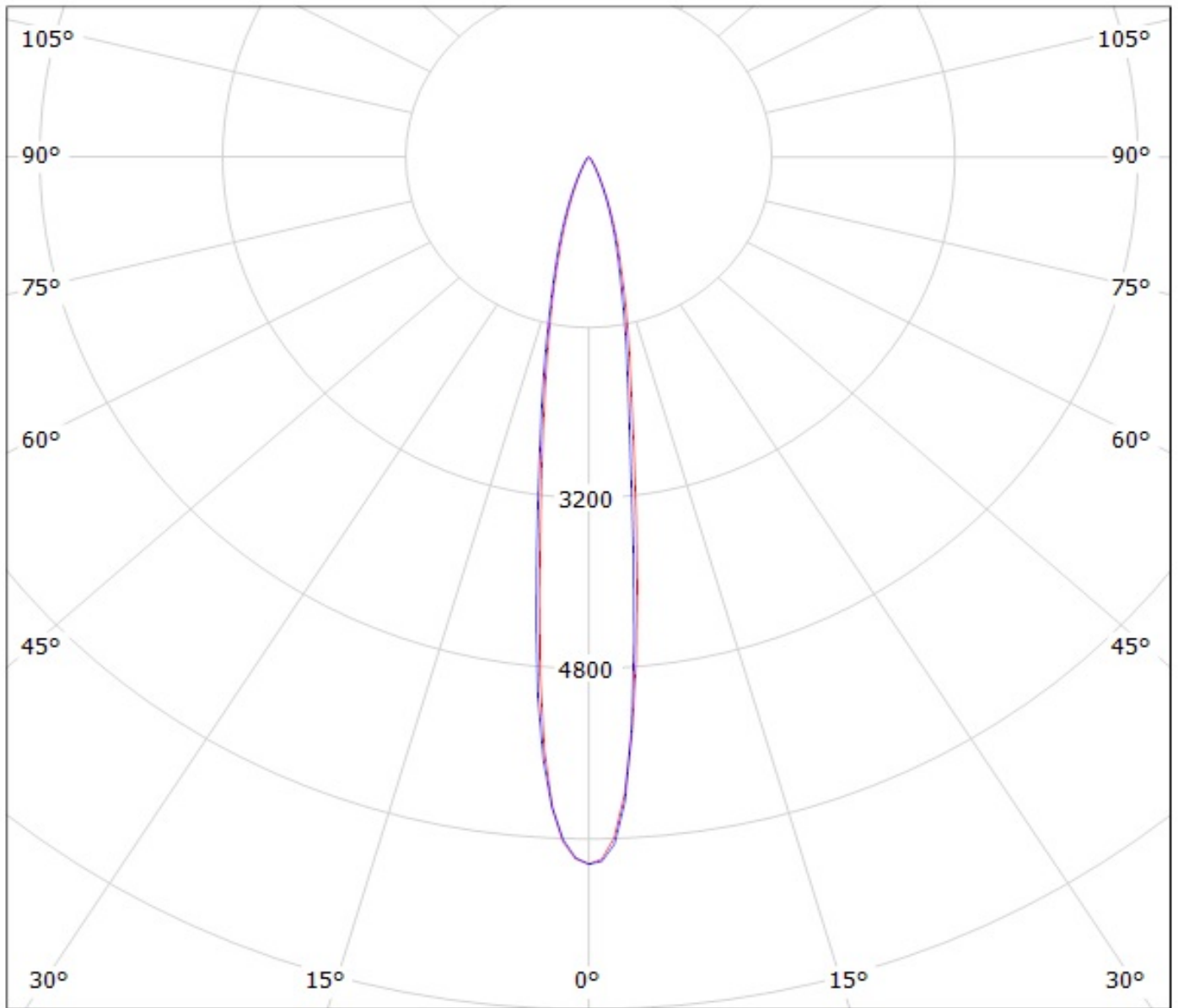

cd/klm

— C0 - C180

— C90 - C270

Luminaire: LEDiL Oy FP11055_LISA2-RS-PIN_(Luxeon_C_WHITE)
Lamps: 1 x Luxeon_C_WHITE_84.9929lm@250mA_P=0.7402W_I=0.250A

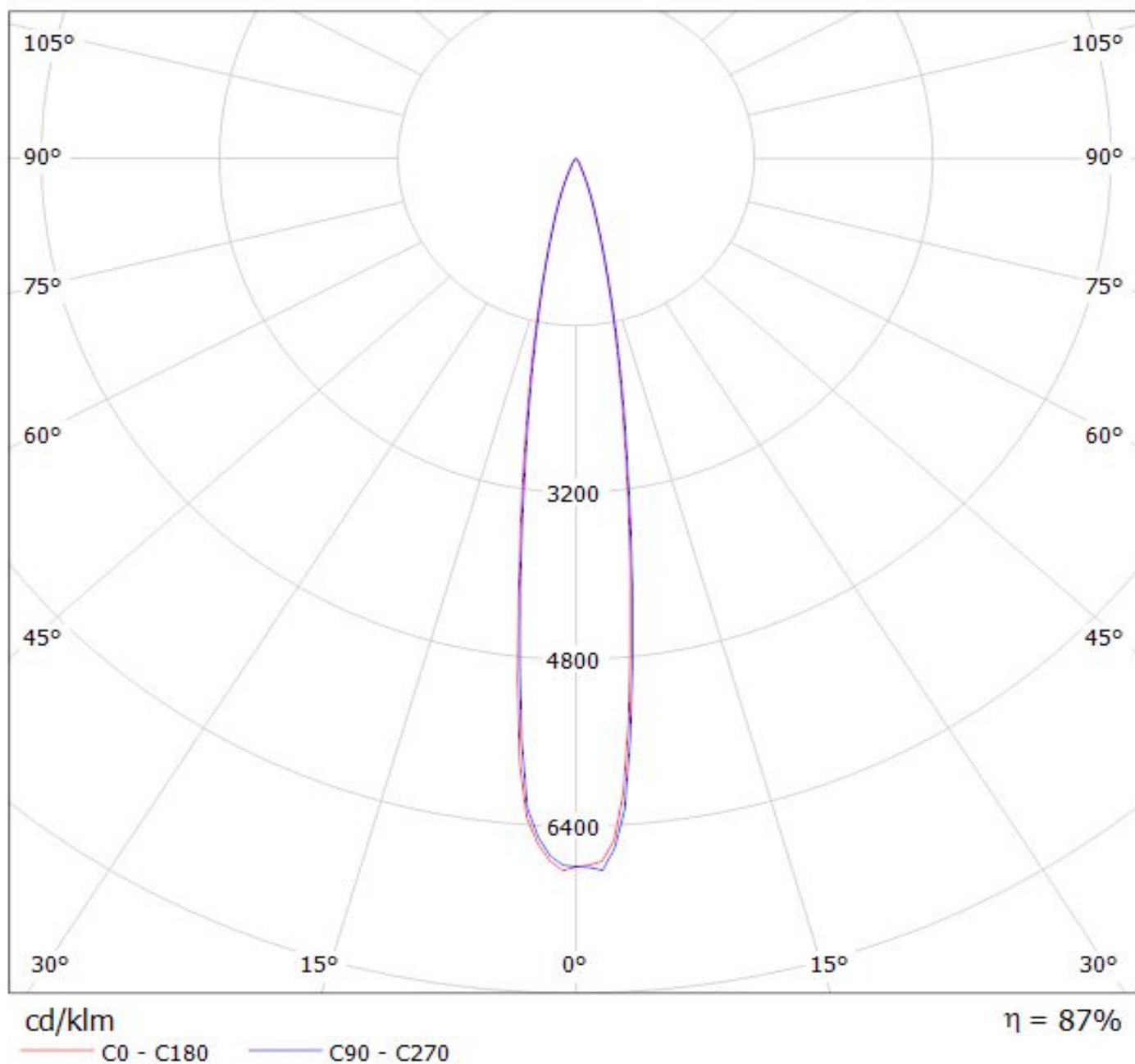

Luminaire: Ledil Oy FP11055_LISA2-RS-PIN_(Oslon_SSL_80)_SIMULATED
Lamps: 1 x Osram Oslon SSL 80

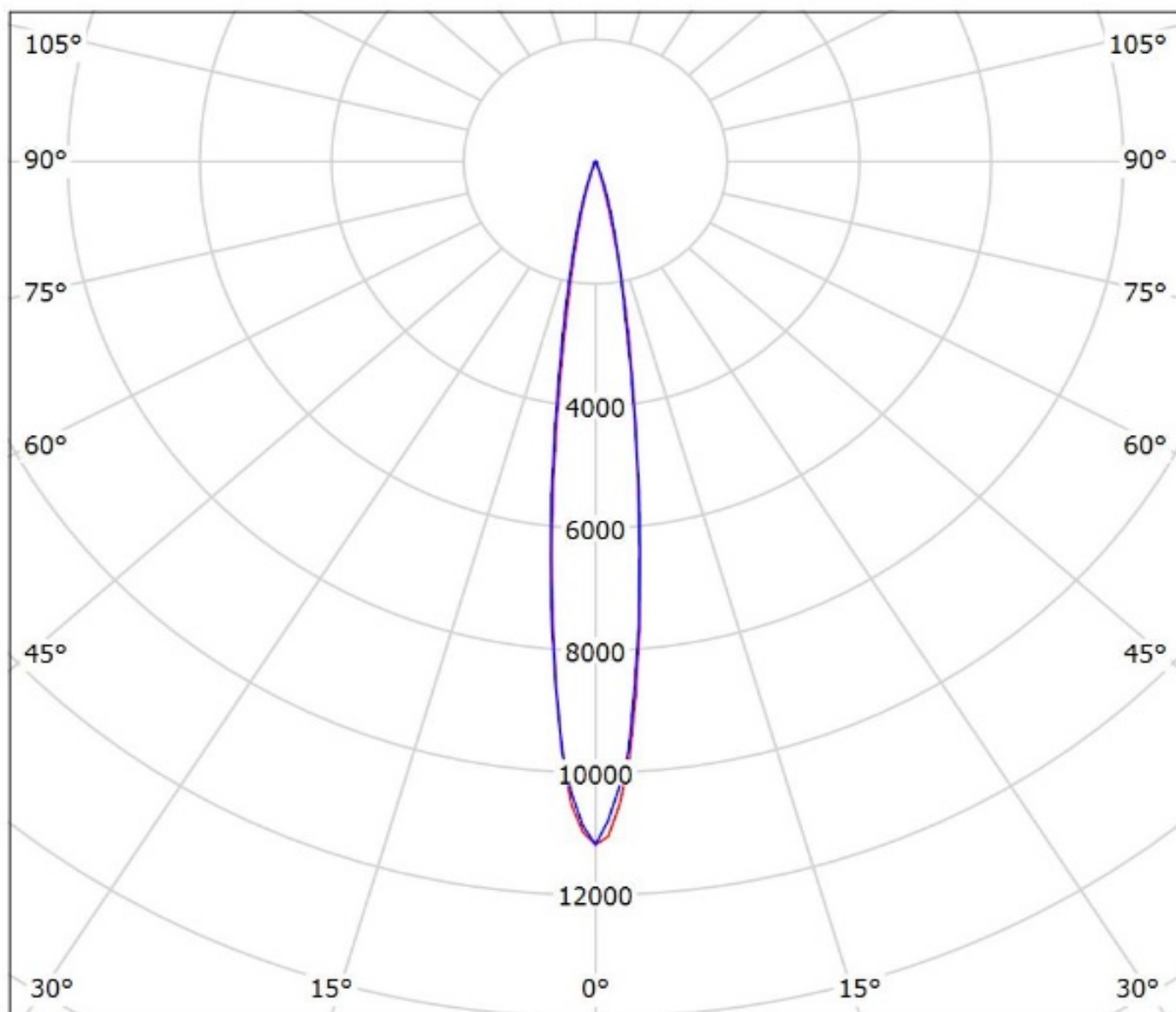

cd/klm
— C0 - C180 — C90 - C270

$\eta = 92\%$

NOTE: The typical divergence will be changed by different color, chip size and chip position tolerance. The typical total divergence is the full angle measured where the luminous intensity is half of the peak value.