

DETAILS

Product Number	CA12787_STRADA-K
Family	Strada
Type	Assembly
Color	clear
Diameter	19,6 x 15,5 mm
Height	8,8 mm
Style	rectang
Optic Material	PMMA
Holder Material	
Fastening	tape, pin
Status	production ready
ROHS Compliant	Yes
Date Updated	10/05/2017



OPTICAL PROPERTIES

LED	Viewing Angle	Light Beam	Efficiency	cd/lm	Connector
XP-G	Asymmetric deg	Streetligh...	95 %	1.000	-
XT-E	Asymmetric deg	Streetligh...	96 %	1.160	-
XB-D	Asymmetric deg	Streetligh...	96 %	1.180	-
XP-G2	asymmetric deg	Streetligh...	94 %	1.000	-
XP-E2	asymmetric deg	Streetligh...	94 %	1.100	-
H35C0 (LEMWA33)	Asymmetric deg	Streetligh...	96 %	0.840	-
LUXEON T	Asymmetric deg	Streetligh...	94 %	1.000	-
LUXEON TX	Asymmetric deg	Streetligh...	94 %	1.050	-
NVSxx19B/NVSxx19C	sim: Asym	Streetligh...	sim: 94 %	sim: 1.007	-
Fortimo FastFlex LED board 2x8/757 DS	Asymmetric deg	Streetligh...	94 %	0.970	-
LH351A(3535)	sim: Asymmetric	Streetligh...	sim: 92 %	-	-
LH351B	sim: Asymmetric	Streetligh...	sim: 94 %	-	-
LH351Z	asymmetric deg	Streetligh...	94 %	1.100	-
TL1L4	asymmetric deg	Streetligh...	94 %	1.170	-

Absolute intensity of CA12787_&_C12786_STRADA-K_(XP-G)

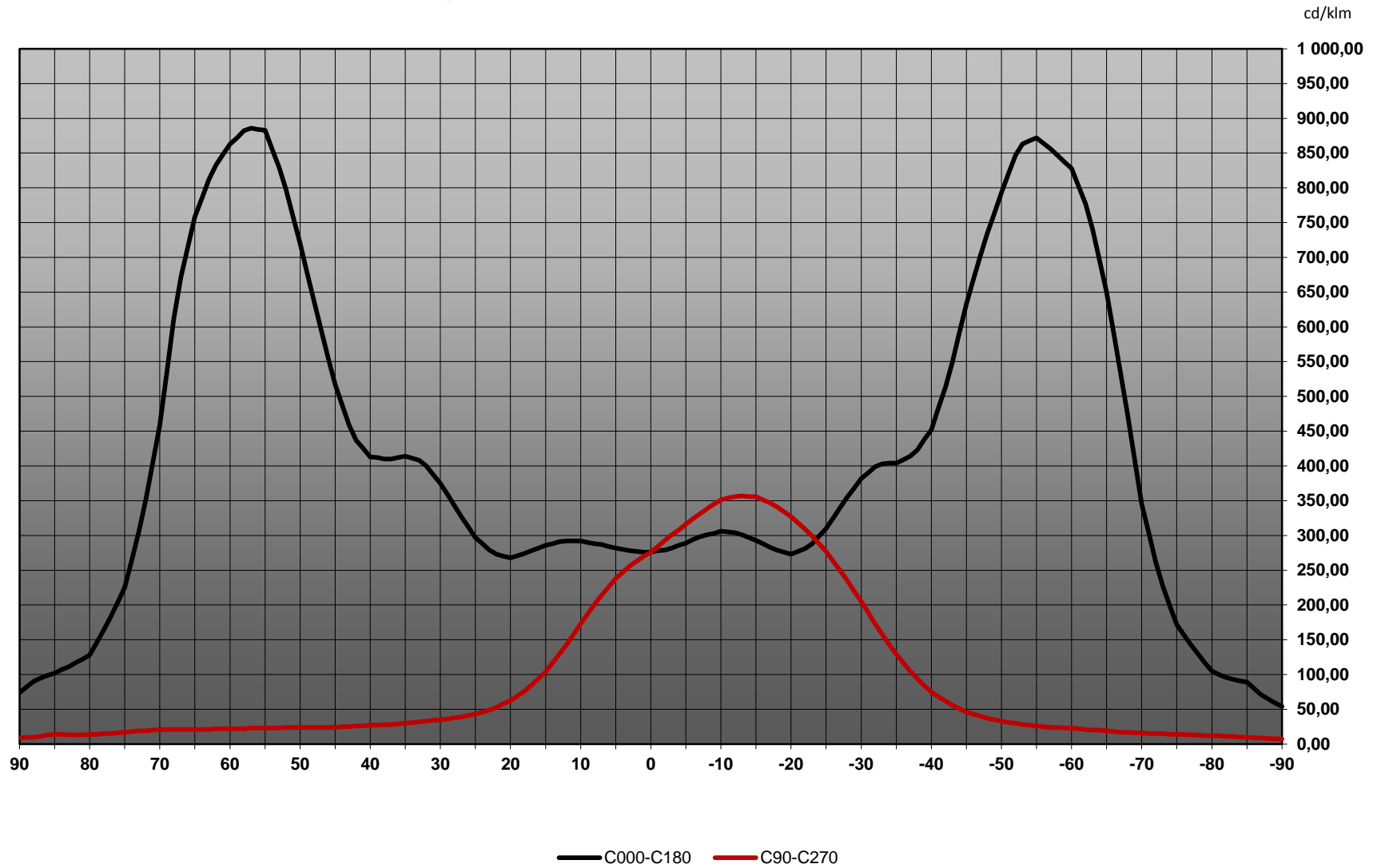

Absolute intensity of CA12787_STRADA-K_(XT-E_AWT)

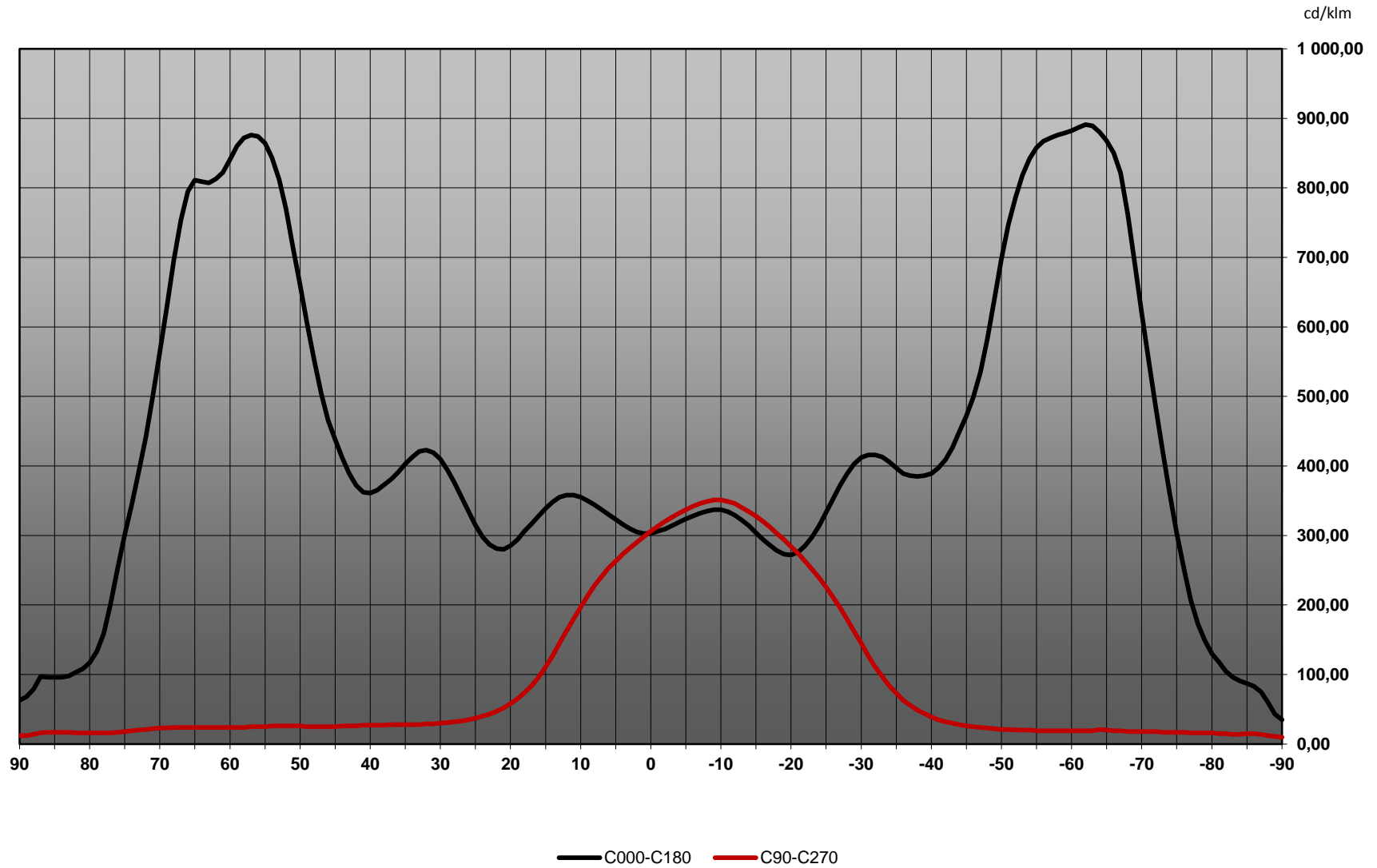

Absolute intensity of CA12787_STRADA-K_(XB-D)

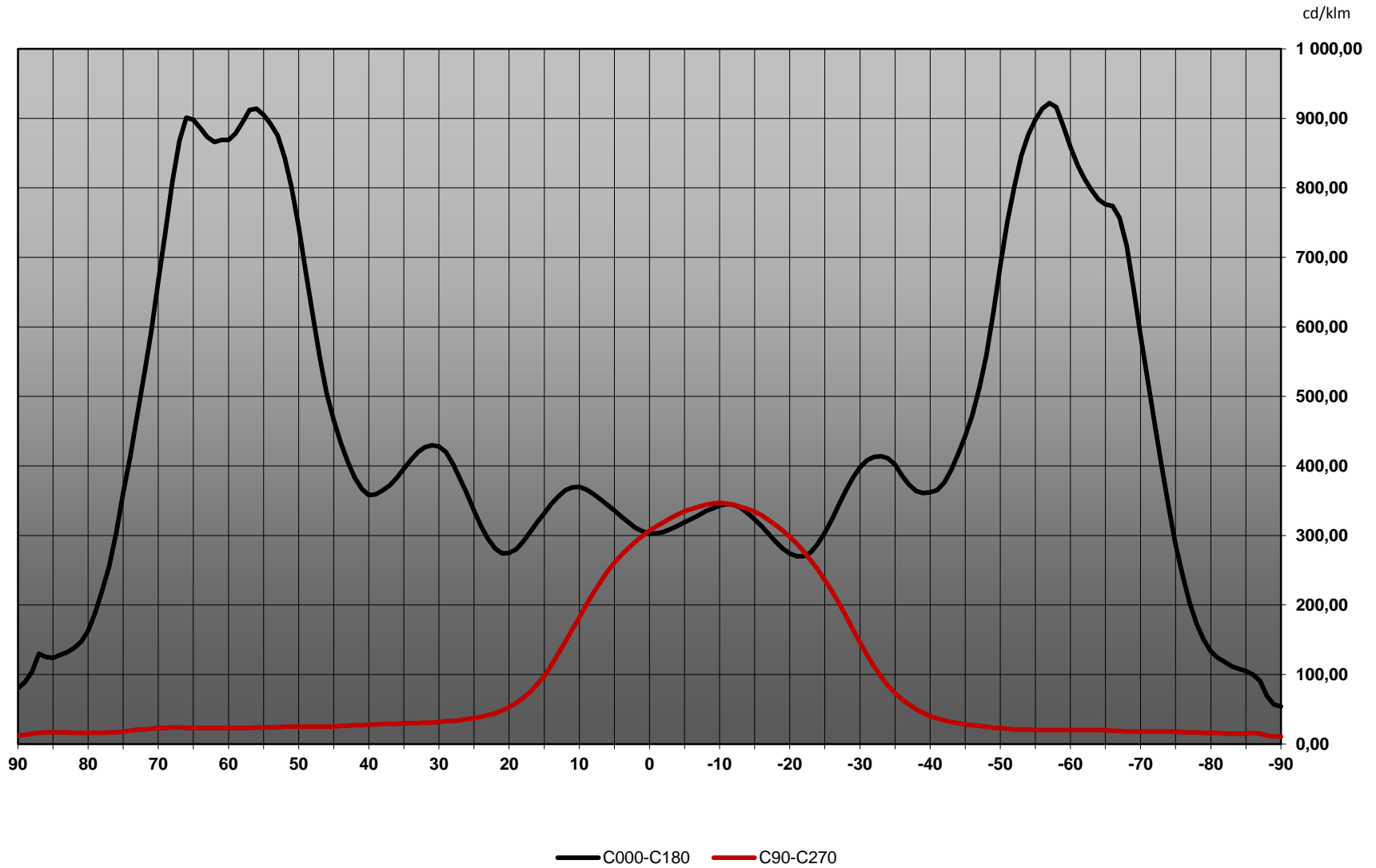

D

C

B

A

4

4

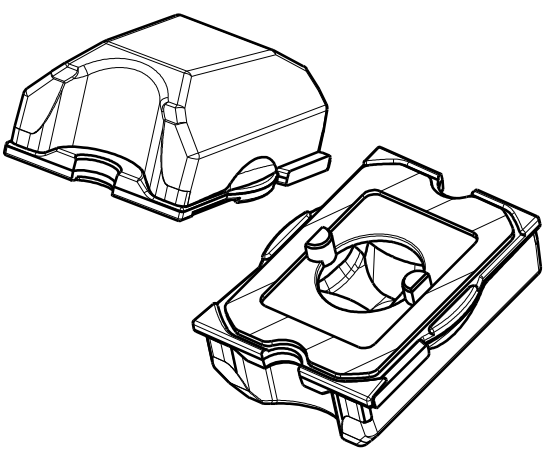

Isometric view

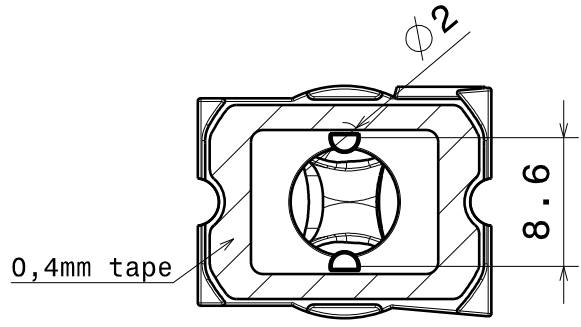

Bottom view

3

3

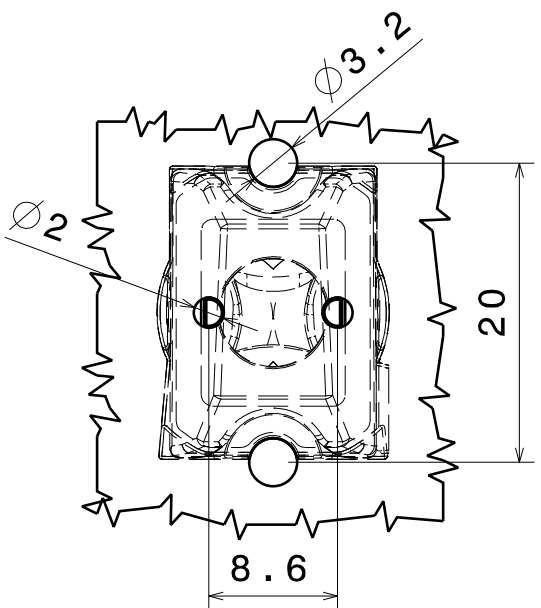

PCB- suggestion

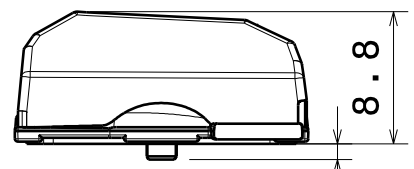

Front view

2

2

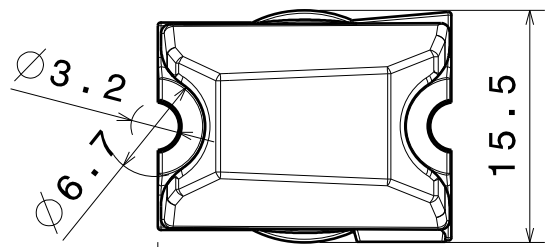

Top view

Material: PMMA

Tolerances for dimensions:
 0-20mm tolerance value ± 0.1 mm
 21-45mm tolerance value ± 0.2 mm
 46-90mm tolerance value ± 0.3 mm
 91-100mm tolerance value ± 0.4 mm
 101-mm tolerance value ± 0.5 mm

This drawing is our property.
 It can't be reproduced
 or communicated without
 our written agreement.



Ledil Oy
 Salorankatu 10
 FIN 24240 SALO
 Finland

DRAWING TITLE

DRAWN BY
 mav

DATE
 18.04.2012

Datasheet STRADA-K

CHECKED BY
 sn

DATE
 18.04.2012

SIZE
A4

DRAWING NUMBER
CA12787

REV
1

DESIGNED BY
 mav

DATE
 06.03.2012

SCALE 1:1

WEIGHT (g)

SHEET 1/1

D

A

1

1

Luminaire: LEDIL OY CA12787_ & C12786_STRADA-K_(XP-G) Eff=95%
Lamps: 1 x Cree XP-G 86.6lm@ 250mA

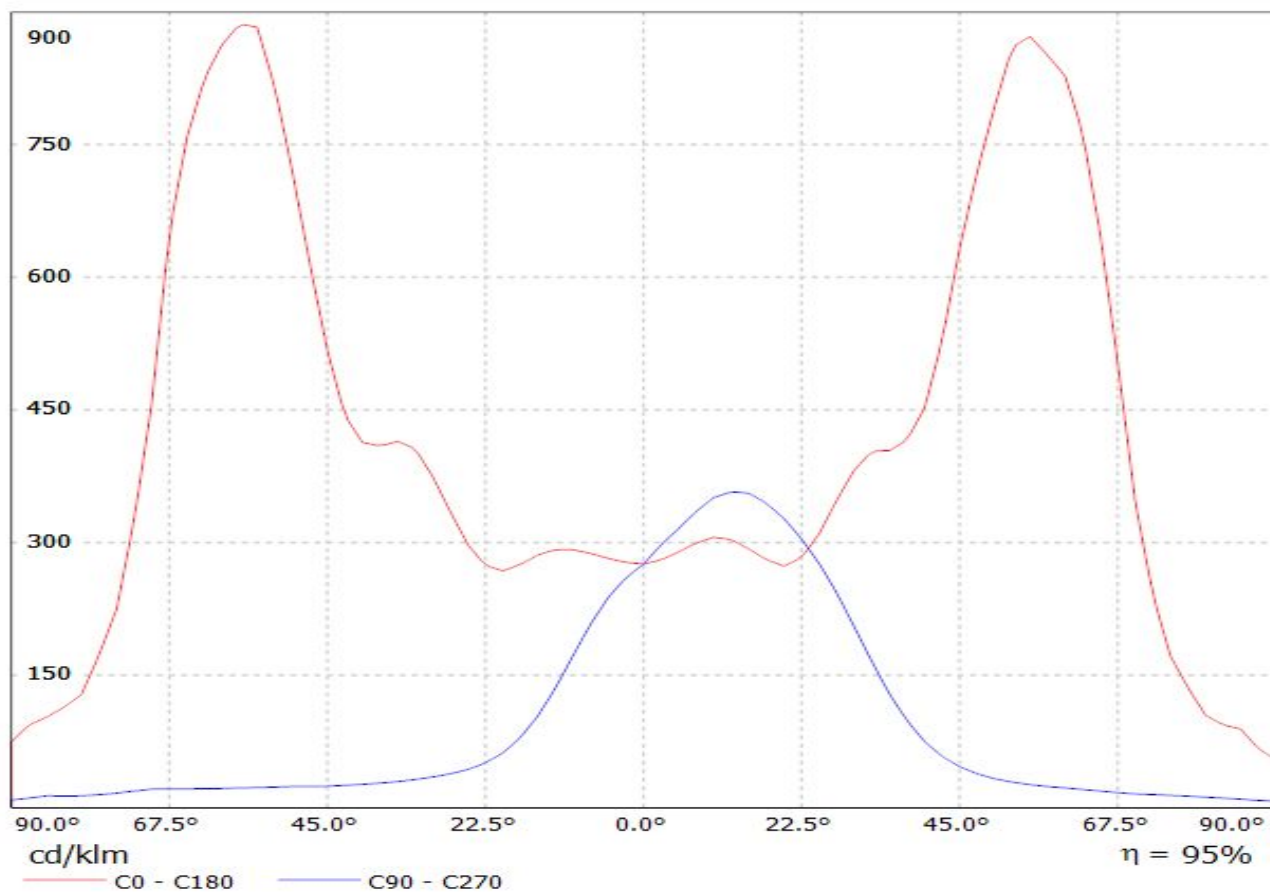

Luminaire: LEDil Oy CA12787_STRADA-K_(XP-G2) Efficiency=94%
Lamps: 1 x Cree XP-G2 (XPGBWT-L1-0000-00FE4) 101lm @ 250mA CCT=6600K P=0.7W I=250mA

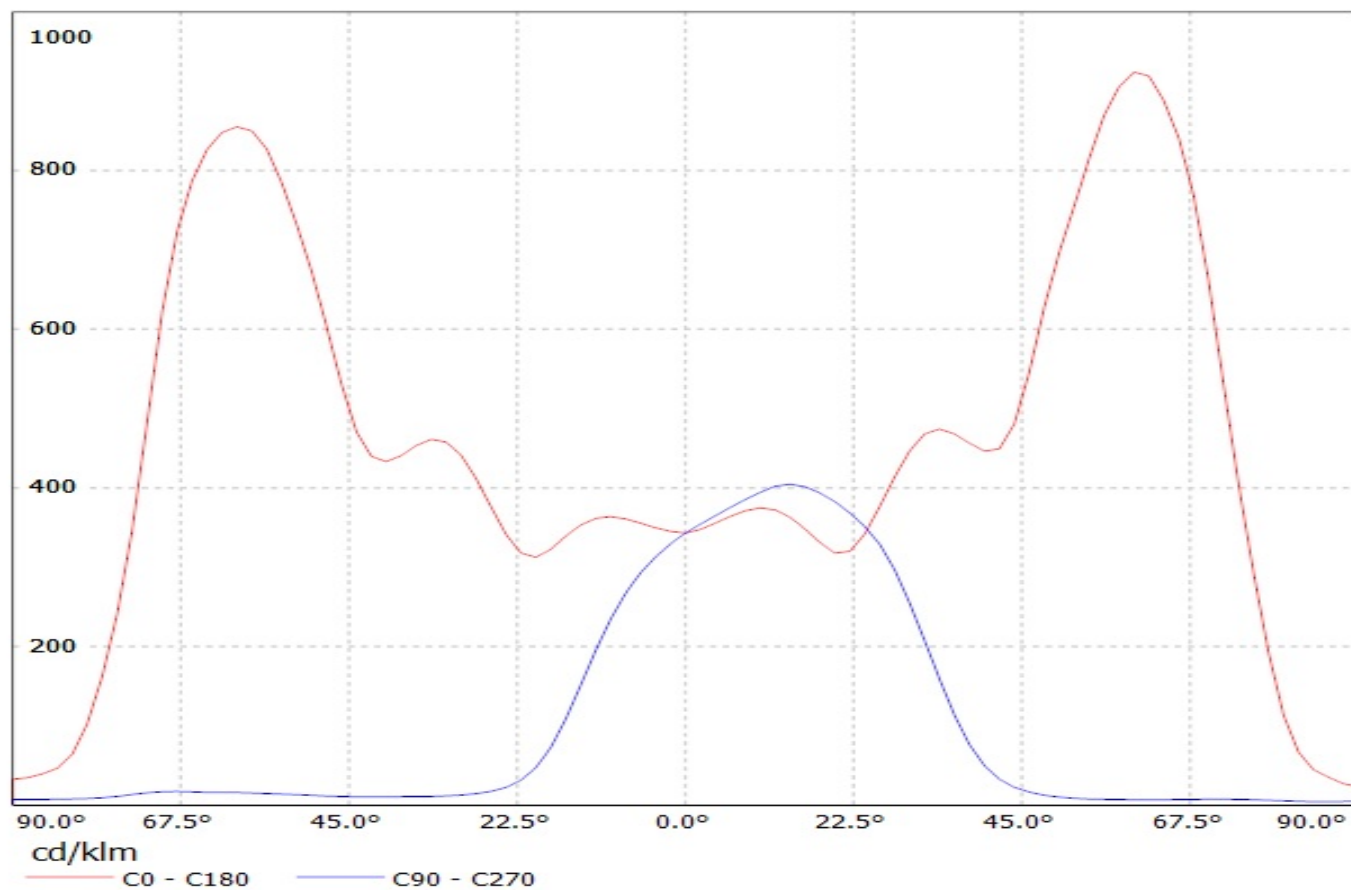

Luminaire: LEDil Oy CA12787_STRADA-K_(XP-E2) Efficiency=94%
Lamps: 1 x Cree XP-E2 (XPEBWT-L1-7B4-Q4-0-01) 84.8lm @ 250mA CCT=3200K P=0.8W I=250mA

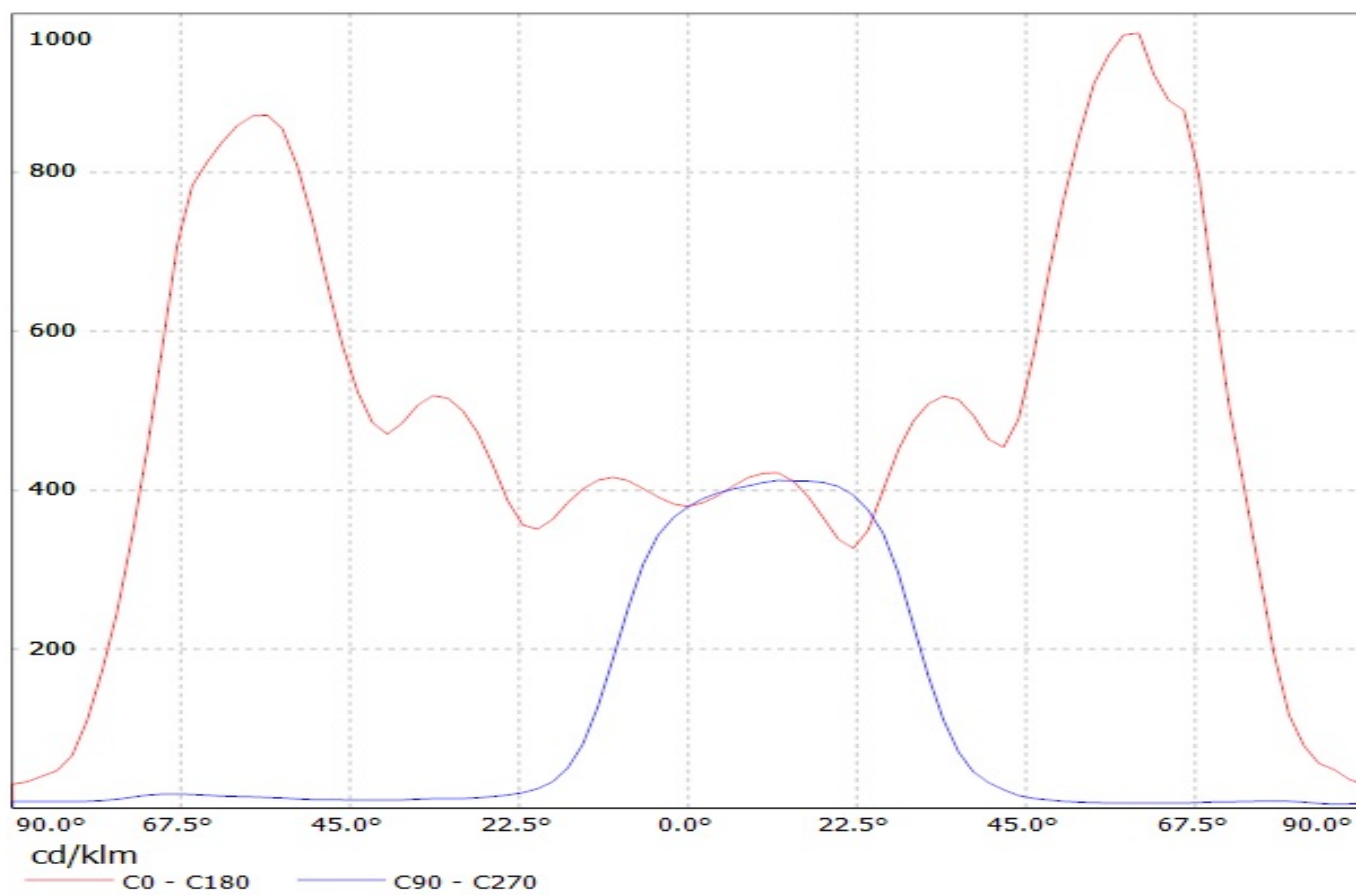

Luminaire: LEDiL Oy CA12787_STRADA-K_(LG3535) Eff. 96,1%
Lamps: 1 x LG Ceramic 3535 PKG (95lm@250mA)

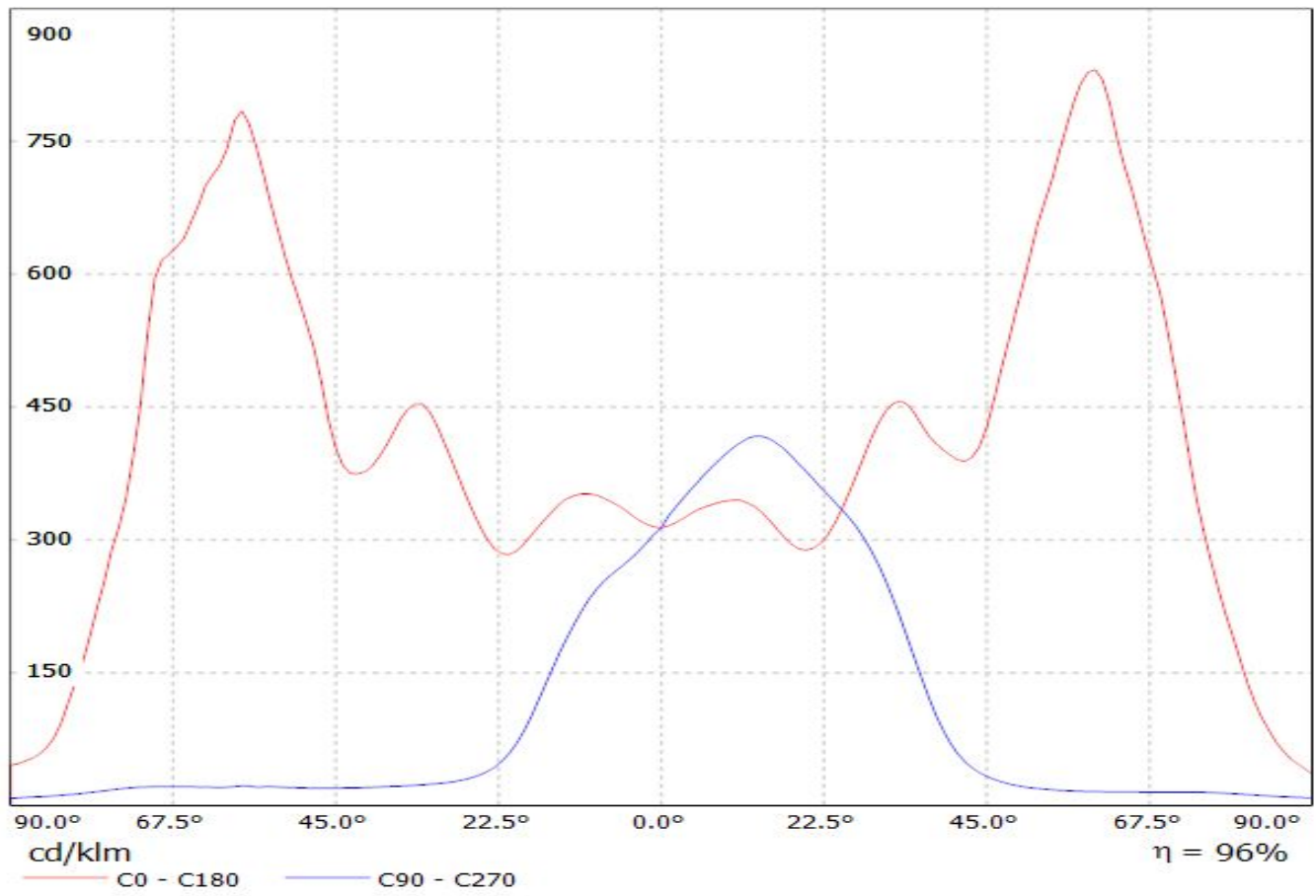

LEDiL Oy CA12787_STRADA-K_(LUXEON_T) Eff.94.0% / LDC (Linear)

Luminaire: LEDiL Oy CA12787_STRADA-K_(LUXEON_T) Eff.94.0%

Lamps: 1 x LUXEON_T_(LXH8-FW30-3)_74.11lm@250mA_CCT=3158K_P=0.730833W_I=249.9mA

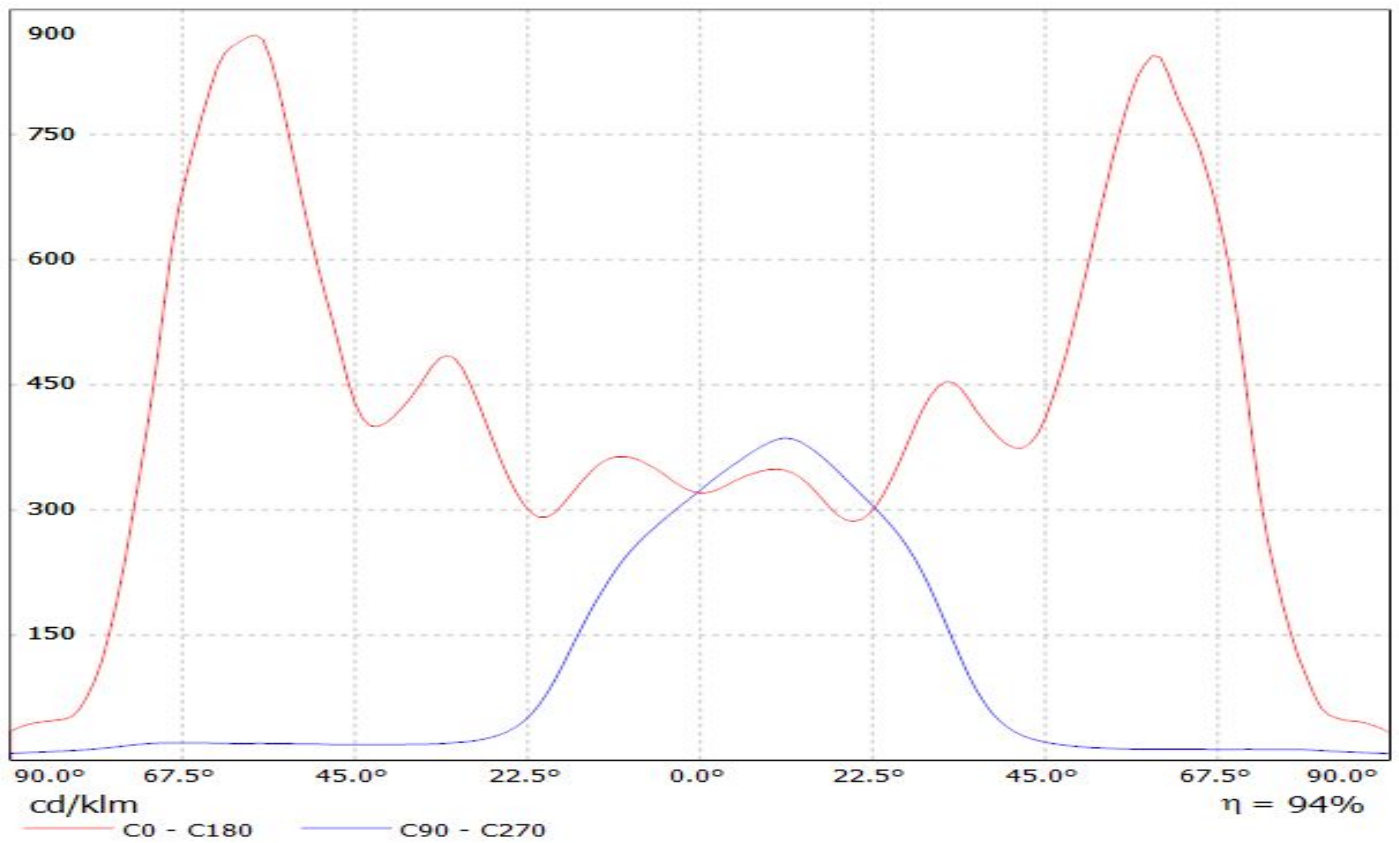

Luminaire: LEDiL Oy CA12787_STRADA-K (Luxeon_TX)
Lamps: 1 x Luxeon_TX_(L1T2-3585)_80.1801lm@250mA_CCT=3500K_P=0.730583W_I=249.9mA

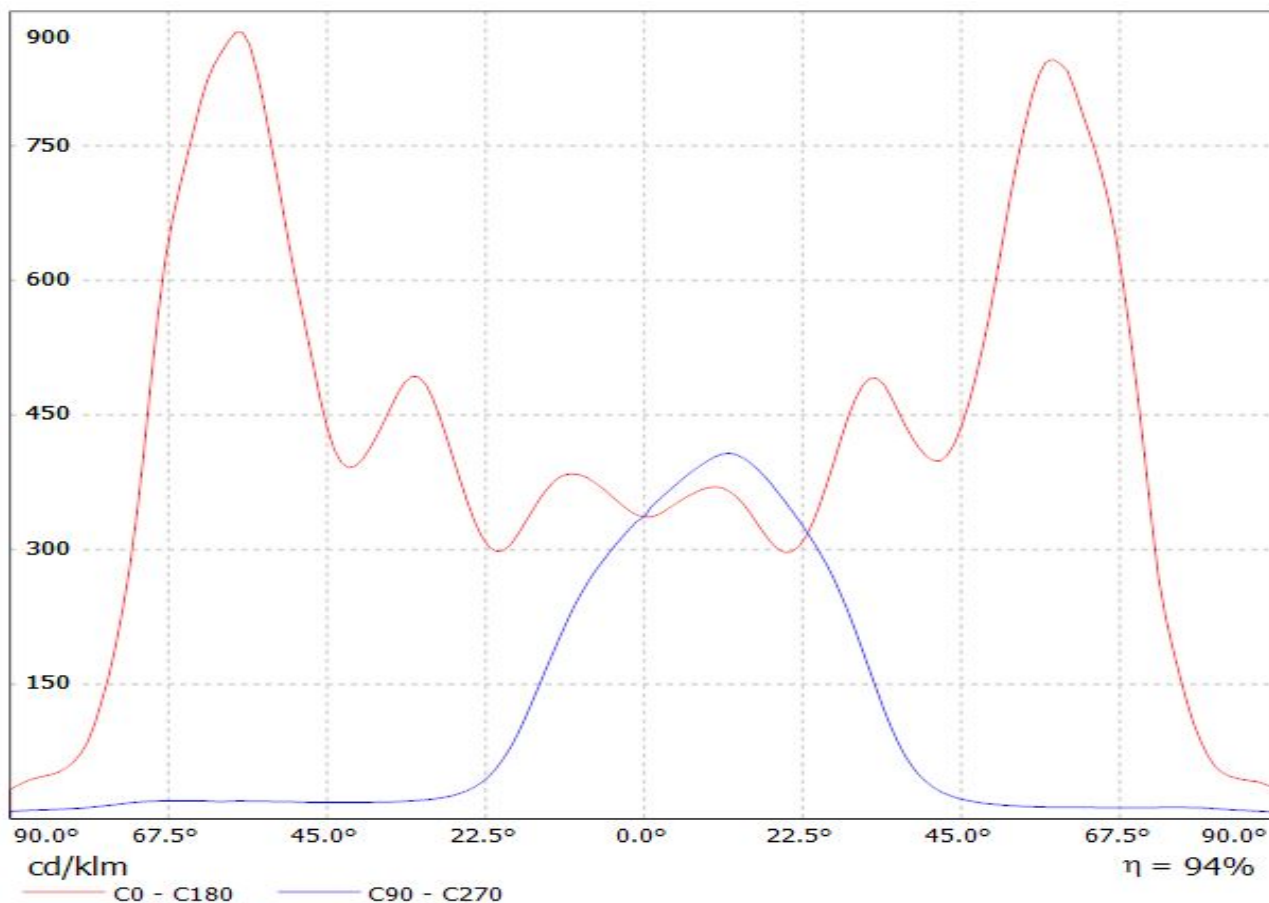

Ledil CA12787_STRADA-K_(Fortimo_FastFlex_LED_board 2x8-757_DS_G3) / LDC (Linear)

Luminaire: Ledil CA12787_STRADA-K_(Fortimo_FastFlex_LED_board 2x8-757_DS_G3)
Lamps: 1 x Philips_Fortimo_FastFlex_LED_board 2x8/757_DS_G3_(XP-G2)
_3428.78lm@500mA_P=23.7W_I=0.5A

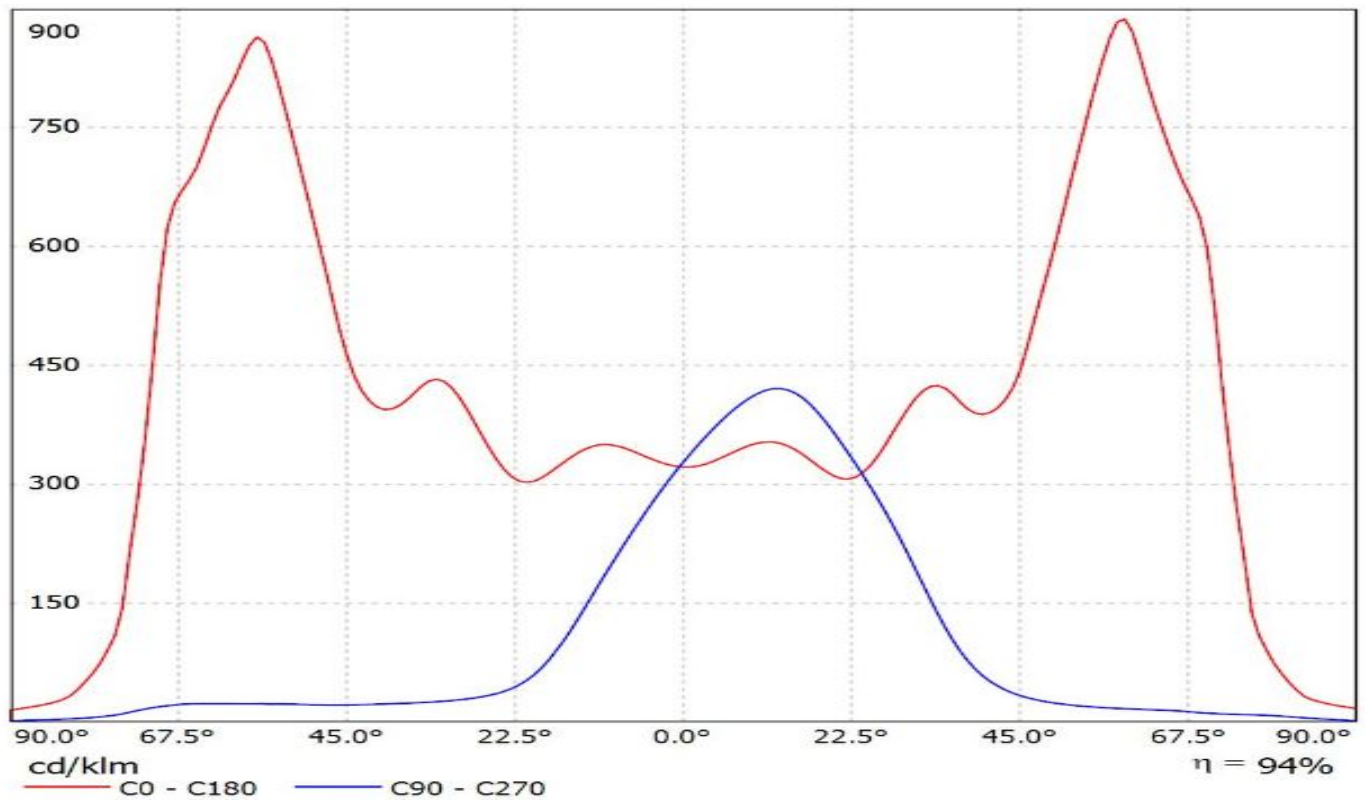

Luminaire: LEDiL Oy CA12787_STRADA-K_(LH351Z)

Lamps: 1 x SAMSUNG_LH351Z_92.91lm@250mA_P=0.747026W_I=249.9mA

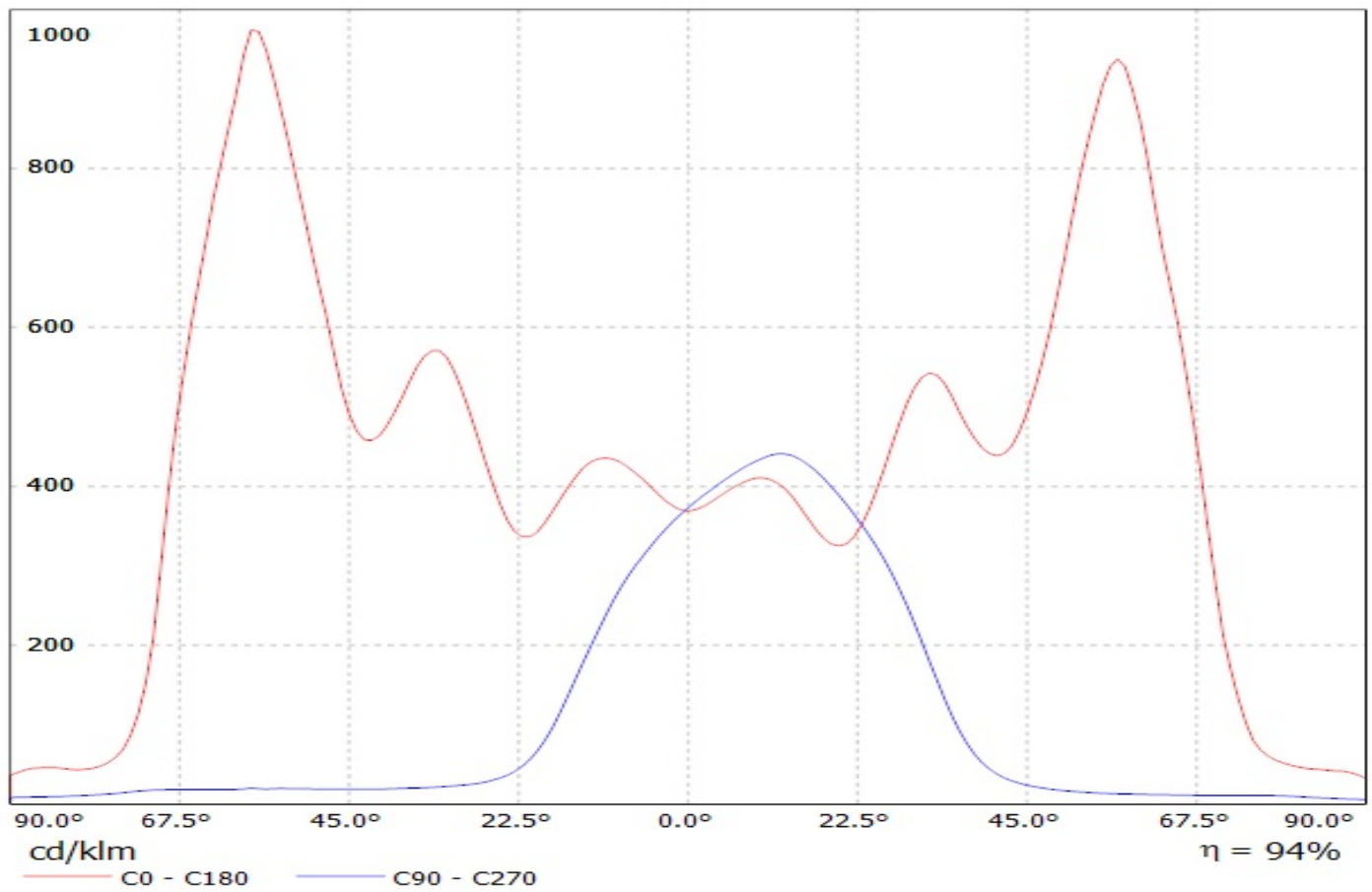

Luminaire: LEDiL Oy CA12787_STRADA-K_(Toshiba_TL1L4)

Lamps: 1 x Toshiba_TL1L4_(TL1L4-DW0)_103.82lm@250mA_P=0.776_I=250mA

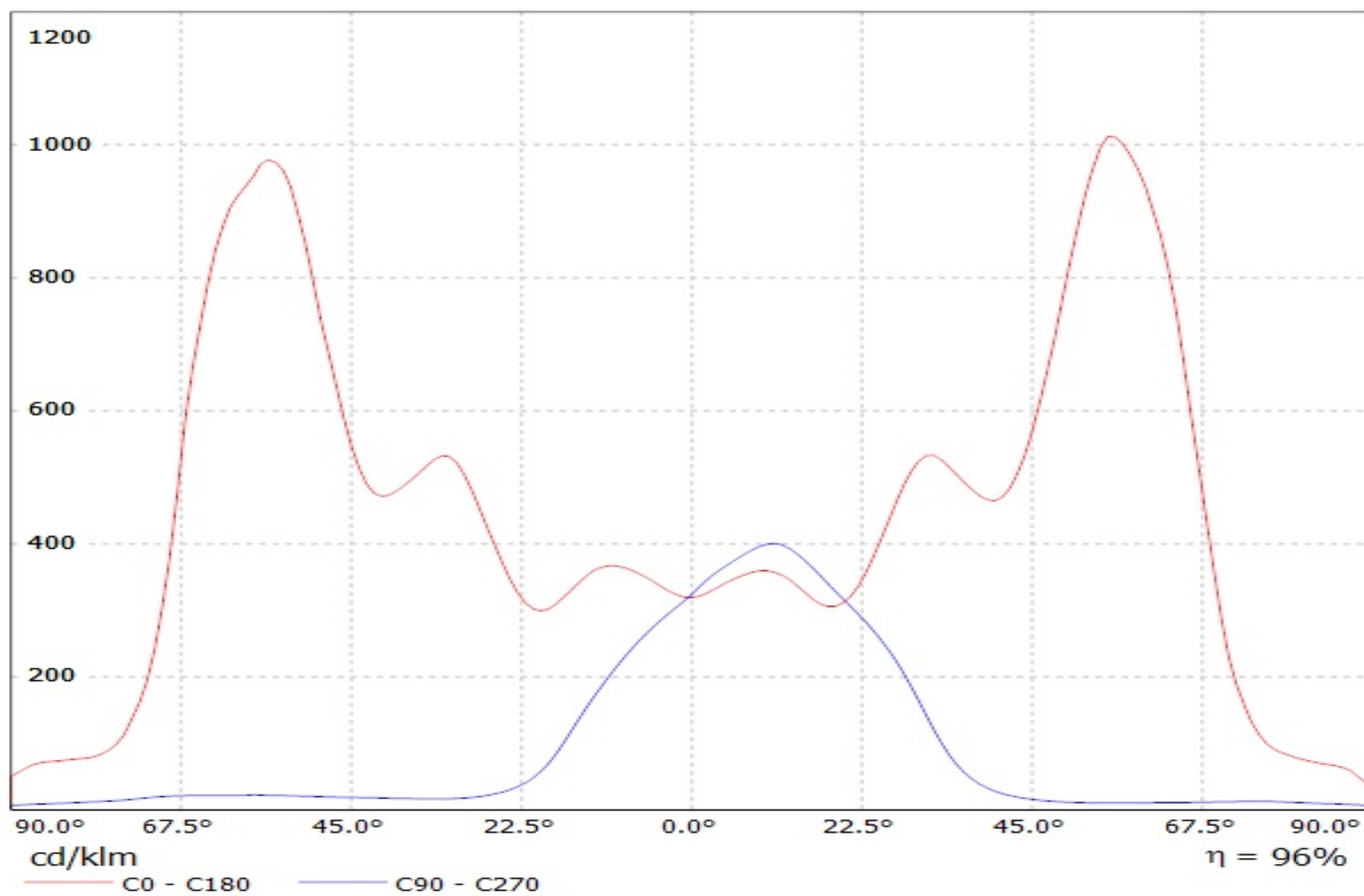

Luminaire: LEDIL OY CA12787_&_C12786_STRADA-K_(XP-G) Eff=95%

Lamps: 1 x Cree XP-G 86.6lm@ 250mA

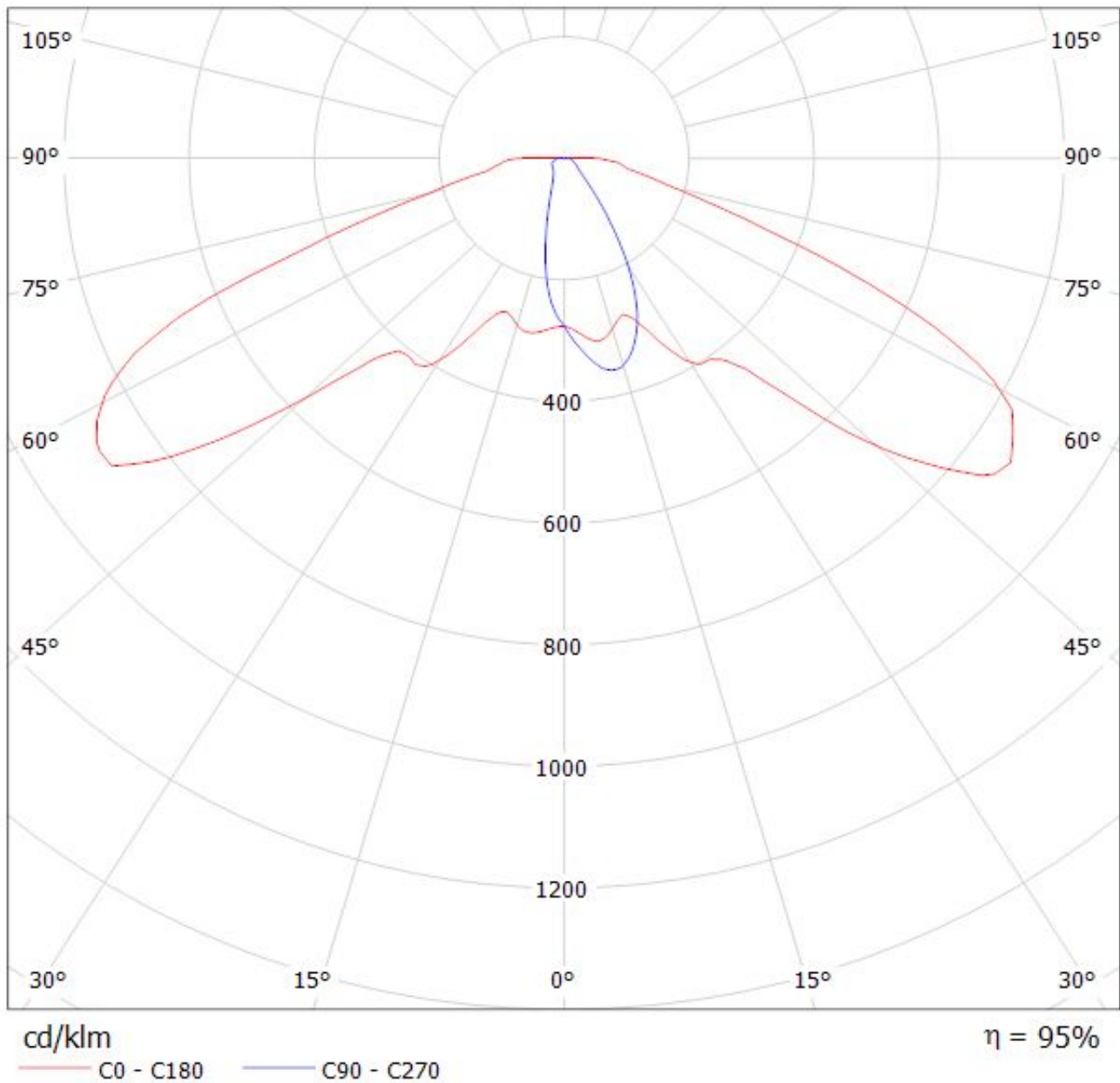

Luminaire: LEDiL Oy CA12787_STRADA-K_(XT-E_AWT) Eff. 96%
Lamps: 1 x Cree XT-E AWT (99,67lm@250mA)

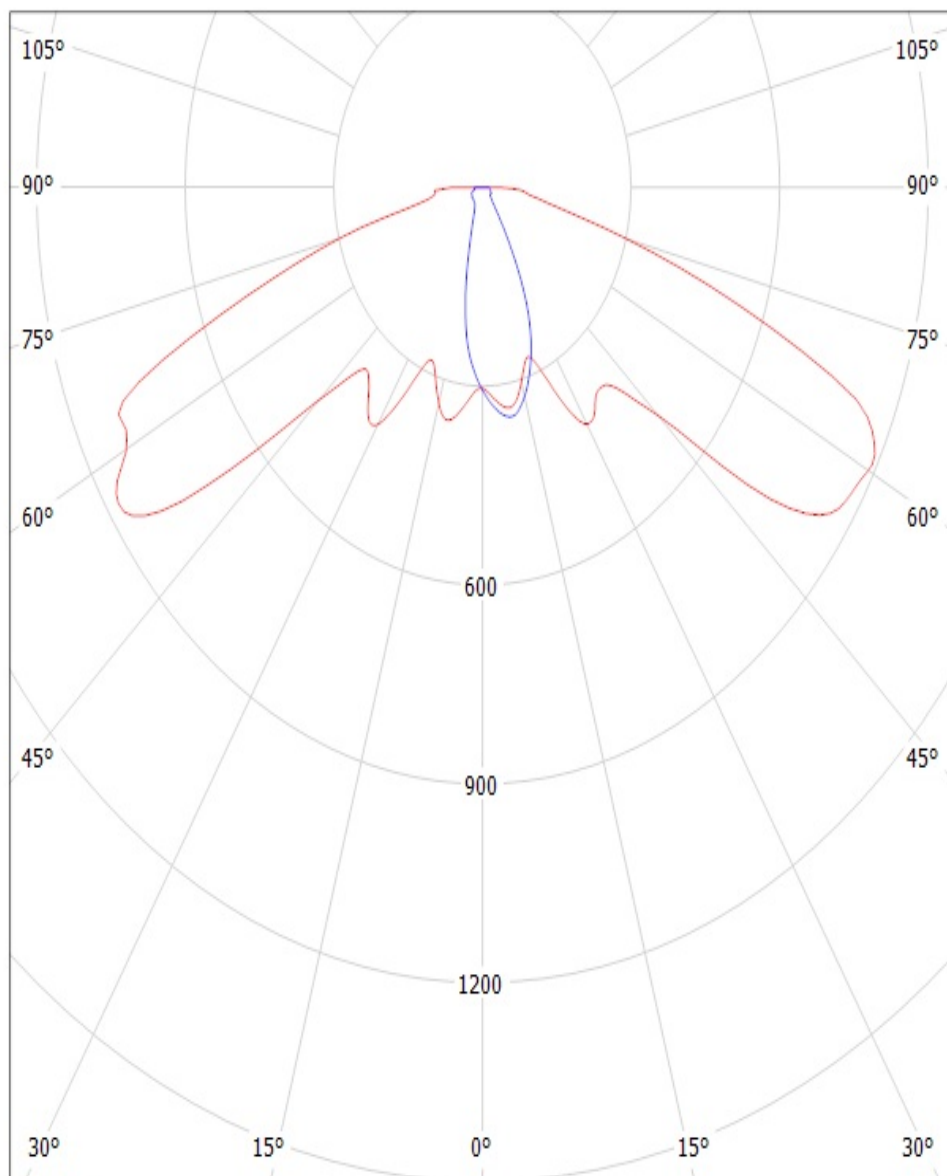

cd/klm

— C0 - C180 — C90 - C270

Luminaire: LEDiL Oy CA12787_STRADA-K (Cree XB-D) Eff. 95%
Lamps: 1 x Cree XB-D (92.6lm@250mA)

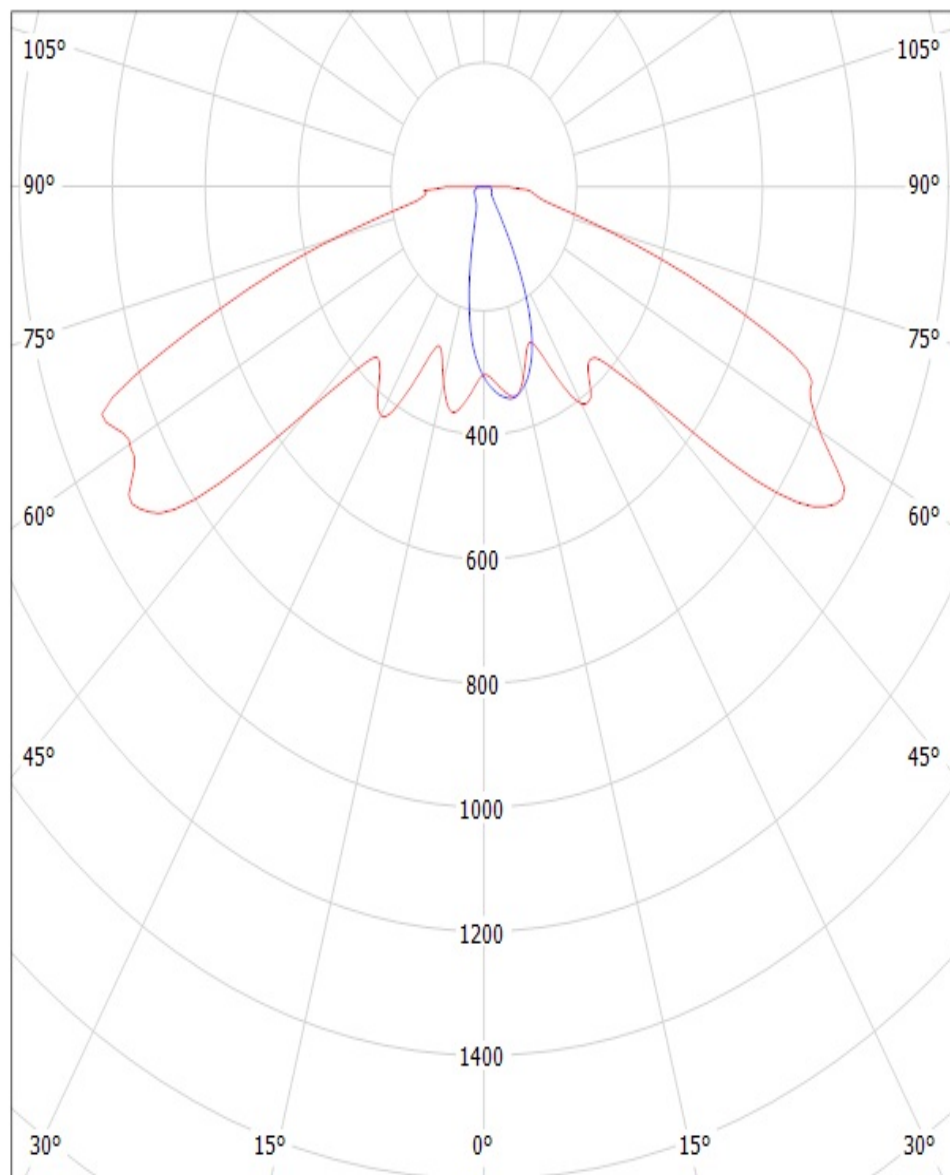

cd/klm

— C0 - C180 — C90 - C270

Luminaire: LEDil Oy CA12787_STRADA-K_(XP-G2) Efficiency=94%

Lamps: 1 x Cree XP-G2 (XPGBWT-L1-0000-00FE4) 101lm @ 250mA CCT=6600K P=0.7W I=250mA

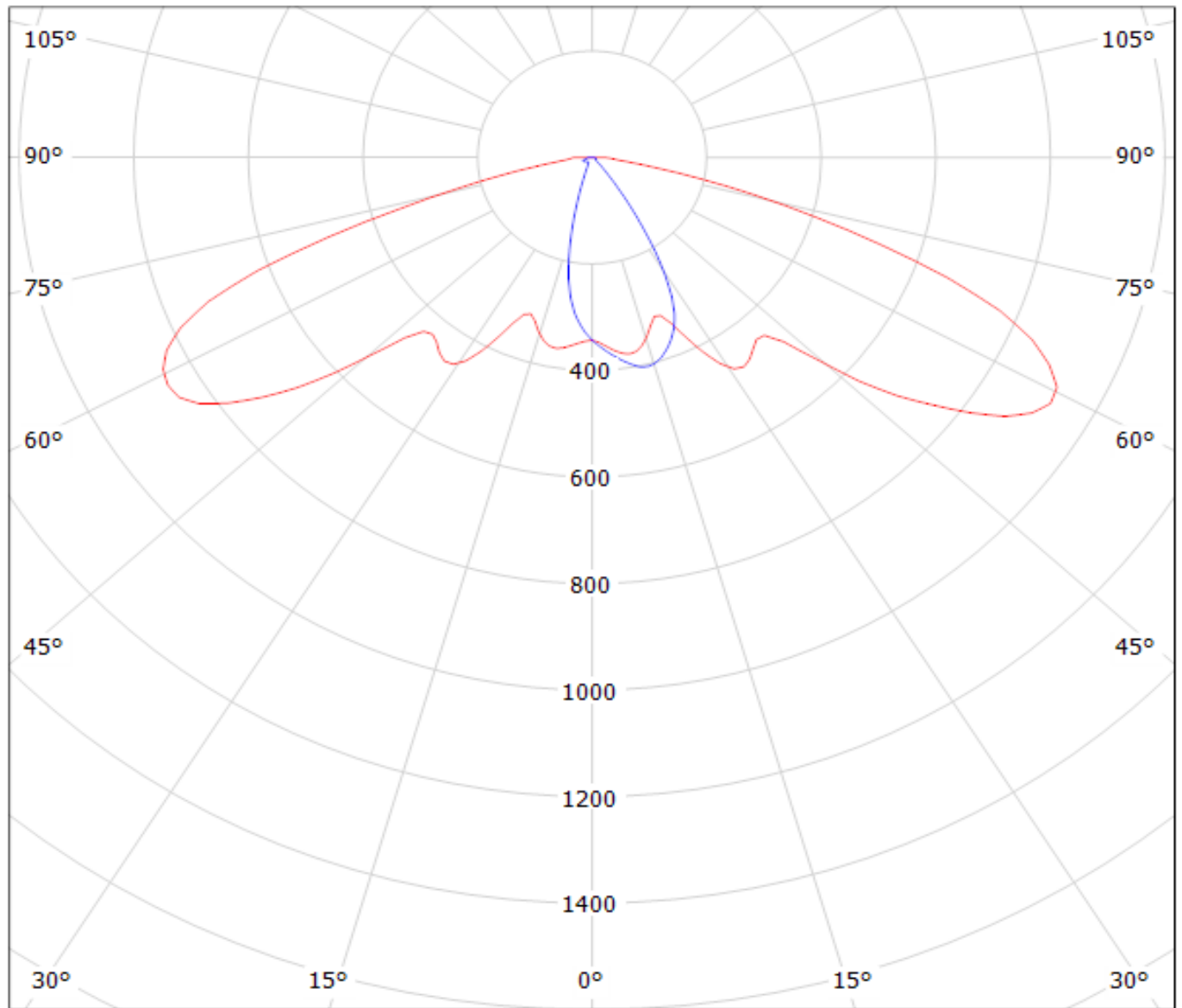

cd/klm

— C0 - C180

— C90 - C270

Luminaire: LEDil Oy CA12787_STRADA-K_(XP-E2) Efficiency=94%

Lamps: 1 x Cree XP-E2 (XPEBWT-L1-7B4-Q4-0-01) 84.8lm @ 250mA CCT=3200K P=0.8W I=250mA

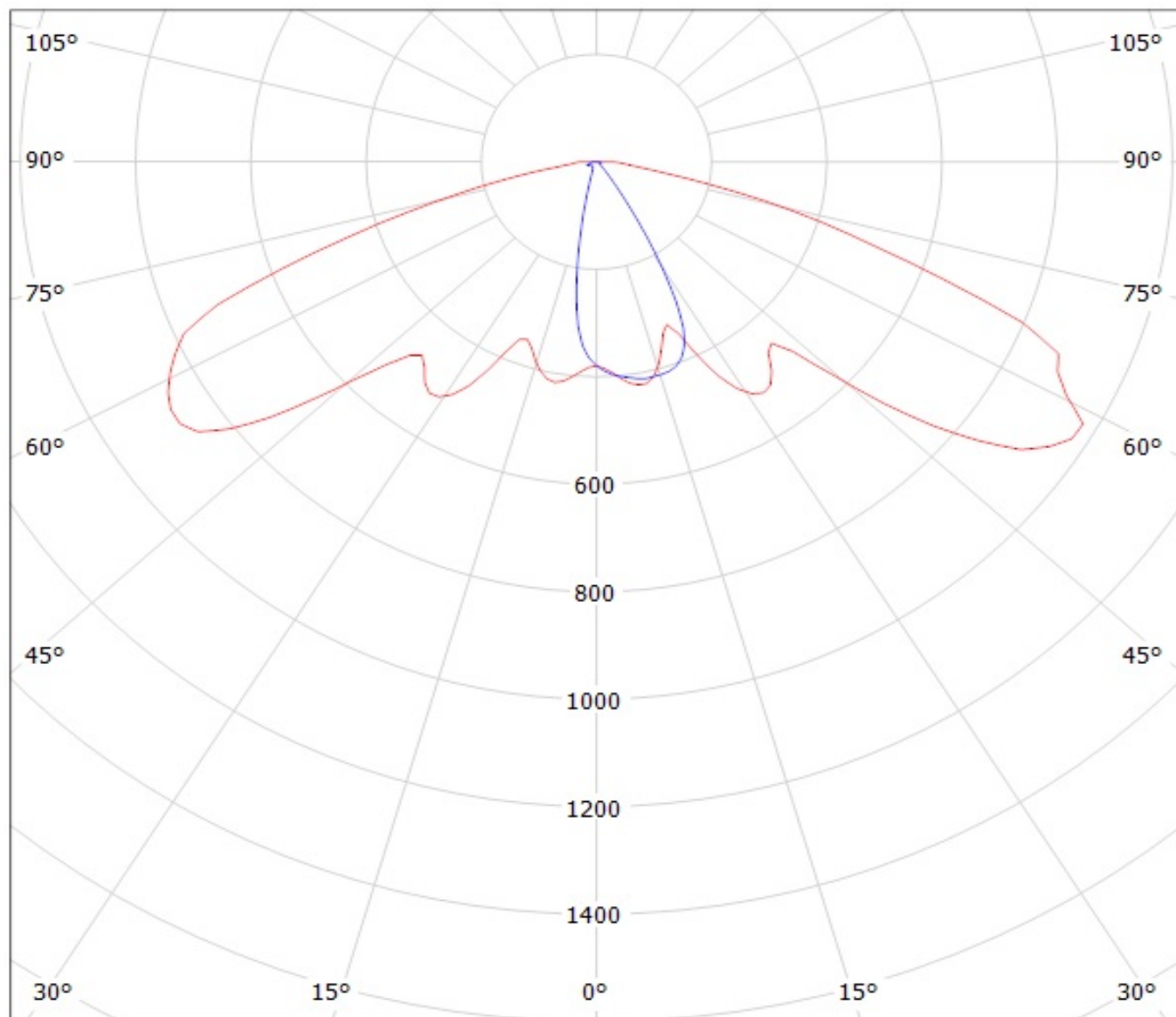

cd/klm

— C0 - C180

— C90 - C270

Luminaire: LEDiL Oy CA12787_STRADA-K_(LG3535) Eff. 96,1%
Lamps: 1 x LG Ceramic 3535 PKG (95lm@250mA)

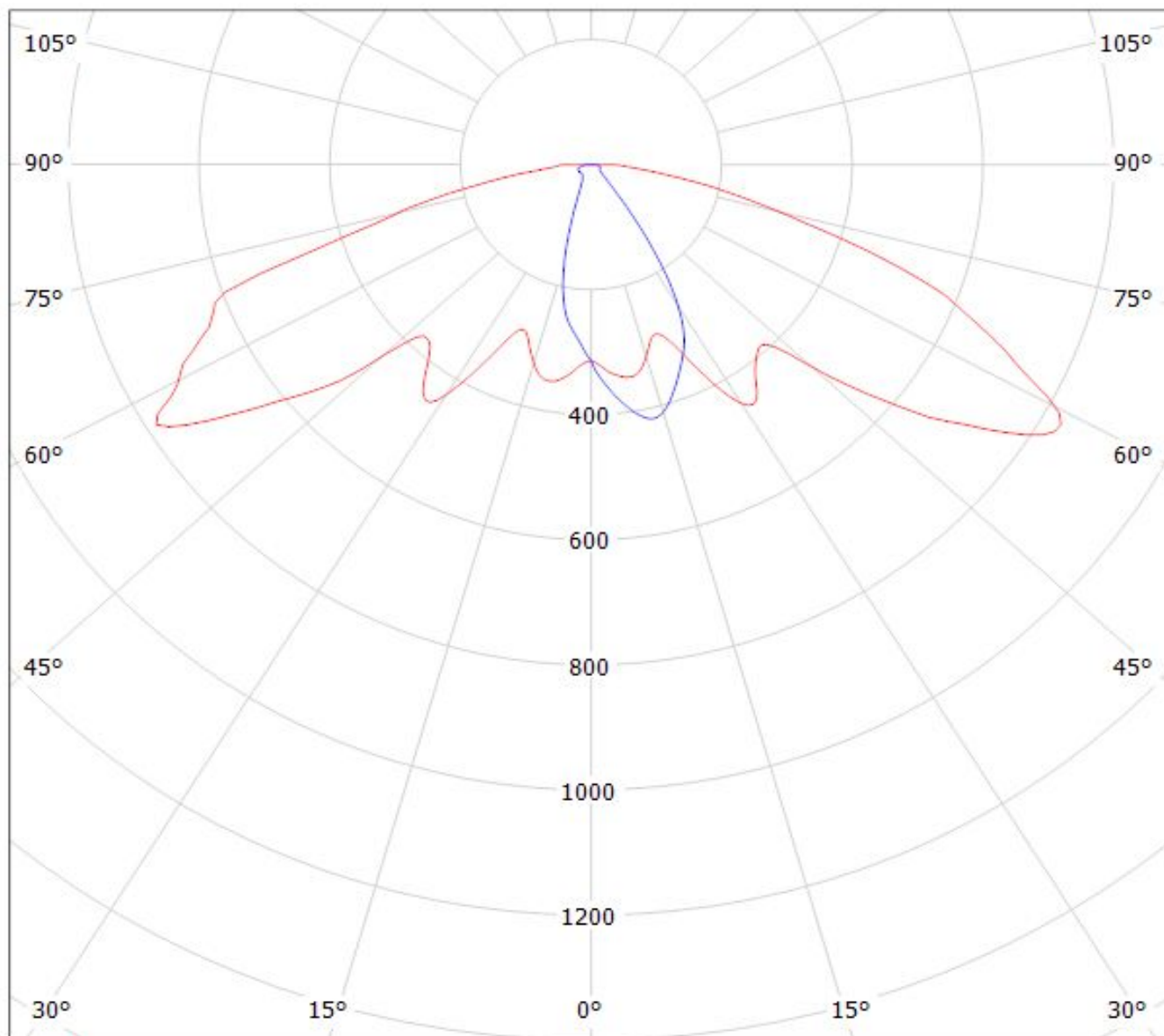

cd/klm

$\eta = 96\%$

— C0 - C180

— C90 - C270

LEDiL Oy CA12787_STRADA-K_(LUXEON_T) Eff.94.0% / LDC (Polar)

Luminaire: LEDiL Oy CA12787_STRADA-K_(LUXEON_T) Eff.94.0%

Lamps: 1 x LUXEON_T_(LXH8-FW30-3)_74.11lm@250mA_CCT=3158K_P=0.730833W_I=249.9mA

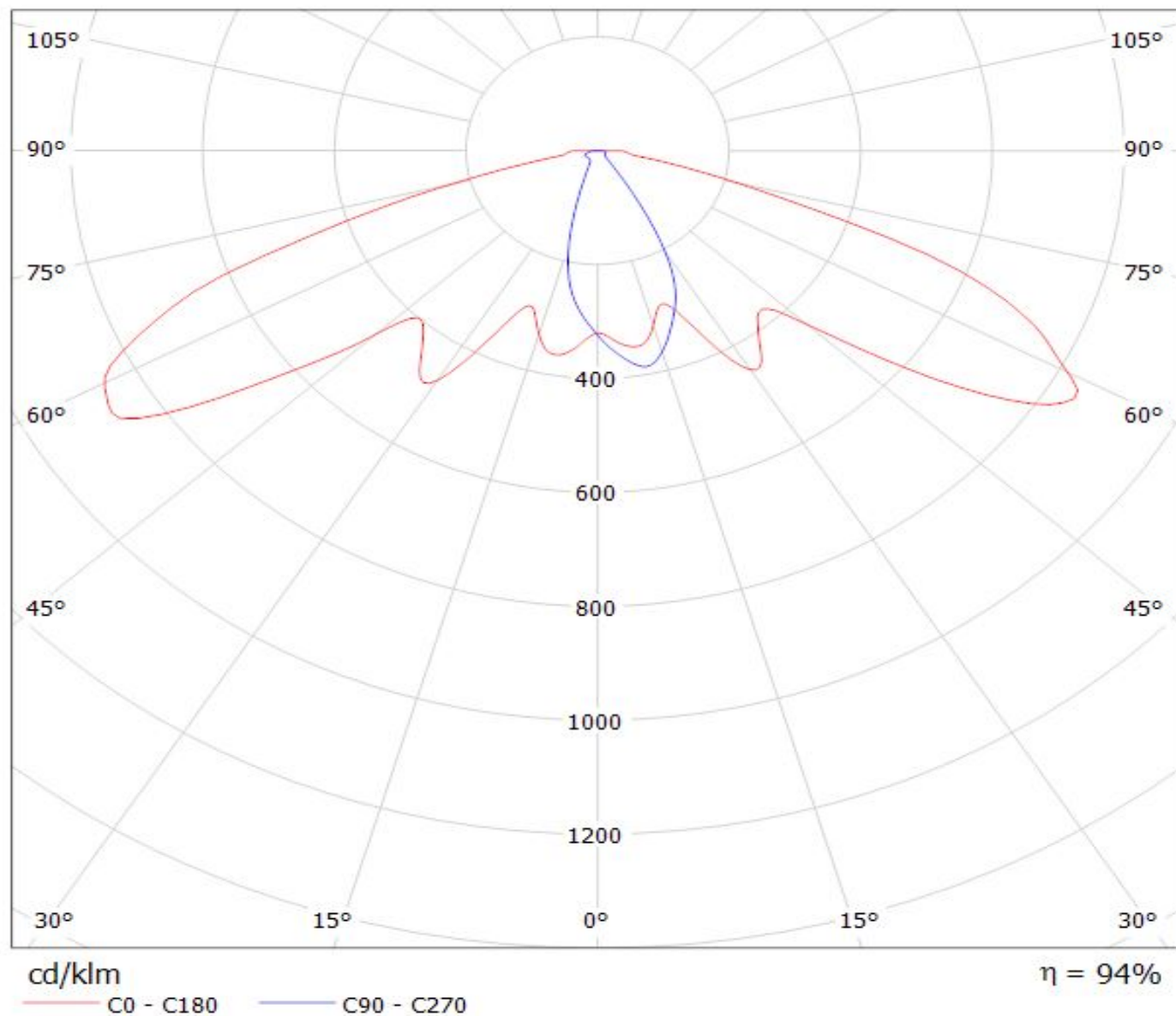

Luminaire: LEDiL Oy CA12787_STRADA-K_(Luxeon_TX)

Lamps: 1 x Luxeon_TX_(L1T2-3585)_80.1801lm@250mA_CCT=3500K_P=0.730583W_I=249.9mA

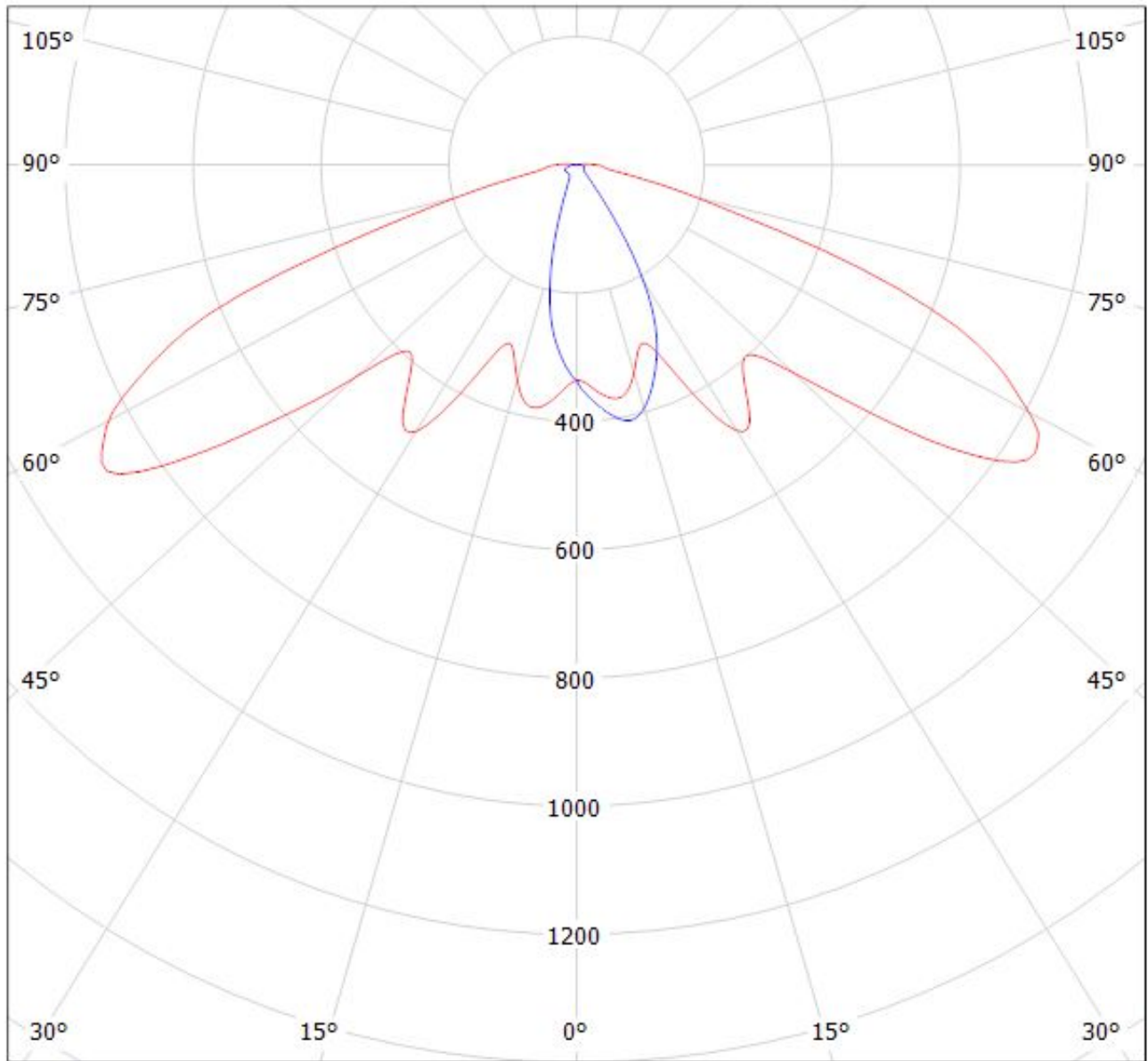

cd/klm

— C0 - C180

— C90 - C270

$\eta = 94\%$

Ledil CA12787_STRADA-K_(Fortimo_FastFlex_LED_board 2x8-757_DS_G3) / LDC (Polar)

Luminaire: Ledil CA12787_STRADA-K_(Fortimo_FastFlex_LED_board 2x8-757_DS_G3)
Lamps: 1 x Philips_Fortimo_FastFlex_LED_board 2x8/757_DS_G3_(XP-G2)
_3428.78lm@500mA_P=23.7W_I=0.5A

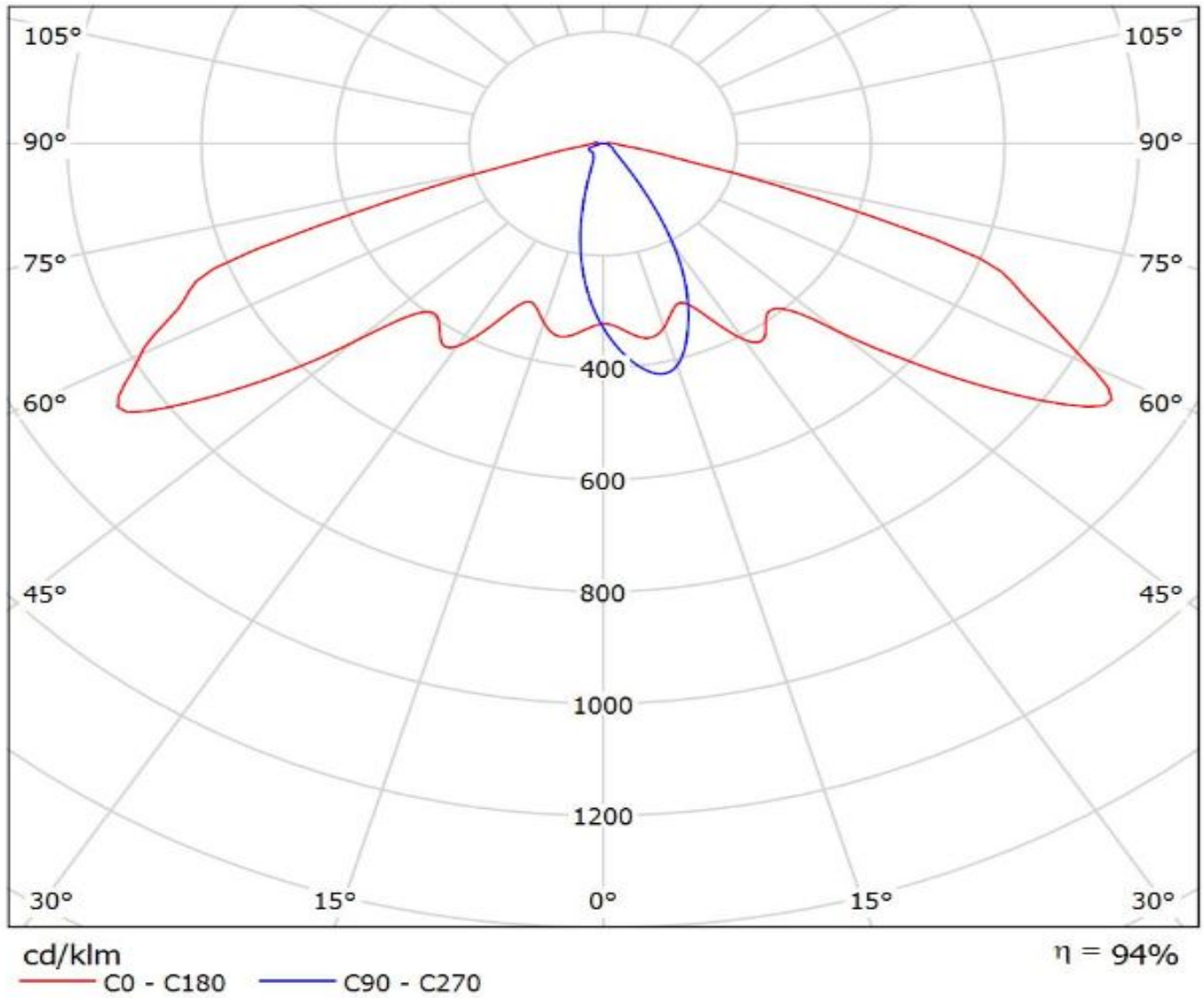

Luminaire: LEDiL Oy CA12787_STRADA-K_(LH351Z)

Lamps: 1 x SAMSUNG_LH351Z_92.91lm@250mA_P=0.747026W_I=249.9mA

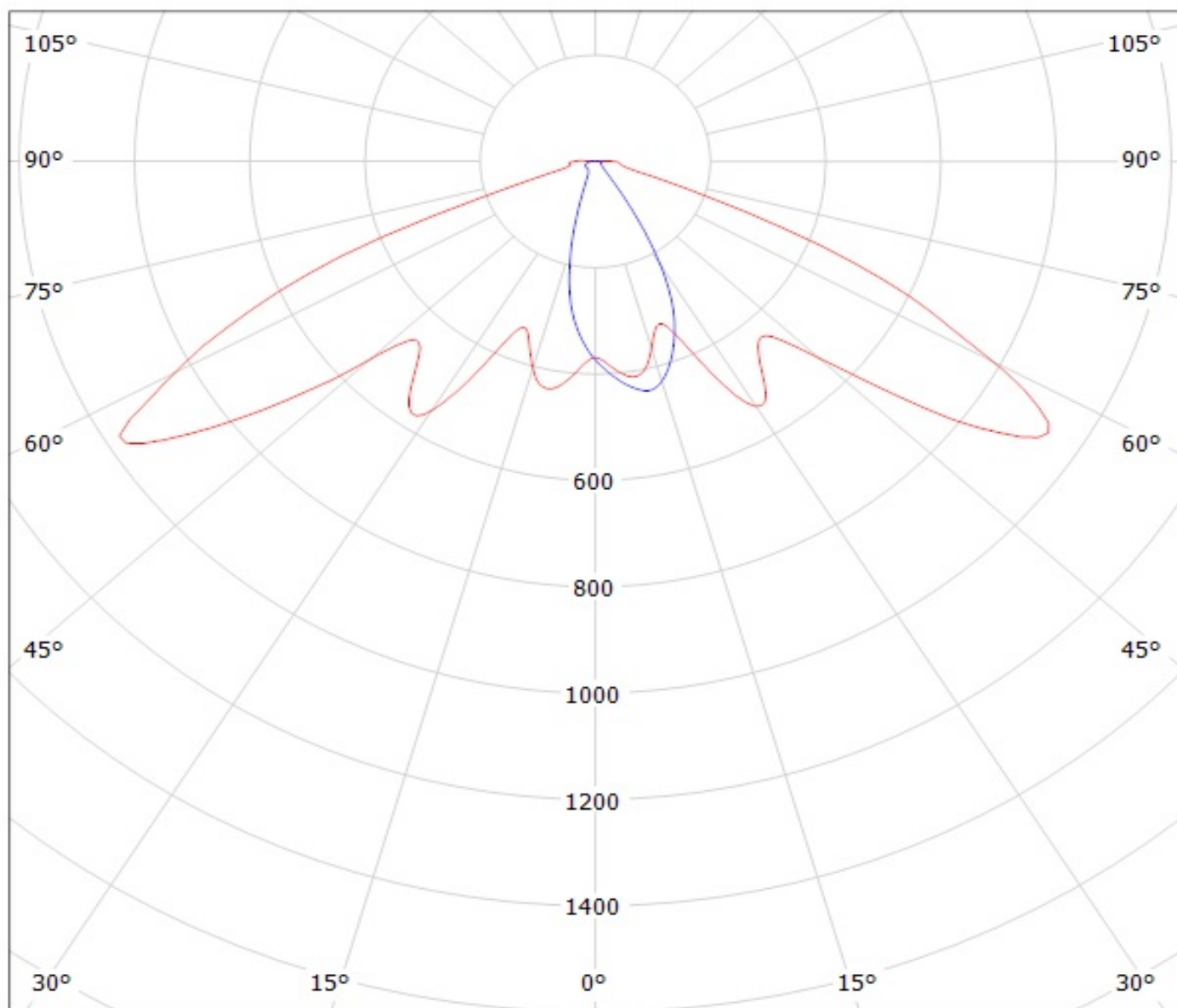

cd/klm

— C0 - C180

— C90 - C270

$\eta = 94\%$

Luminaire: LEDiL Oy CA12787_STRADA-K_(Toshiba_TL1L4)

Lamps: 1 x Toshiba_TL1L4_(TL1L4-DW0)_103.82lm@250mA_P=0.776_I=250mA

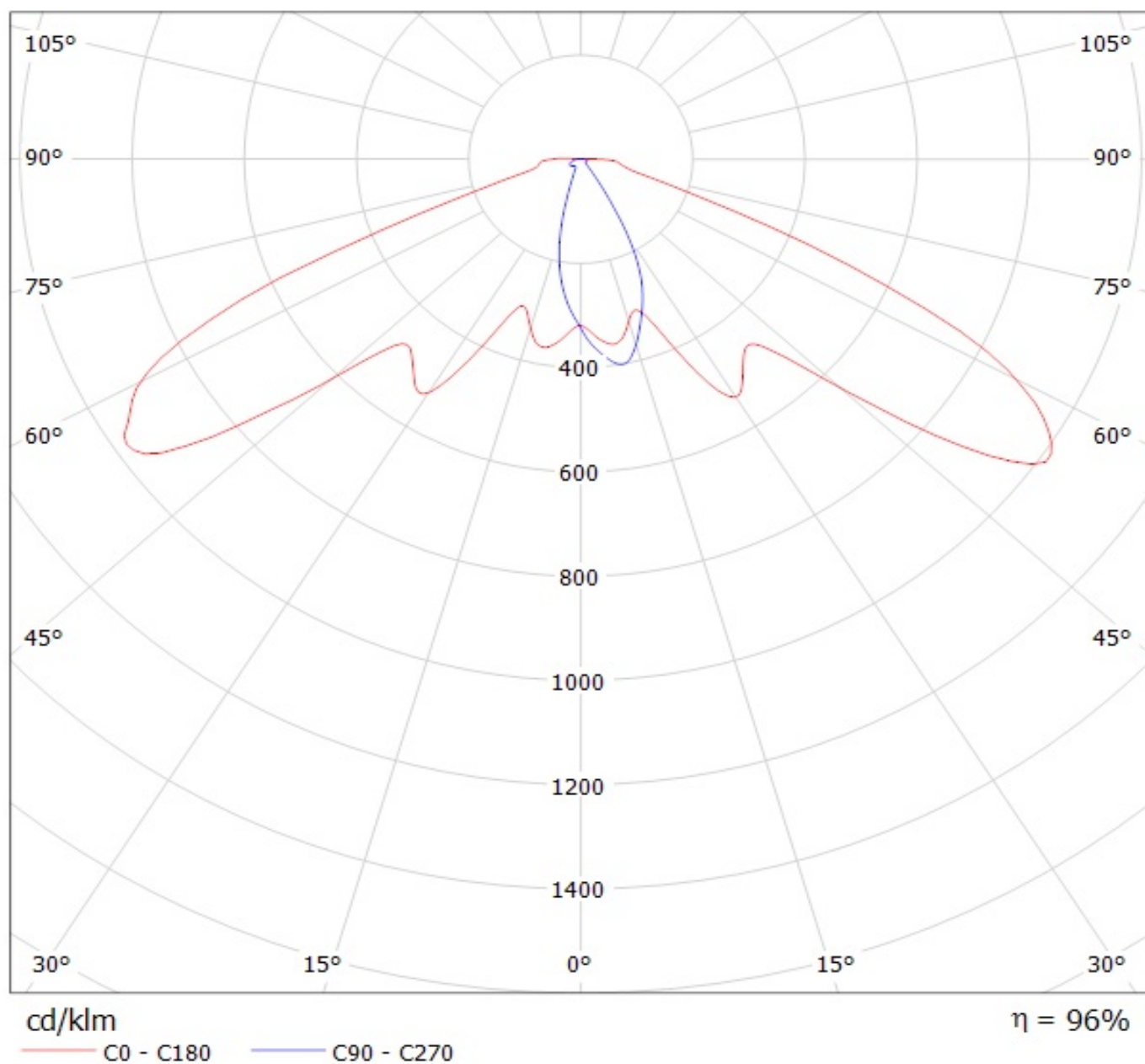

NOTE: The typical divergence will be changed by different color, chip size and chip position tolerance. The typical total divergence is the full angle measured where the luminous intensity is half of the peak value.