

| Rev. | Description | Date       |
|------|-------------|------------|
| A0   | New release | 2023.01.09 |
|      |             |            |
|      |             |            |

### 1. PHYSICAL CHARACTERISTICS( mm)

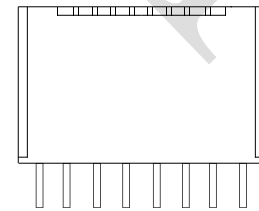
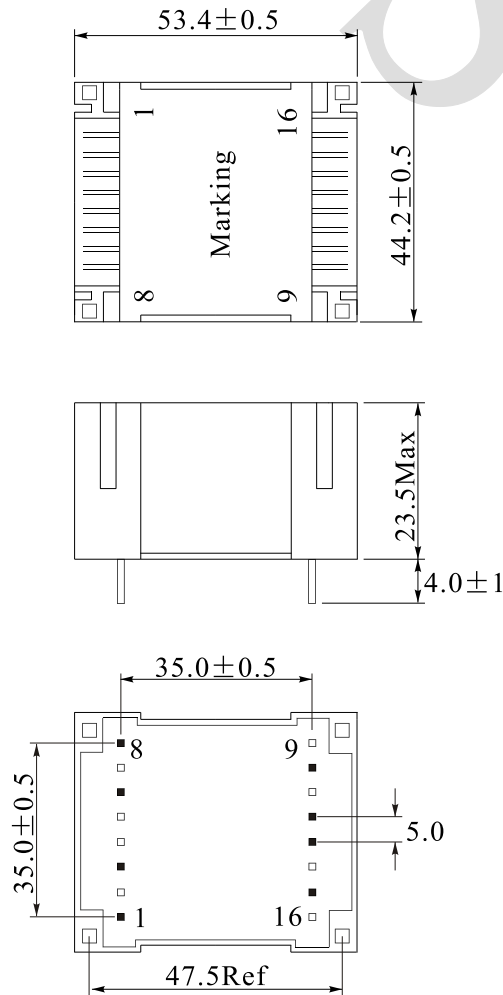

#### Marking

|                        |     |     |   |    |
|------------------------|-----|-----|---|----|
| 8                      | 6   | Pri | 3 | 1  |
| UI301029               |     |     |   |    |
| Vin: 115VAC-50Hz(1-3)  |     |     |   |    |
| 115VAC-50Hz(6-8)       |     |     |   |    |
| Vout: 18VAC/3VA(10-12) |     |     |   |    |
| 18VAC/3VA(13-15)       |     |     |   |    |
| ta 70/B                |     |     |   |    |
| 10                     | Sec |     |   | 15 |

#### NOTES:

Temp 20°C 48%RH  
RoHS Compliant

### 2. ELECTRONICAL SCHEMATIC

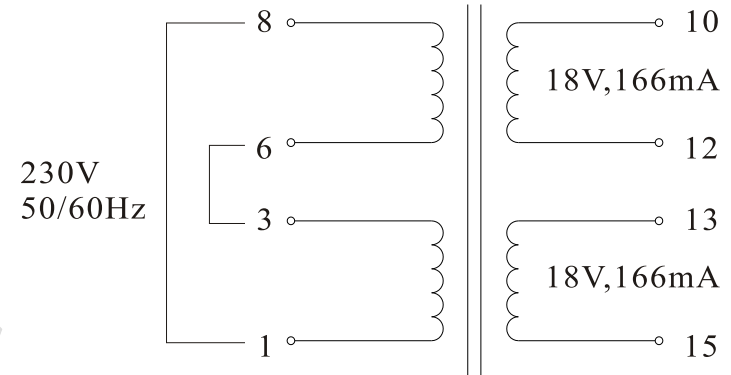

### 3. ELECTRONICAL SPECIFICATIONS

Pri voltage: 230V,50/60Hz  
 Sec no load voltage: 25.5V±5%(10-12)  
 25.5V±5%(13-15)  
 Sec load voltage: 18V±5%@ 166mA(10-12)  
 18V±5%@ 166mA(13-15)  
 Hi-Pot: 4000V/AC,1mA,2S Pri to Sec  
 Storage temperature: -20°C to +45°C  
 Operating temperature: -10°C to +70°C

|               |                     |            |            |
|---------------|---------------------|------------|------------|
| NAME:         | Potting transformer |            |            |
| CUSTOMER P/N: | BV UI 303 0143      | DATE:      | 2023-01-09 |
| SHINHOM P/N:  | UI301029            | REV: A0    | PAGE       |
| DRAWN BY      | CHECKED BY          | APPROVE BY |            |



# SHINHOM

SHAANXISHINHOM ENTERPRISE CO LTD

The Document property belong to SHINHOM & is not allowed to be duplicated without authorization