

REV	ECN	DESCRIPTION	DATE	MODIFIED
X1		临时发行	2022.07.27	ZT

8500±100mm(拉直测量 Straight length)

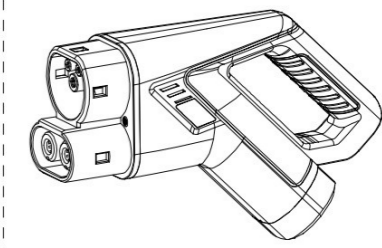

立体图
stereogram

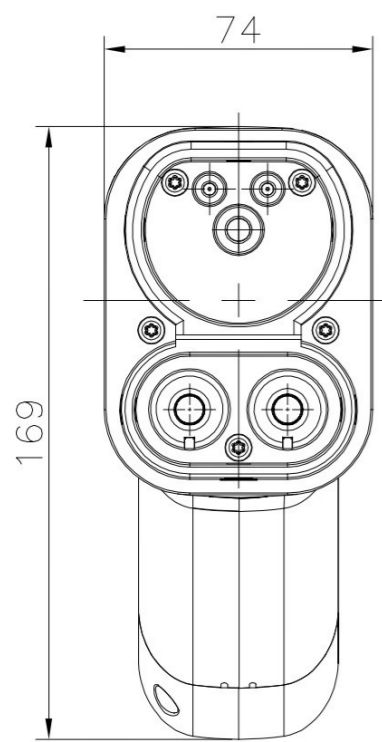

B向视图
B to view

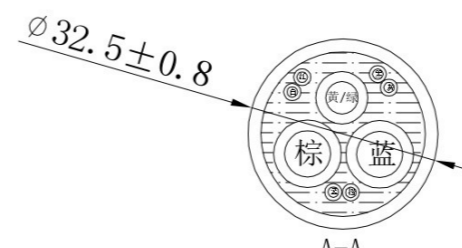
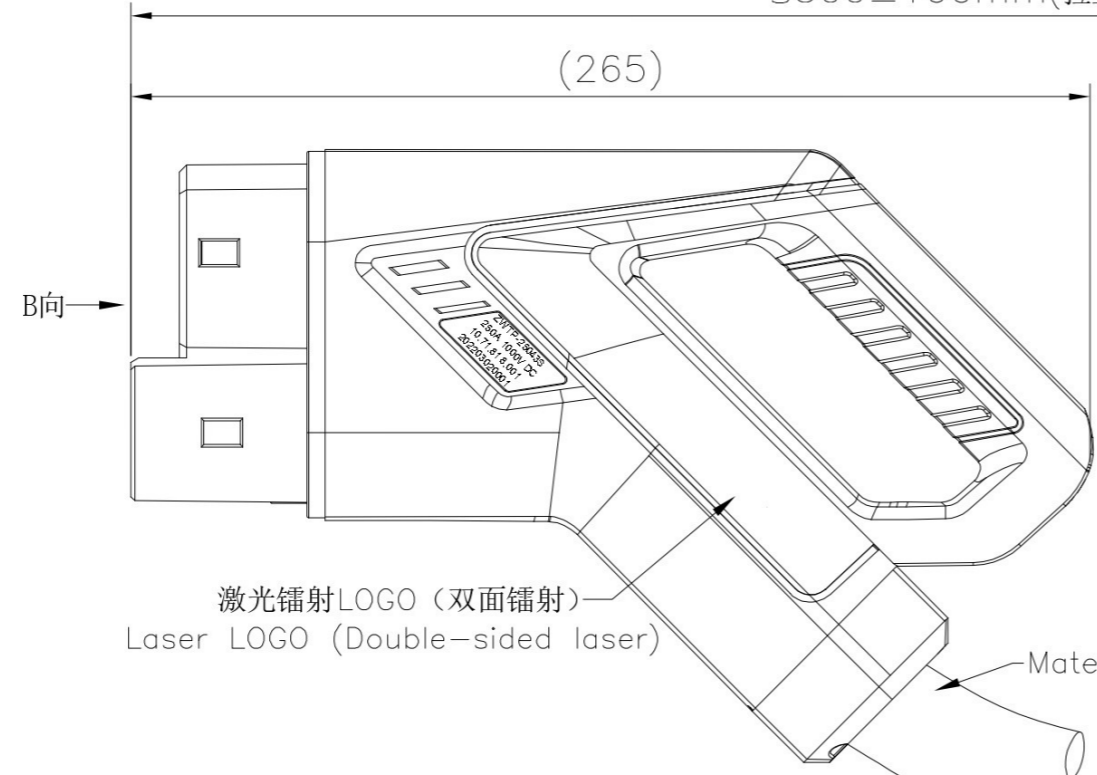

A-A
2×70mm²+35mm²+6×0.75mm²

双壁热缩管
Heat-shrink tube (Black)

材质: 黑色TPU
Material: Black TPU cable

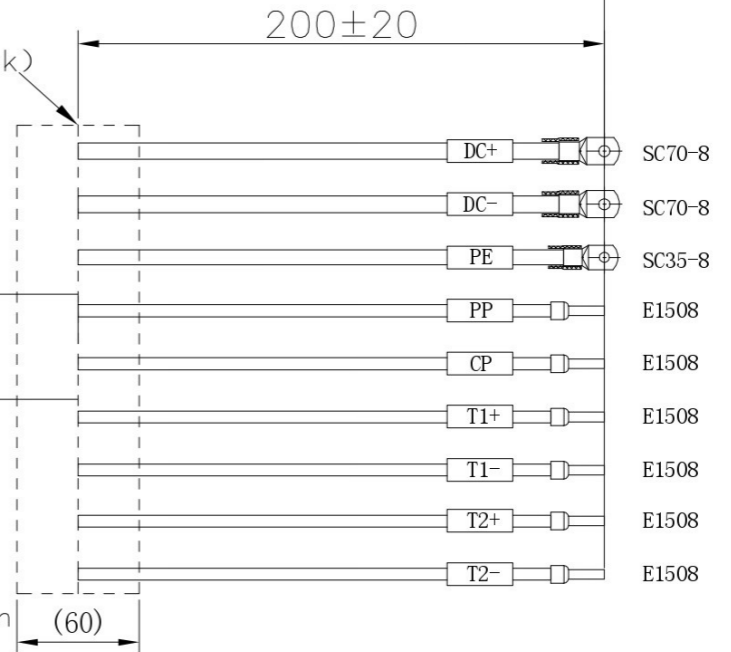

接线原理图
Wiring diagram

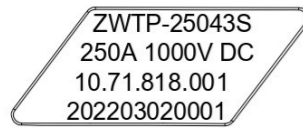
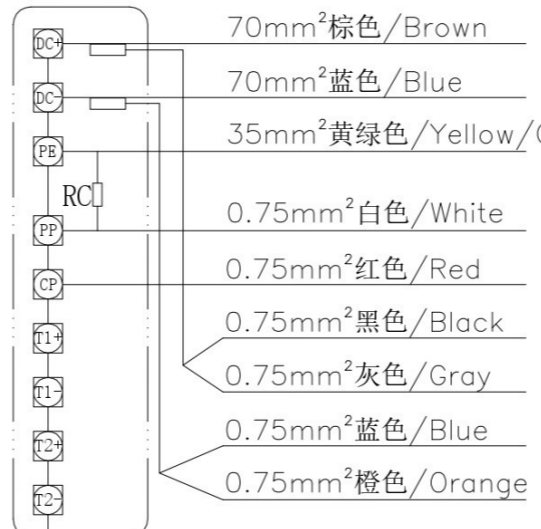

左侧型号打码详情
Code details of left model

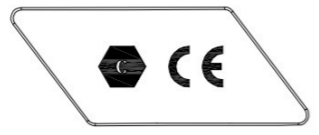

反面认证打码详情
Reverse authentication code details

Technical requirements:

- 技术要求:
- Rated current: 250A;
额定电流: 250A;
 - Rated voltage: 1000V DC;
额定电压: 1000V DC;
 - Withstand voltage DC+/DC-/PE 3500V AC, leakage current < 5mA;
耐电压DC+,DC-与PE之间3500V AC,漏电流<5mA;
 - Insulation resistance > 1000MΩ, measured with 1000V DC voltage;
绝缘电阻>1000MΩ,用1000V DC电压量测;
 - Plug and pull force ≤100N;
插拔力≤100N;
 - Plug life > 10000 times;
插拔寿命>10000次;
 - Protection grade: IP67(single gun);
防护等级: IP67(单枪);
 - The use of ambient temperature: -30°C ~ +50°C;
使用环境温度: -30°C~+50°C;
 - The product conforms to IEC62196.3-2015;
产品符合IEC62196.3-2015;
 - All parts and components used in this product meet the requirements of RoHS2.0;
本产品使用的所有零部件均符合RoHS2.0要求;
 - RC=1500±3%Ω 0.5W

温度传感器技术参数

NTC(10K)温度传感器 B _{25/50} -3950 (传感器固定于距离DC+, DC-压接处8mm的线缆上)	
-40°C	343.63KΩ
0°C	32.75KΩ
40°C	5.31KΩ
80°C	1.24KΩ

尺寸公差/Tolerance .XX ±0.2 .X ±0.3 X ±0.5 ANGLES ±1°	视图视角/ First Angle Projection 	TITLE 250A 欧标充电枪 250A IEC Charging connector	
		DWG NO	
THIS DRAWING IS SUPPLIED FOR INFORMATION ONLY. DESIGN FEATURES, SPECIFICATIONS AND PERFORMANCE DATA SHOWN HEREON ARE THE PROPERTY OF THE ZDWL. NO RIGHTS OF REPRODUCTION ARE IMPLIED.	设计/Design	MASS (g)	AREA (mm²)
		审查/CHKD	SIZE PART NO REV
		批准/APPD	A4 EVO-IC-IEC3-IVc-C250P X1
		UNITS: mm	SCALE: 1:2.8 SHEEF 1 OF 1