

RoHS Compliant

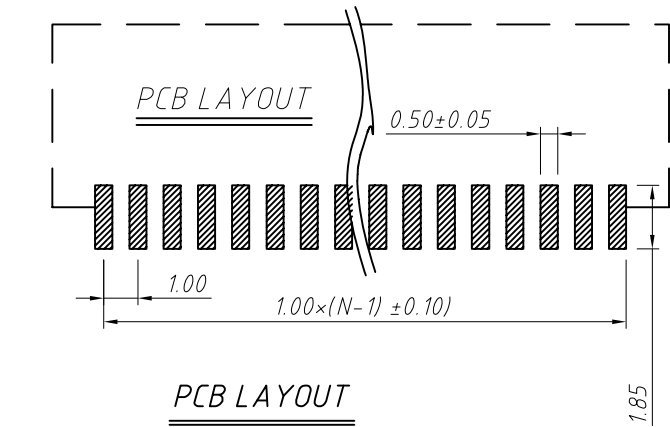
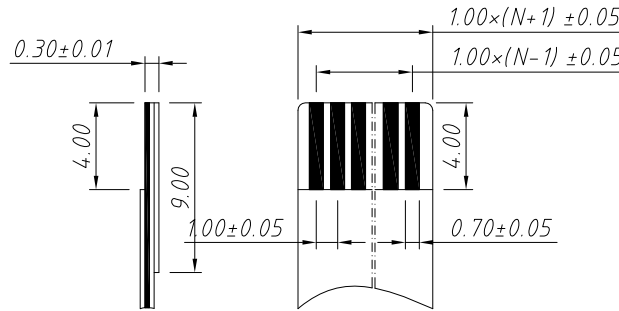
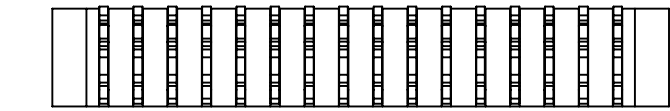
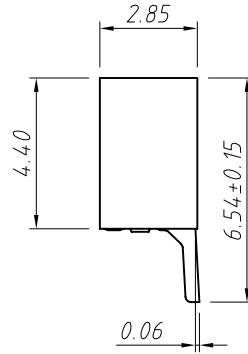
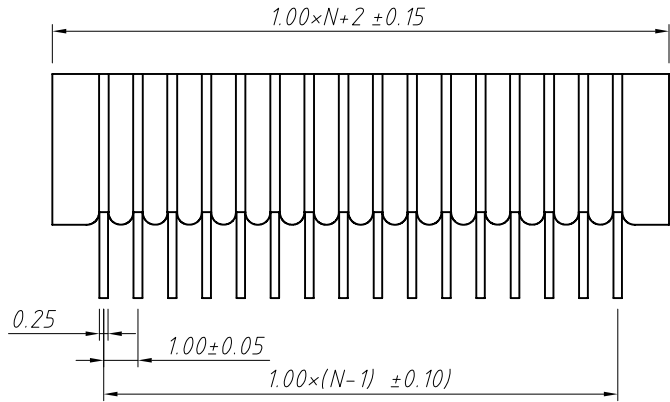
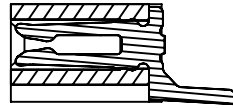
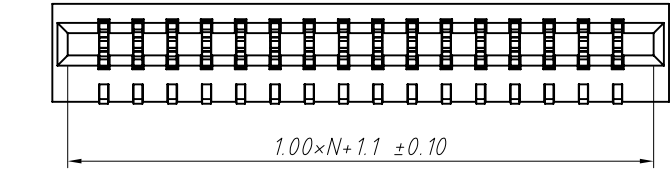

Proper Cable

Material
 Housing: LCP, UL 94V-0
 Contact: Phosphor Bronze, Tin plated

Electrical
 Voltage rating: 50 V
 Current rating: 0.5 A
 Withstand Voltage: 500 V
 Insulation resistance: 500M Ω .Min.
 Contact resistance: 30 m Ω .max.

Mechanical
 Temp. Range: -25 °C ~ + 85 °C

Order Information

L-KLS1- 240C - XX -RT-R

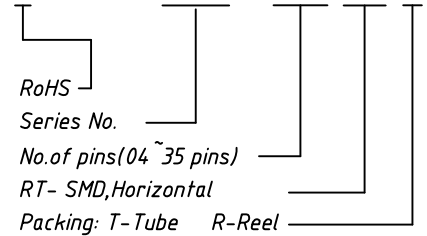

GENERAL TOLERANCE	ANGLE TOLERANCE	PROJECTION	Description:
X. ± 0.15	X. $\pm 5^\circ$	UNITS	CONN FFC 1.00mm, SMD, Horizontal
.X ± 0.03	.X $\pm 3^\circ$	SHEET SIZE	
.XX ± 0.05	.XX $\pm 2^\circ$	KLS P/N:	

Draw by: Date 2018-03-10

Check by: Date 2018-03-10

SCALE SHEET OF



NingBo KLS ELECTRONIC CO., L TD.